

4-L BROILER FARMS LLC-EAST

TYSON BROILER FARM

HERD LAW ROAD

TRENTON, GIBSON COUNTY, TENNESSEE

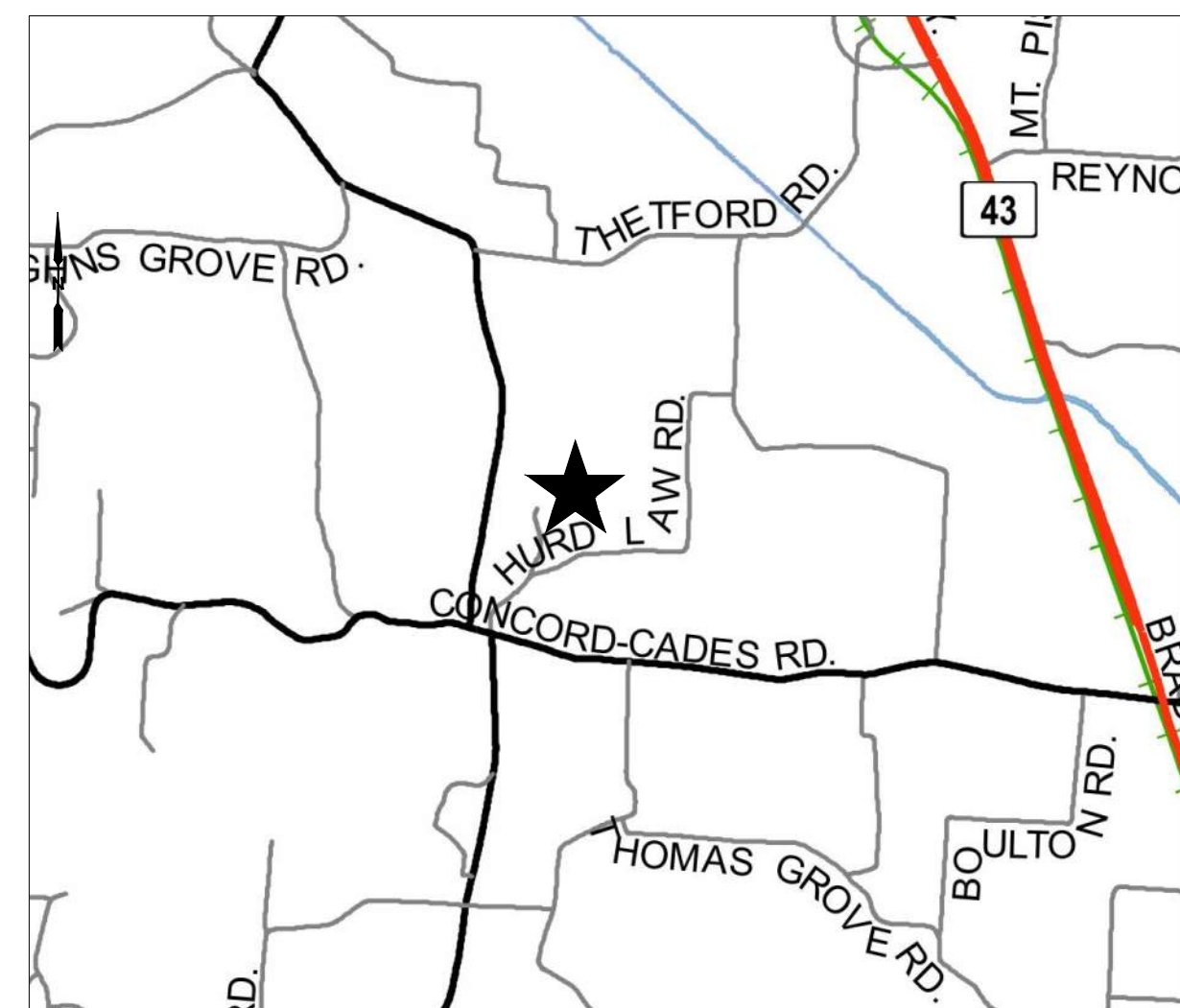

VICINITY MAP - NOT TO SCALE



SITE DATA

- A. OWNER/DEVELOPER: 4-L BROILER FARMS LLC
CONTRACTOR: 4-L BROILER FARMS LLC
- B. MAP 097, PARCEL 032.00 AND 032.01 - GIBSON COUNTY

PROPERTY AREA: 228 +/- ACRES
SITE AREA: 27 +/- ACRES
- D. EXISTING USE: ROW CROP

PROPOSED USE: TYSON BROILER HOUSE FARM
8 HOUSES
- E. THIS SITE LIES IN THE AREA OF ZONE X,
AS SHOWN ON FEMA NFIP FIRM MAP NUMBER 47053C0305D
EFFECTIVE DATE: NOVEMBER 05, 2008

SHEET NO.	SHEET NAME	SCALE
C-000	COVER SHEET	
C-100	EXISTING CONDITION	1"=100'
C-400	A.R.A.P.	1"=20'
C-401	E.P.S.C. PHASE 1	1"=100'
C-402	E.P.S.C. PHASE 2	1"=100'
C-403	E.P.S.C. PHASE 3	1"=100'
C-900	DETAILS	
C-901	DETAILS	



302 North Caldwell Street, Paris, TN 38242 | 731-644-1014 | www.lismith.com
475 Metroplex Drive, Suite 212 Nashville, TN 37211 | 615-256-0290



SHEET:	COVER	NUMBER:	C-000
REVISIONS			
NO.			

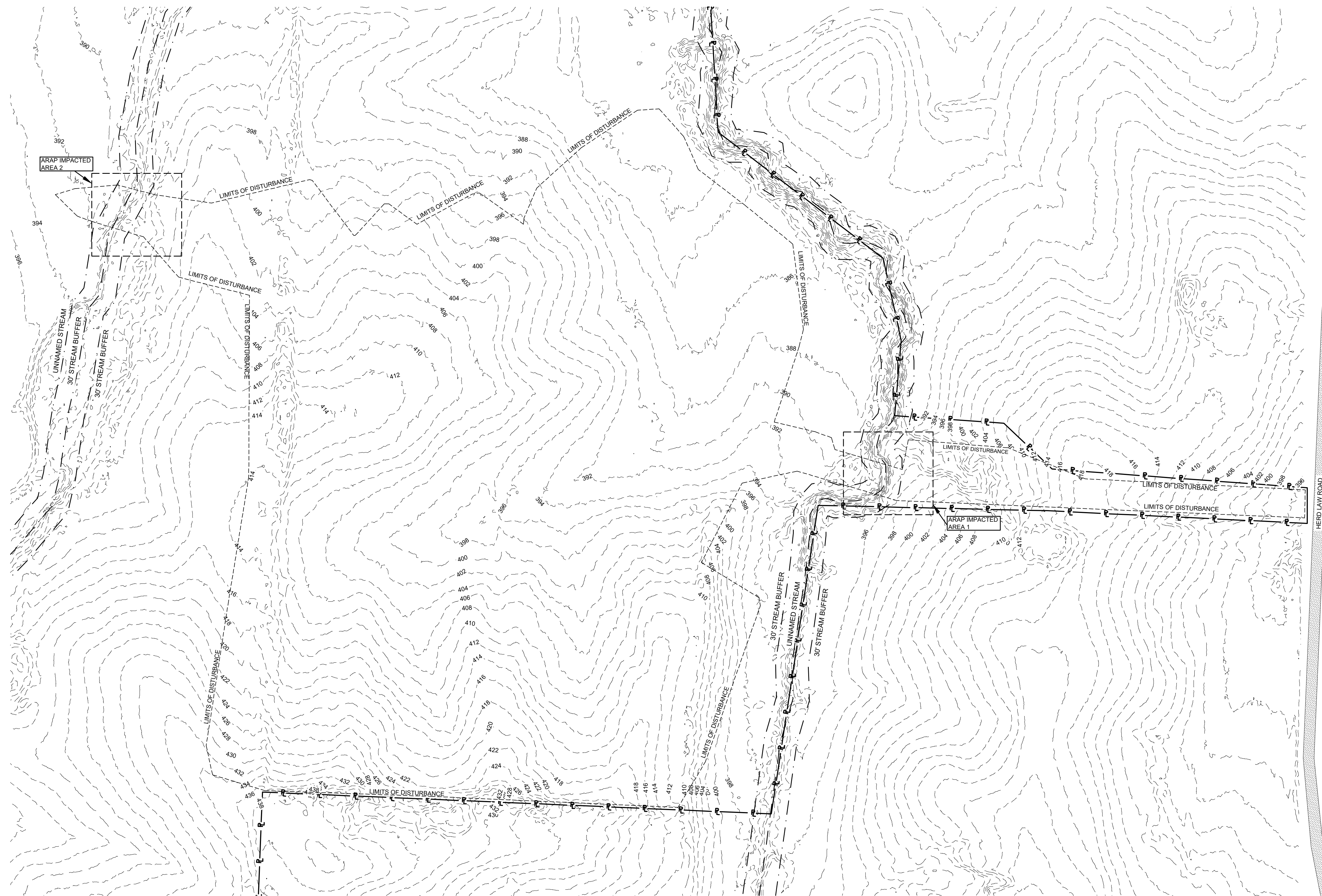

BEARING BASIS:
 TENNESSEE STATE PLANE
 COORDINATE SYSTEM -
 NAD 1983
 VERTICAL DATUM -
 NAVD 1988

LEGEND	
	PROPERTY LINE
	TREE LINE
	LIMIT OF DISTURBANCE
	30' RIPARIAN BUFFER
	DRAINAGE AREA PERIMETER
	STANDARD SILT FENCE
	SLOPE ARROW
	STRAW WADDLE
	ENHANCED ROCK CHECK DAM
	ROCK CHECK DAM
	ROCK CHECK DAM AT PIPE INLET
	UNDISTURBED AREA
	EXISTING PAVEMENT
	PROPOSED STRUCTURE
	GRAVEL PAVEMENT
	STABILIZED AREA

EXISTING CONDITION NOTES

1. THE EXISTING SITE IS CURRENTLY FALLOW WITH A HISTORY OF ROW CROP PRODUCTION.
2. THE AREAS TO THE NORTH, SOUTH, AND EAST OF THE SITE ARE TO BE UNDISTURBED.
3. AN A.R.A.P. WAS APPLIED FOR AT STREAM CROSSINGS 1 AND 2.
4. THE ACCESS ROAD WILL CONTINUE TO THE WEST TO ACCESS ANOTHER SET OF BROILER BARN UNDER A SEPARATE NPDES PERMIT.

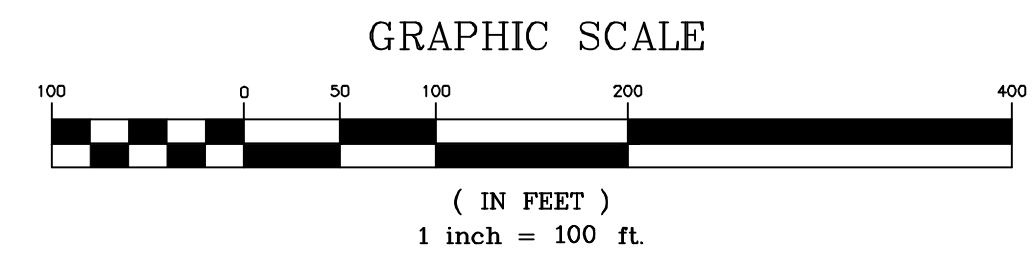

4-L BROILER FARMS LLC-EAST
TYSON BROILER FARM
HERD LAW ROAD
 TRENTON, GIBSON COUNTY, TENNESSEE

REVISIONS	
NO.	DESCRIPTION

© 2020 L.I. SMITH & ASSOCIATES, INC.
 ALL RIGHTS RESERVED. THESE PLANS ARE THE
 INTELLECTUAL PROPERTY OF L.I. SMITH & ASSOCIATES, INC. THESE PLANS, DECISIONS, DATA
 AND/OR INFORMATION HAVE BEEN PREPARED SOLELY FOR THOSE PARTIES NAMED
 LISTED HEREON. USE OF THESE PLANS BY ANY OTHER PARTIES, OR USE OF THESE PLANS
 UNAUTHORIZED AND IN VIOLATION OF COPYRIGHT LAWS.

THIS DRAWING SHALL BE CONSIDERED
 PRELIMINARY IN NATURE AND IN NO WAY
 SHALL BE USED FOR CONSTRUCTION OF RECORDS
 WITHOUT THE SIGNATURE AND SEAL OF THE
 ENGINEER OR SURVEYOR OF RECORD IS
 AFFIXED HERETO.

EXISTING CONDITIONS C-100

L.I. Smith and Associates, Inc.
 LAND DEVELOPMENT | INFRASTRUCTURE DESIGN
 SURVEYING SERVICES

302 North Caldwell Street, Paris, TN 38242 | 731-644-1014 | www.lismith.com
 475 Metroplex Drive, Suite 212 Nashville, TN 37211 | 615-556-0250

DRAWN BY: TGT CHECKED BY: WFS SCALE: 1"=100'
 PROJECT # 190258.44 DATE: 08/28/2020

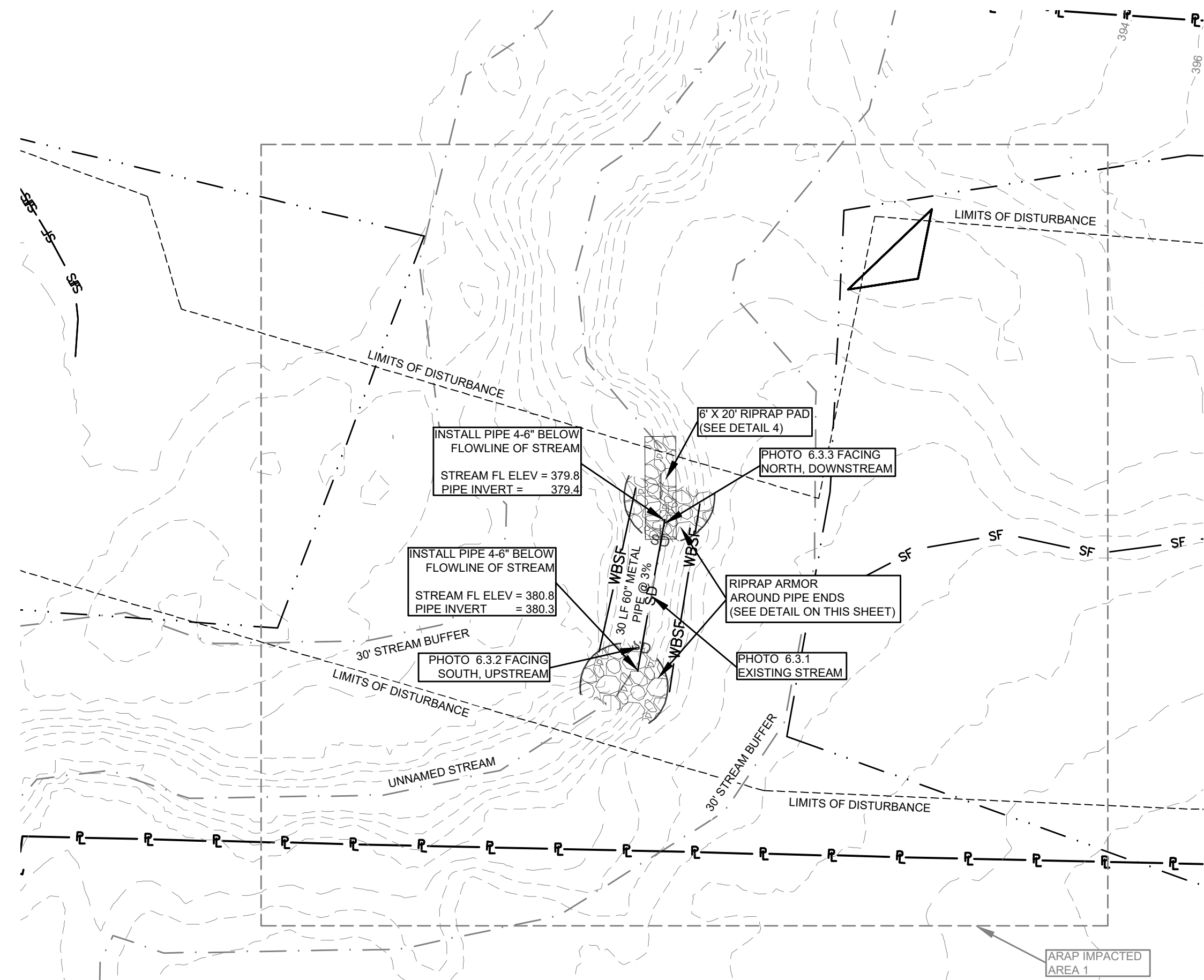

ARAP IMPACTED AREA 1

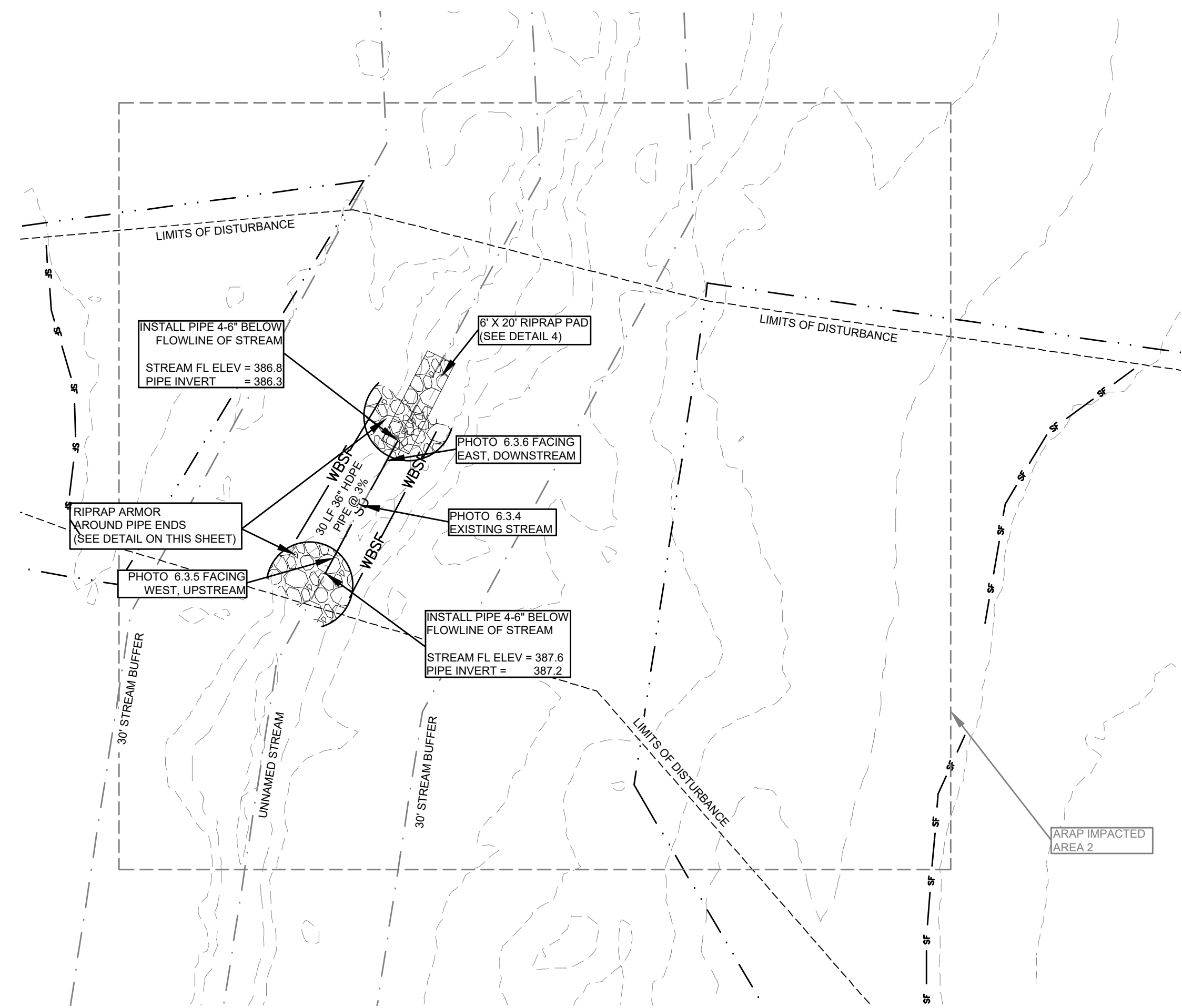

ARAP IMPACTED AREA 2

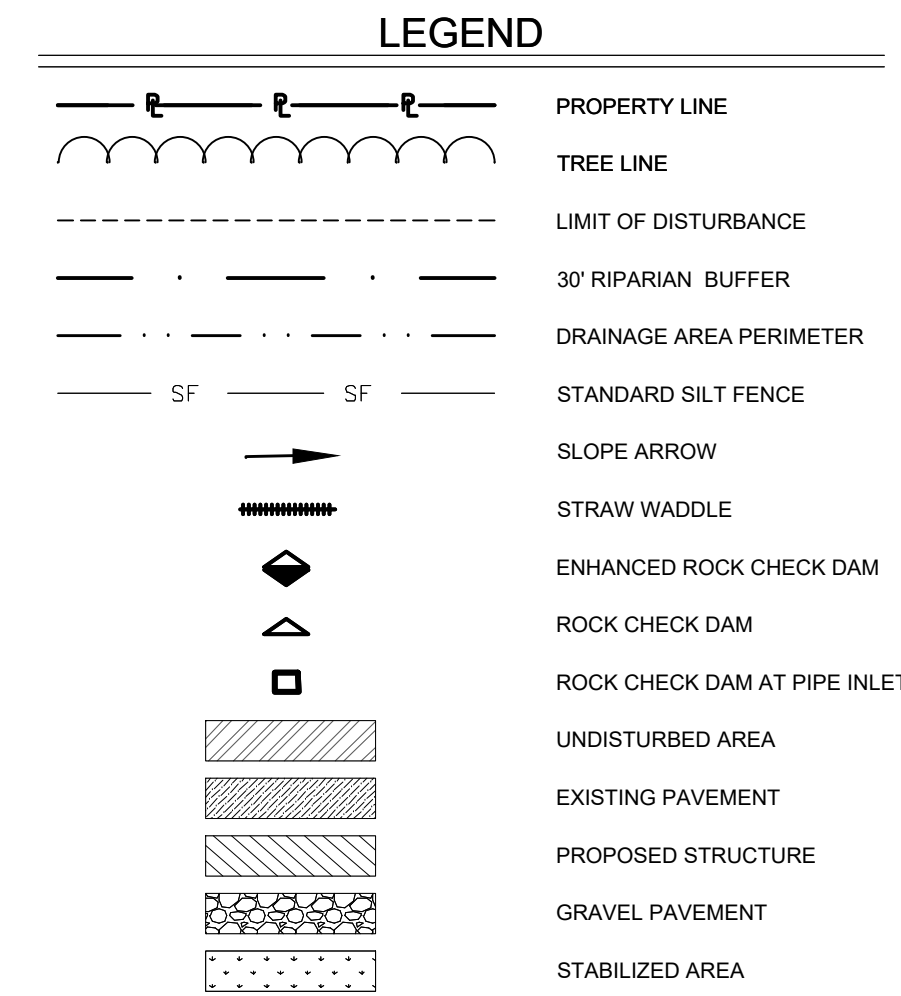
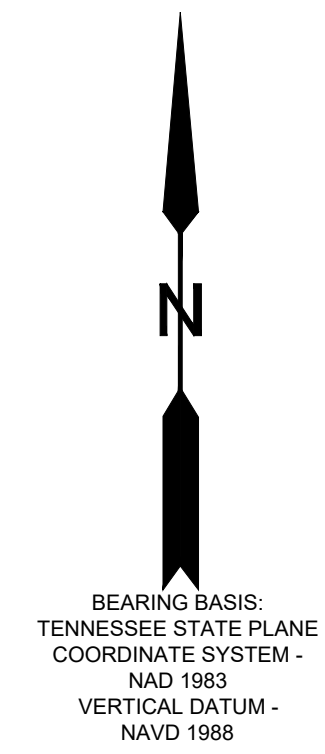

ARAP NOTES:

- ALL WORK SHOULD BE PERFORMED UNDER DRY WEATHER CONDITIONS.
 - IF WATER IS PRESENT IN STREAMS AT TIME OF CONSTRUCTION CONTRACTOR SHALL ERECT COFFER DAMS USING SAND BAGS OR SOME OTHER NON-ERODIBLE BARRICADES TO TEMPORARILY IMPOUND THE STREAMS AND PUMPED AROUND THE WORKING AREA.
 - 30' OF 60" METAL PIPE WILL BE INSTALLED AT STREAM CROSSING 1 AND 30' OF 36" HDPE PIPE WILL BE INSTALLED AT STREAM CROSSING 2.
 - A 6' X 20' RIP RAP PAD SHALL BE INSTALLED BELOW THE EXISTING FLOW LINE OF THE EXISTING STREAMS AT THE OUTLET END OF THE PIPES. NO PART OF THE RIP RAP APRONS SHOULD IMPEDE THE FLOW OF WATER.
- IMPACTED AREA AT STREAM CROSSING 1
 UPHILL STREAM ELEVATION = 380.8
 DOWNHILL STREAM ELEVATION = 379.8
- IMPACTED AREA AT STREAM CROSSING 2
 UPHILL STREAM ELEVATION = 387.9
 DOWNHILL STREAM ELEVATION = 386.8
- RIP RAP ARMORING SHALL BE PLACED AROUND BOTH ENDS OF THE PIPES.

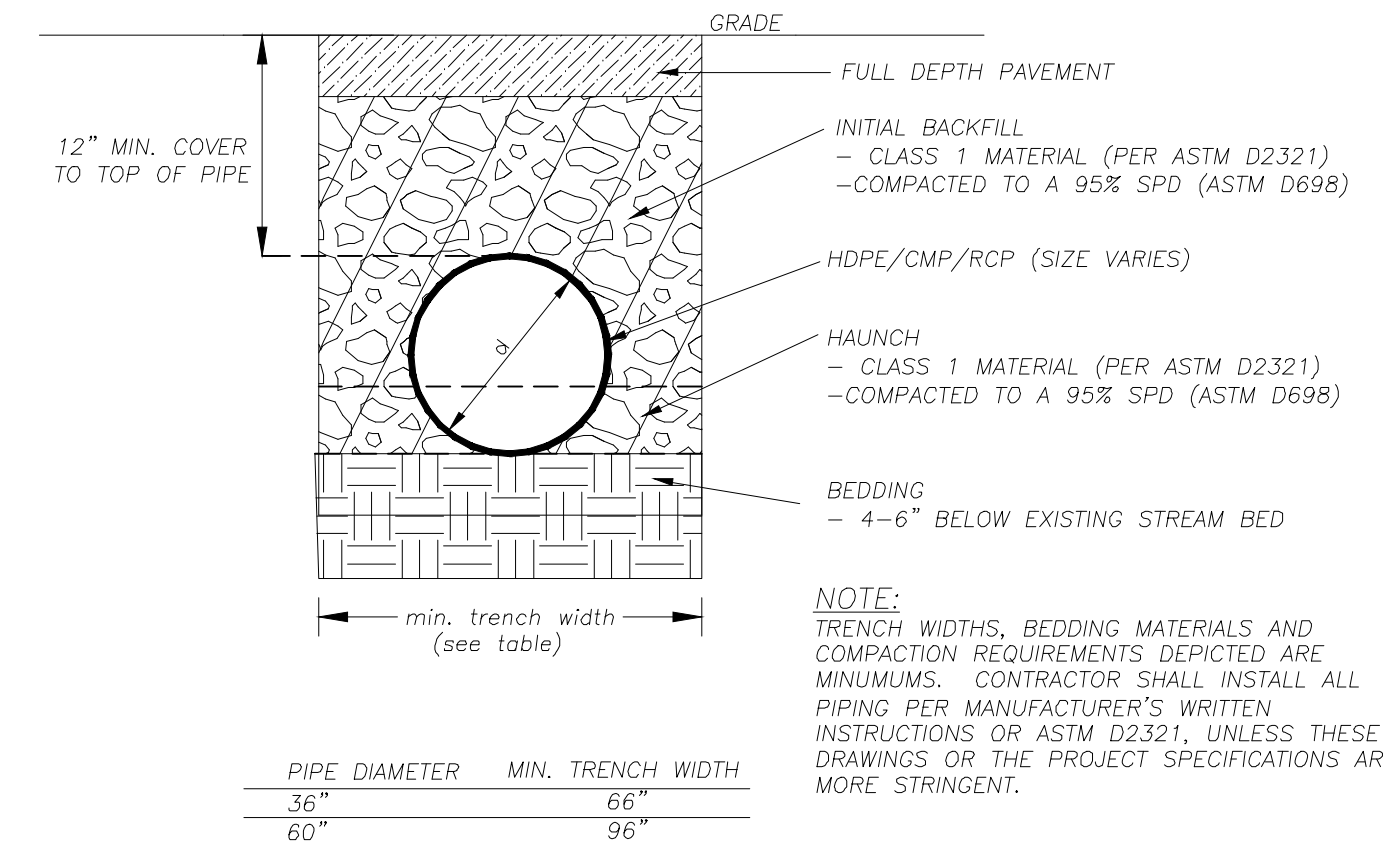

DRAINAGE PIPE TRENCH DETAIL
NO SCALE

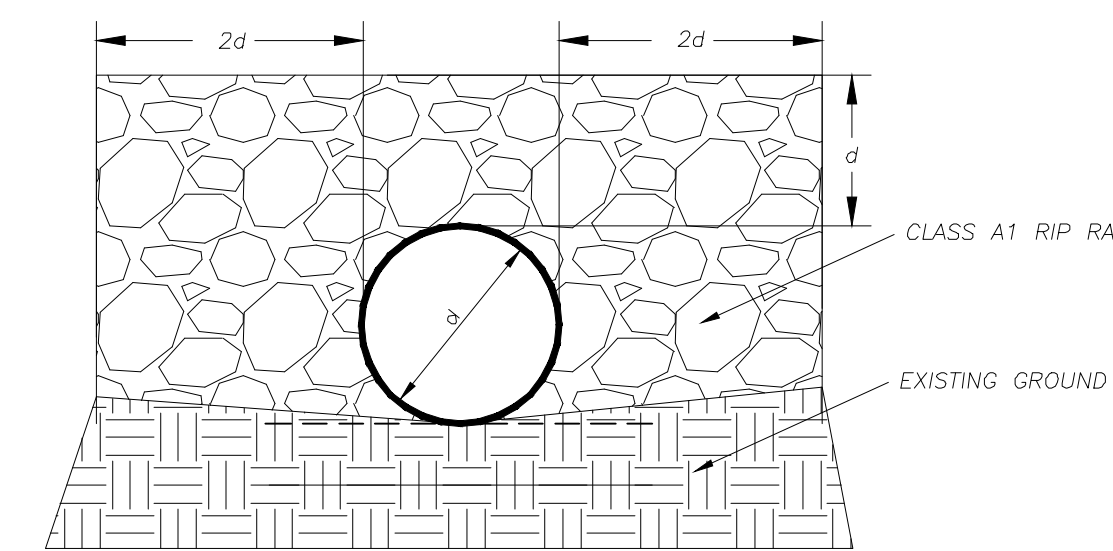

RIP RAP ARMOURING
NO SCALE

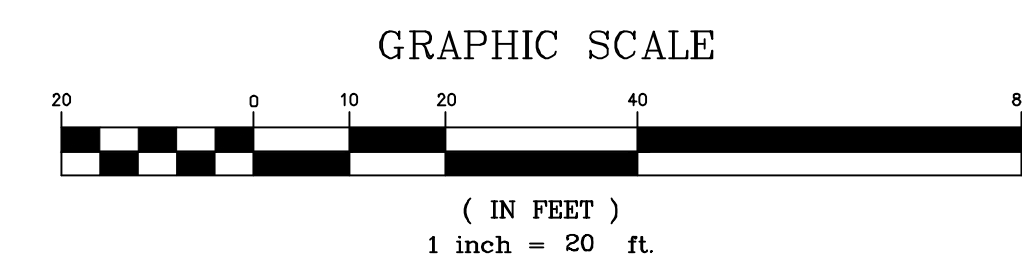

NO.	REVISIONS

THIS DRAWING SHALL BE CONSIDERED PRELIMINARY IN NATURE AND IN NO WAY SHALL BE USED FOR CONSTRUCTION WITHOUT THE APPROVAL OF THE ENGINEER OR SURVEYOR OF RECORDS AFFIXED HERETO.

NUMBER: C-400
 A.R.A.P.
L.I. Smith and Associates, Inc.
 LAND DEVELOPMENT | INFRASTRUCTURE DESIGN
 SURVEYING SERVICES
 302 North Caldwell Street, Paris, TN 38242 | 731-644-1014 | www.lismith.com
 475 Metroplex Drive, Suite 212 Nashville, TN 37211 | 615-256-0250
 DRAWN BY: TGT
 CHECKED BY: WFS
 SCALE: 1"=20'
 DATE: 08/28/2020
 PROJECT # 190258.44

4-L BROILER FARMS LLC-EAST
 TYSON BROILER FARM
 HERD LAW ROAD
 TRENTON, GIBSON COUNTY, TENNESSEE

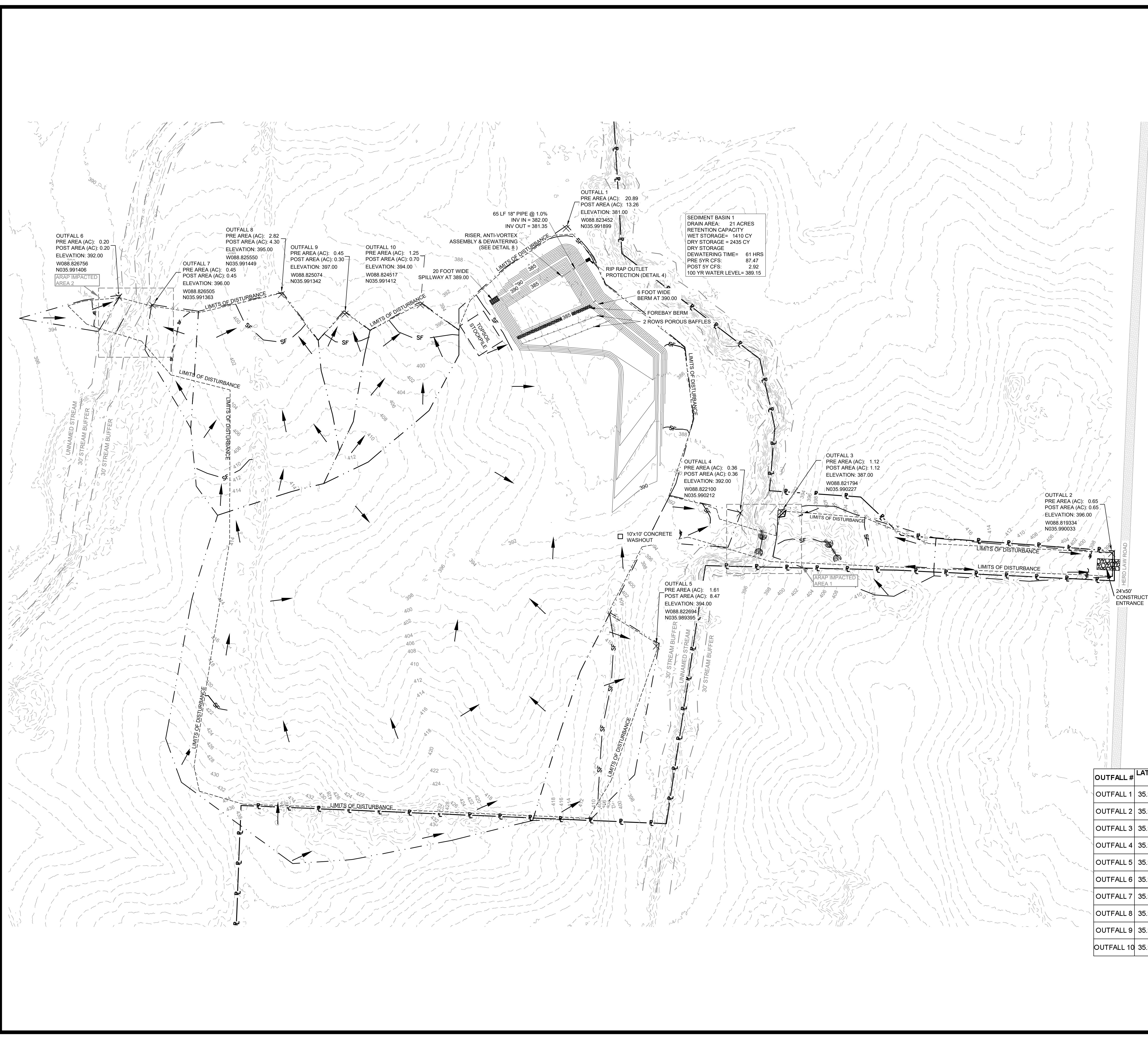

BEARING BASIS:
TENNESSEE STATE PLANE
COORDINATE SYSTEM -
NAD 1983
VERTICAL DATUM -
NAVD 1988

LEGEND

- PROPERTY LINE
- TREE LINE
- LIMIT OF DISTURBANCE
- 30' RIPARIAN BUFFER
- DRAINAGE AREA PERIMETER
- STANDARD SILT FENCE
- SLOPE ARROW
- STRAW WADDLE
- ENHANCED ROCK CHECK DAM
- ROCK CHECK DAM
- ROCK CHECK DAM AT PIPE INLET
- UNDISTURBED AREA
- EXISTING PAVEMENT
- PROPOSED STRUCTURE
- GRAVEL PAVEMENT
- STABILIZED AREA

INITIAL EROSION CONTROL NOTES

1. INSTALL 24'x50' CONSTRUCTION ENTRANCE ON EAST SIDE ONTO HERD LAW ROAD.
2. INSTALL APPROXIMATELY 2150 FT OF STANDARD SILT FENCE AND 120 FT OF WIRE BACKED SILT FENCE AROUND THE DOWNHILL PERIMETER OF THE SITE. NO DISTURBANCE SHALL BE MADE TO THE SITE UNTIL SILT FENCE IS INSTALLED.
3. CONSTRUCT A SEDIMENT BASIN WITH ASSOCIATED RISER, DISCHARGE, FOREBAY AND POUROUS BAFFLES AT OUTFALL 1.
4. ALL STORM WATER WILL BE DIRECTED TOWARD DETENTION POND VIA EARTHEN BERMS OR DITCHES.
5. NO EARTHWORK SHALL BEGIN UNTIL SILT FENCE, SEDIMENT BASINS AND OTHER EROSION CONTROL MEASURES ARE IN PLACE.
6. TOPSOIL WILL BE STRIPPED AND STOCKPILED ON SITE FOR FUTURE USE.
7. INSTALL CONCRETE WASHOUT ON SITE WITH DIRECTIONAL SIGNS FOR DRIVERS.
8. AFTER ANY CONSTRUCTION ACTIVITIES HAVE CEASED FOR 14 DAYS TEMPORARILY SEED AND STRAW ALL DISTURBED AREAS.

OUTFALL #	LATITUDE (N)	LONGITUDE (W)	APPROX. ELEV. (FEET)	PRE AREA (ACRES)	POST AREA (ACRES)	RECEIVING WATERS
OUTFALL 1	35.991899	88.823452	381	20.89	13.26	TRIBUTARY TO RUTHERFORD FORK OBION RIVER
OUTFALL 2	35.990033	88.819334	396	0.65	0.65	TRIBUTARY TO RUTHERFORD FORK OBION RIVER
OUTFALL 3	35.990227	88.821794	387	1.12	1.12	TRIBUTARY TO RUTHERFORD FORK OBION RIVER
OUTFALL 4	35.990212	88.822100	392	0.36	0.36	TRIBUTARY TO RUTHERFORD FORK OBION RIVER
OUTFALL 5	35.989395	88.822694	394	1.61	8.47	TRIBUTARY TO RUTHERFORD FORK OBION RIVER
OUTFALL 6	35.991406	88.826756	392	0.20	0.20	TRIBUTARY TO RUTHERFORD FORK OBION RIVER
OUTFALL 7	35.991363	88.826505	396	0.45	0.45	TRIBUTARY TO RUTHERFORD FORK OBION RIVER
OUTFALL 8	35.991449	88.825550	395	2.82	4.30	TRIBUTARY TO RUTHERFORD FORK OBION RIVER
OUTFALL 9	35.991342	88.825074	397	0.45	0.30	TRIBUTARY TO RUTHERFORD FORK OBION RIVER
OUTFALL 10	35.991412	88.824517	394	1.25	0.70	TRIBUTARY TO RUTHERFORD FORK OBION RIVER

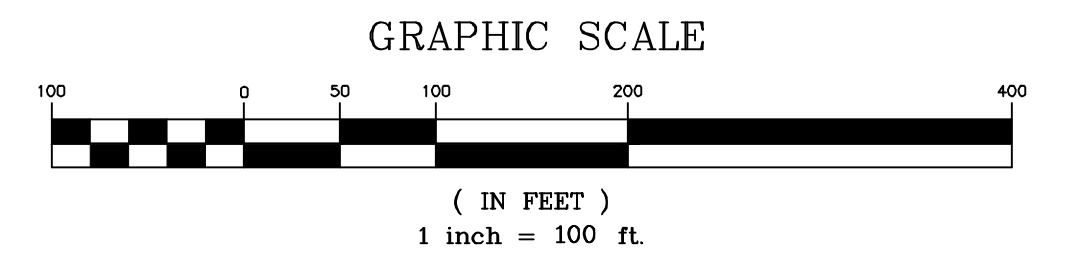

REVISIONS

NO.	DESCRIPTION

THIS DRAWING SHALL BE CONSIDERED PRELIMINARY IN NATURE AND IN NO WAY SHALL BE USED FOR CONSTRUCTION WITHOUT THE ENGINEER OR SURVEYOR OF RECORDS AFFIXED HERETO.

L. I. SMITH & ASSOCIATES, INC.
REGISTERED PROFESSIONAL ENGINEER
NO. 11111
STATE OF TENNESSEE

4-L BROILER FARMS LLC-EAST
TYSON BROILER FARM
HERD LAW ROAD
TRENTON, GIBSON COUNTY, TENNESSEE

SHEET: **E.P.S.C. INITIAL** NUMBER: **C-401**

L.I. Smith and Associates, Inc.
LAND DEVELOPMENT | INFRASTRUCTURE DESIGN
SURVEYING SERVICES

302 North Caldwell Street, Paris, TN 38242 | 731-644-1014 | www.lismith.com
475 Metroplex Drive, Suite 212 Nashville, TN 37211 | 615-256-0250

DRAWN BY: TGT CHECKED BY: WFS SCALE: 1"=100'
PROJECT # 190258.44 DATE: 08/28/2020

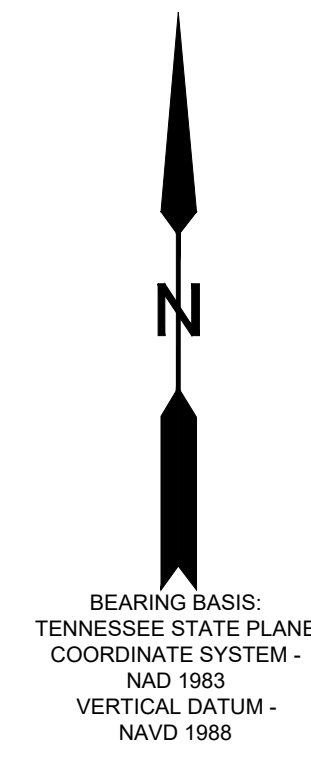
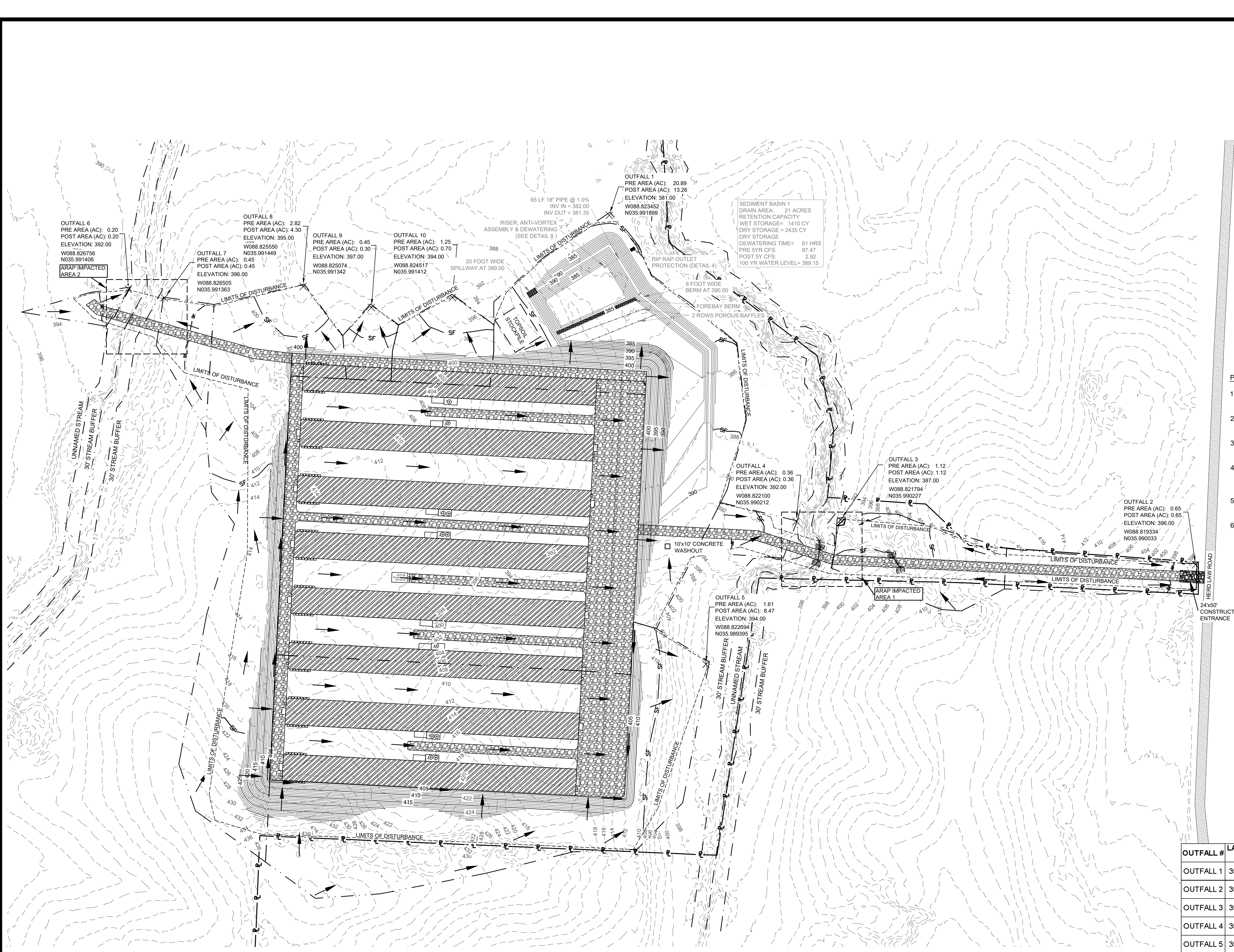

LEGEND

	PROPERTY LINE
	TREE LINE
	LIMIT OF DISTURBANCE
	30' RIPARIAN BUFFER
	DRAINAGE AREA PERIMETER
	STANDARD SILT FENCE
	SLOPE ARROW
	STRAW WADDLE
	ENHANCED ROCK CHECK DAM
	ROCK CHECK DAM
	ROCK CHECK DAM AT PIPE INLET
	UNDISTURBED AREA
	EXISTING PAVEMENT
	PROPOSED STRUCTURE
	GRAVEL PAVEMENT
	STABILIZED AREA

PHASE 2 NOTES

1. GRADING WILL BE STAGED TO KEEP STORM WATER RUNOFF DIVERTED TO SEDIMENT BASINS OR TO ENHANCED ROCK CHECK DAMS AT OUTFALLS.
2. EIGHT LEVEL PADS WILL BE ERECTED WITH ROADS AND SHALLOW SWALES BETWEEN THEM.
3. ROCK CHECK DAMS ARE TO BE INSTALLED EVERY 200 FEET IN DRAINAGE DITCHES AROUND THE SITE.
4. ONCE THE SITE IS BROUGHT UP TO GRADE STABILIZE IMPROVED AREAS WITH GRAVEL AND UNIMPROVED AREAS WITH SEED AND STRAW MULCH IN ACCORDANCE WITH TDEC STANDARDS.
5. SILT FENCE, CHECK DAMS AND OTHER BMPs TO BE CLEANED OF SEDIMENT ONCE 50% CAPACITY HAS BEEN REACHED.
6. ANY DISTURBED AREA THAT HAS NOT SEEN ANY ACTIVITY FOR 14 DAYS SHALL BE TEMPORARILY SEEDED AND STRAWED IN ACCORDANCE WITH TDEC STANDARDS.

Recommended Seeding Rates Region 1 (West TN)

Soil Condition	Best Results	Marginal Results	Preferred Rate/Mix (lbs/ac Pure Living Seed)
Poorly Drained Soils	Feb 1 - Mar 20 Sept 1 - Sept 30	Mar 20 - Apr 30 Sept 30 - Oct 31	25 Wheat Grass (nurse crop) 15 Browntop Millet* 2 Switch Grass 4 Little Blue Stream 4 Virginia Wild Rye 4 Purpletop 2 Patridge Pea 2 Black-eye Susan
Well Drained Soils	Apr 1 - July 15		25 Wheat Grass (nurse crop) 15 Browntop Millet* 4 Little Blue Stream 4 Virginia Wild Rye 4 Purpletop 2 Patridge Pea 2 Black-eye Susan
High Maintenance (Slopes)	Apr 1 - July 15 Sept 1 - Sept 30	Sept 30 - Oct 31	25 Wheat Grass (nurse crop) 15 Browntop Millet* 2 Patridge Pea 45 Red Fescue* 45 Hard Fescue*

* Non-Native but do not spread.

OUTFALL #	LATITUDE (N)	LONGITUDE (W)	APPROX. ELEV. (FEET)	PRE AREA (ACRES)	POST AREA (ACRES)	RECEIVING WATERS
OUTFALL 1	35.991899	88.823452	381	20.89	13.26	TRIBUTARY TO RUTHERFORD FORK OBION RIVER
OUTFALL 2	35.990033	88.819334	396	0.65	0.65	TRIBUTARY TO RUTHERFORD FORK OBION RIVER
OUTFALL 3	35.990227	88.821794	387	1.12	1.12	TRIBUTARY TO RUTHERFORD FORK OBION RIVER
OUTFALL 4	35.990212	88.822100	392	0.36	0.36	TRIBUTARY TO RUTHERFORD FORK OBION RIVER
OUTFALL 5	35.989395	88.822694	394	1.61	8.47	TRIBUTARY TO RUTHERFORD FORK OBION RIVER
OUTFALL 6	35.991406	88.826756	392	0.20	0.20	TRIBUTARY TO RUTHERFORD FORK OBION RIVER
OUTFALL 7	35.991363	88.826505	396	0.45	0.45	TRIBUTARY TO RUTHERFORD FORK OBION RIVER
OUTFALL 8	35.991449	88.825550	395	2.82	4.30	TRIBUTARY TO RUTHERFORD FORK OBION RIVER
OUTFALL 9	35.991342	88.825074	397	0.45	0.30	TRIBUTARY TO RUTHERFORD FORK OBION RIVER
OUTFALL 10	35.991412	88.824517	394	1.25	0.70	TRIBUTARY TO RUTHERFORD FORK OBION RIVER

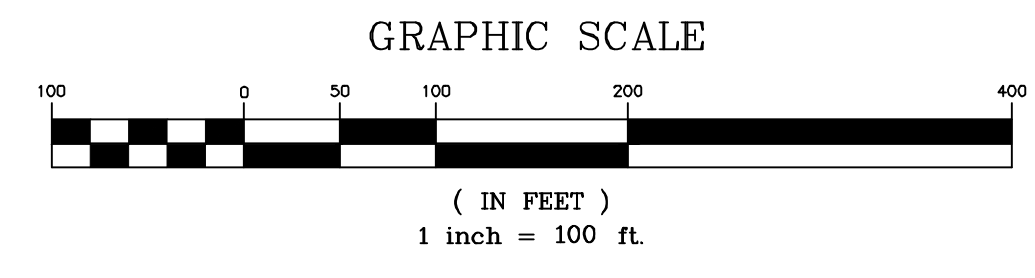

4-L BROILER FARMS LLC-EAST
TYSON BROILER FARM
HERD LAW ROAD
TRENTON, GIBSON COUNTY, TENNESSEE

REVISIONS

NO.	DESCRIPTION



E.P.S.C PHASE 2
C-402
L.I. Smith and Associates, Inc.
LAND DEVELOPMENT | INFRASTRUCTURE DESIGN
SURVEYING SERVICES
 302 North Caldwell Street, Paris, TN 38242 | 731-644-1014 | www.lismith.com
 475 Metropia Drive, Suite 212 Nashville, TN 37211 | 615-256-0250
 DRAWN BY: TGT
 CHECKED BY: WFS
 SCALE: 1"=100'
 DATE: 08/28/2020
 PROJECT # 190258.44

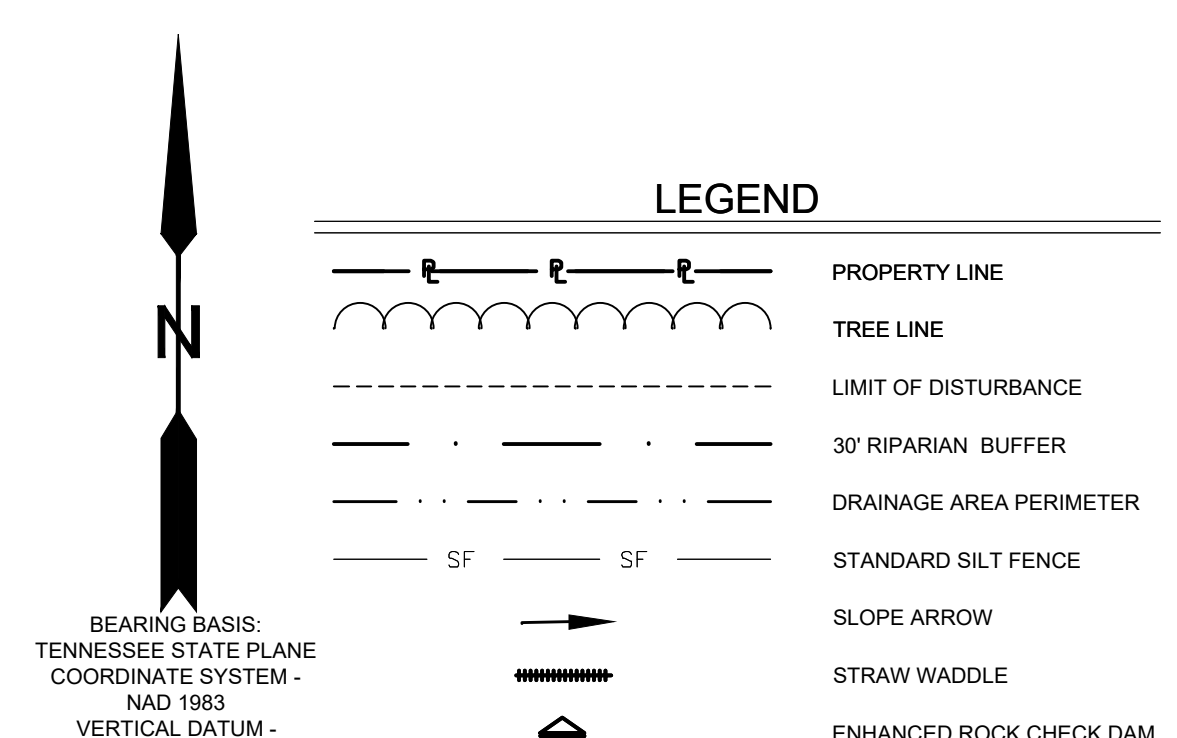

BEARING BASIS:
TENNESSEE STATE PLANE
COORDINATE SYSTEM -
NAD 1983
VERTICAL DATUM -
NAVD 1988

STABILIZATION NOTES

- AS SITE IS BROUGHT TO GRADE, ERECT STRUCTURES, GRAVEL IMPROVED AREAS, SPREAD TOPSOIL, SEED AND MULCH COMPLETED UNIMPROVED AREAS.
- SLOPES STEEPER THAN 3:1 WILL BE STABILIZED WITH CLASS A-1 RIP RAP OR SOD.
- ALL EROSION CONTROL MEASURES ARE TO REMAIN IN PLACE AND MAINTAINED UNTIL ALL DISTURBED AREAS HAVE BEEN STABILIZED AND CONSTRUCTION IS COMPLETE.
- ATLEAST A 70% STAND OF GREEN GROWTH OVER 100% OF BARE AREAS SHALL BE ACHIEVED BEFORE STABILIZATION IS CONSIDERED COMPLETE.
- SEDIMENT BASIN WILL BE REMOVED ONCE THE SITE HAS BEEN FULLY STABILIZED.

Recommended Seeding Rates Region 1 (West TN)			
Soil Condition	Best Results	Marginal Results	Preferred Rate/Mix (lbs/ac Pure Living Seed)
Poorly Drained Soils	Feb 1 - Mar 20 Sept 1 - Sept 30	Mar 20 - Apr 30 Sept 30 - Oct 31	25 Wheat Grass (nurse crop) 15 Browntop Millet* 2 Switch Grass 4 Little Blue Stream 4 Virginia Wild Rye 4 Purpletop 2 Patridge Pea 2 Black-eye Susan
Well Drained Soils	Apr 1 - July 15		25 Wheat Grass (nurse crop) 15 Browntop Millet* 4 Little Blue Stream 4 Virginia Wild Rye 4 Purpletop 2 Patridge Pea 2 Black-eye Susan
High Maintenance (Slopes)	Apr 1 - July 15 Sept 1 - Sept 30	Sept 30 - Oct 31	25 Wheat Grass (nurse crop) 15 Browntop Millet* 2 Patridge Pea 45 Red Fescue* 45 Hard Fescue*

* Non-Native but do not spread.

OUTFALL #	LATITUDE (N)	LONGITUDE (W)	APPROX. ELEV. (FEET)	PRE AREA (ACRES)	POST AREA (ACRES)	RECEIVING WATERS
OUTFALL 1	35.991899	88.823452	381	20.89	13.26	TRIBUTARY TO RUTHERFORD FORK OBION RIVER
OUTFALL 2	35.990033	88.819334	396	0.65	0.65	TRIBUTARY TO RUTHERFORD FORK OBION RIVER
OUTFALL 3	35.990227	88.821794	387	1.12	1.12	TRIBUTARY TO RUTHERFORD FORK OBION RIVER
OUTFALL 4	35.990212	88.822100	392	0.36	0.36	TRIBUTARY TO RUTHERFORD FORK OBION RIVER
OUTFALL 5	35.989395	88.822694	394	1.61	8.47	TRIBUTARY TO RUTHERFORD FORK OBION RIVER
OUTFALL 6	35.991406	88.826756	392	0.20	0.20	TRIBUTARY TO RUTHERFORD FORK OBION RIVER
OUTFALL 7	35.991363	88.826505	396	0.45	0.45	TRIBUTARY TO RUTHERFORD FORK OBION RIVER
OUTFALL 8	35.991449	88.825550	395	2.82	4.30	TRIBUTARY TO RUTHERFORD FORK OBION RIVER
OUTFALL 9	35.991342	88.825074	397	0.45	0.30	TRIBUTARY TO RUTHERFORD FORK OBION RIVER
OUTFALL 10	35.991412	88.824517	394	1.25	0.70	TRIBUTARY TO RUTHERFORD FORK OBION RIVER

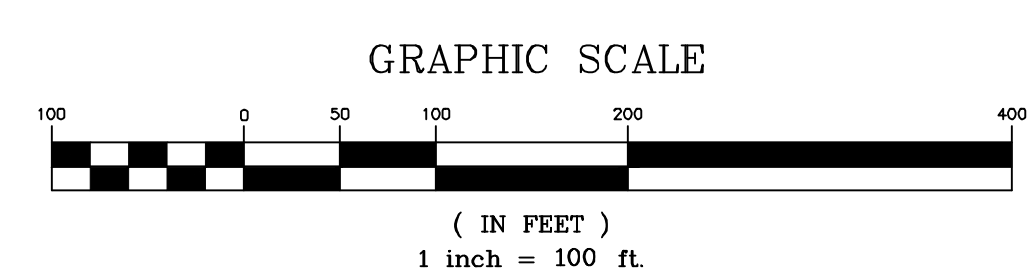

4-L BROILER FARMS LLC-EAST
TYSON BROILER FARM
HERD LAW ROAD
TRENTON, GIBSON COUNTY, TENNESSEE

REVISIONS

NO.	DESCRIPTION

© 2020 L.I. SMITH & ASSOCIATES, INC.
ALL RIGHTS RESERVED. THESE PLANS ARE THE INTELLECTUAL PROPERTY OF L.I. SMITH & ASSOCIATES, INC. THESE PLANS, DESIGNS, DATA AND/OR INFORMATION HAVE BEEN PREPARED SOLELY FOR THOSE PARTIES NAMED HEREON. USE OF THESE PLANS BY ANY OTHER PARTIES, OR USE OF THESE PLANS FOR ANY OTHER PROJECT, WITHOUT THE WRITTEN CONSENT OF L.I. SMITH & ASSOCIATES, INC., SHALL BE CONSIDERED UNAUTHORIZED AND IN VIOLATION OF COPYRIGHT LAWS.



THIS DRAWING SHALL BE CONSIDERED PRELIMINARY IN NATURE AND IN NO WAY SHALL BE USED FOR CONSTRUCTION WITHOUT THE ENGINEER OR SURVEYOR OF RECORD'S AFFIXED HERE TO.

NUMBER: **C-403**

SHEET: **E.P.S.C PHASE 3**

L.I. Smith and Associates, Inc.
LAND DEVELOPMENT | INFRASTRUCTURE DESIGN
SURVEYING SERVICES

302 North Caldwell Street, Paris, TN 38242 | 731-644-1014 | www.lismith.com
475 Metropia Drive, Suite 212 Nashville, TN 37211 | 615-256-0250

DRAWN BY: TGT
CHECKED BY: WFS
SCALE: 1"=100'
DATE: 08/28/2020
PROJECT # 190258.44

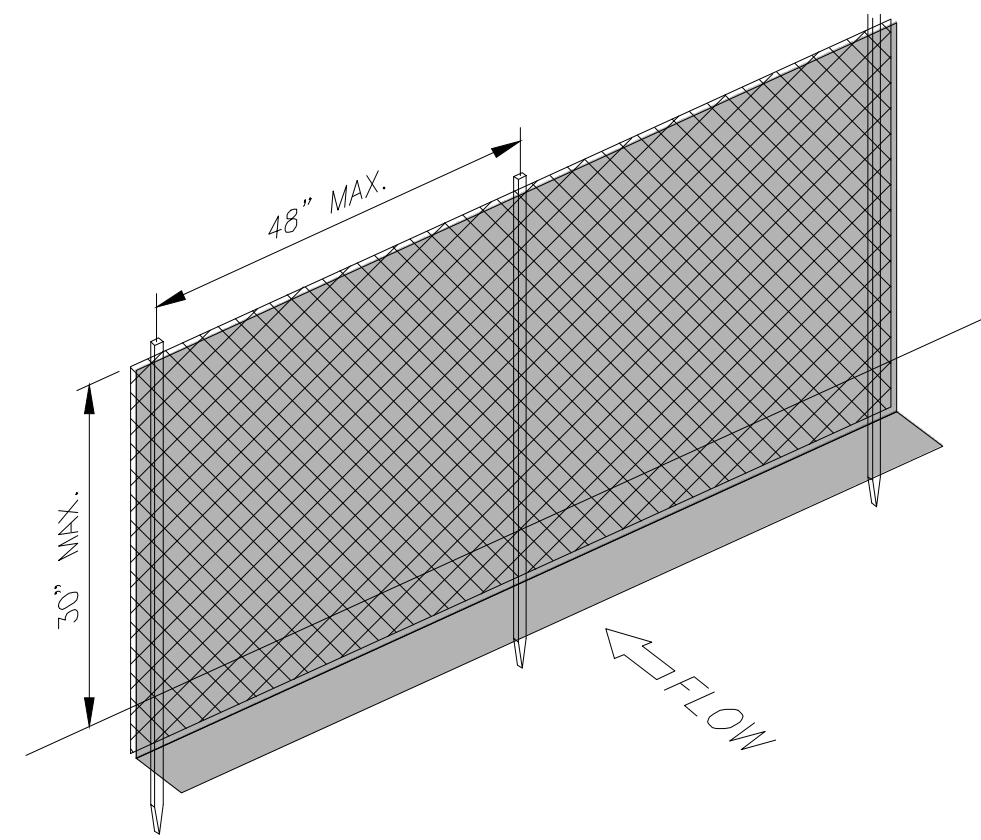

1 TYPE C SILT FENCE (WITH BACKING)
NO SCALE

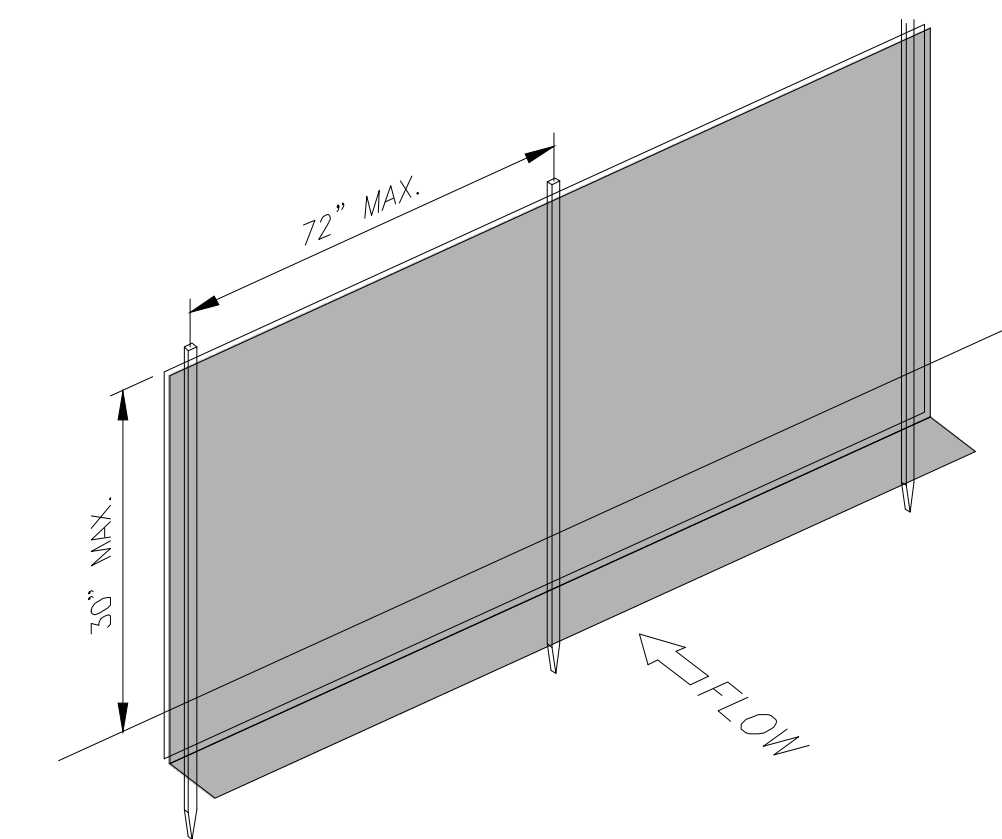
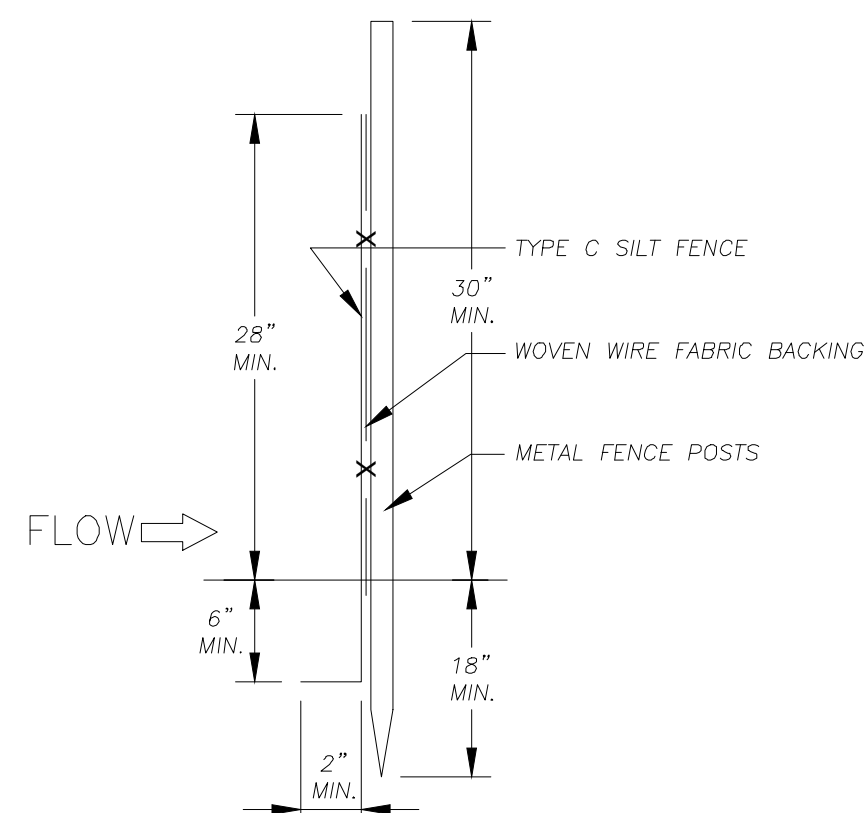

2 STANDARD SILT FENCE (WITHOUT BACKING)
NO SCALE

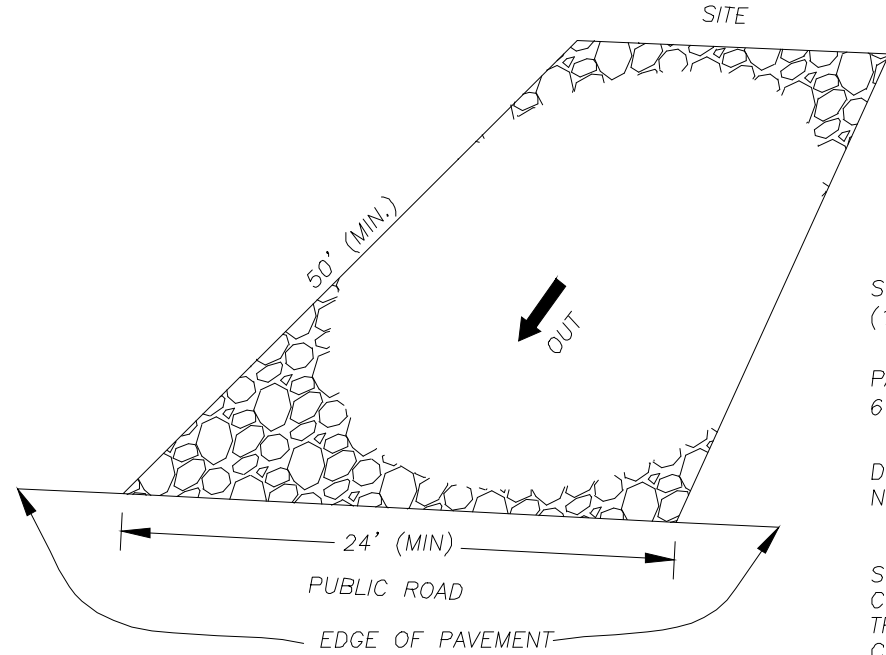
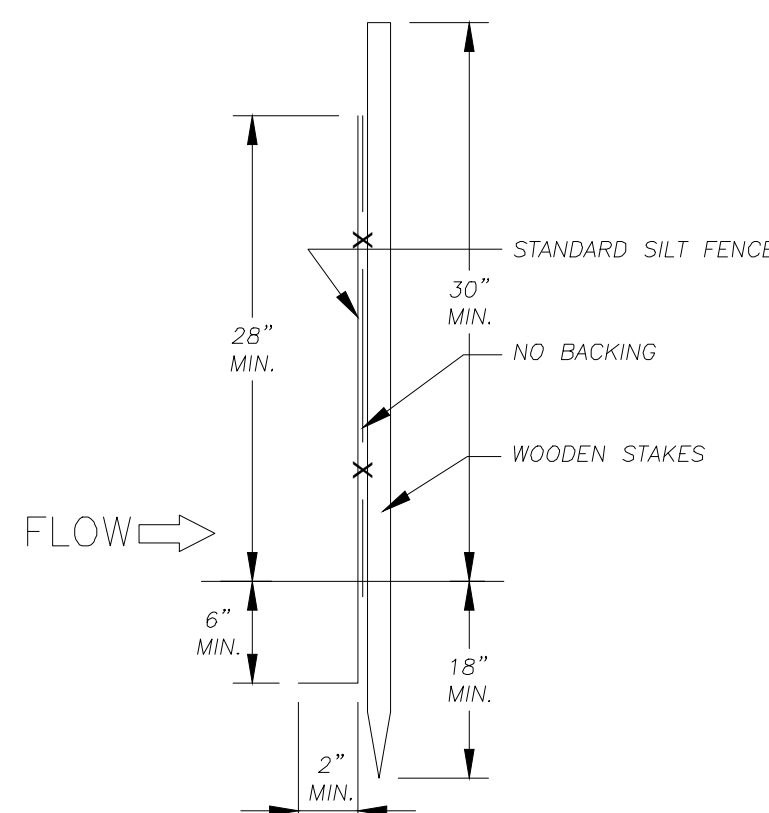

STONE SIZE ASTM D4448 No. 1
(1-1/2" - 3-1/2" DIA.)
PAD IS 50" (MINIMUM) IN LENGTH BY
6" MIN. DEPTH BY 24" MIN. WIDTH
DRESS WITH ADDITIONAL STONE AS
NEEDED.
STONE IS TO BE MAINTAINED IN A
CONDITION AS TO PREVENT MUD
TRACKING FROM TIRES BY
CONSTRUCTION TRAFFIC.

3 TEMPORARY CONSTRUCTION EXIT
NO SCALE

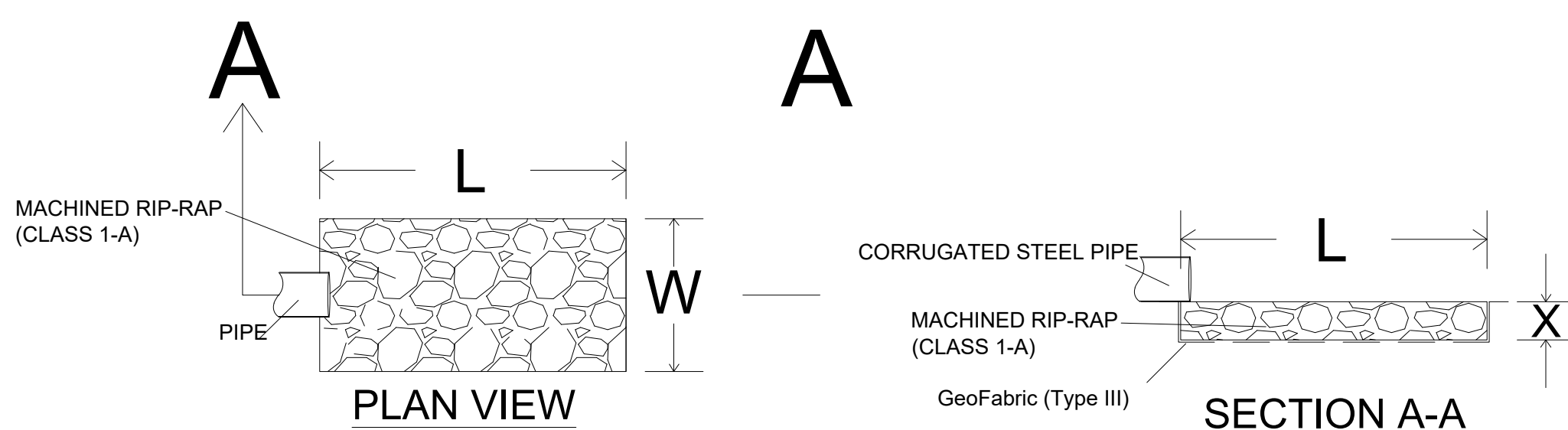

4 OUTLET PROTECTION

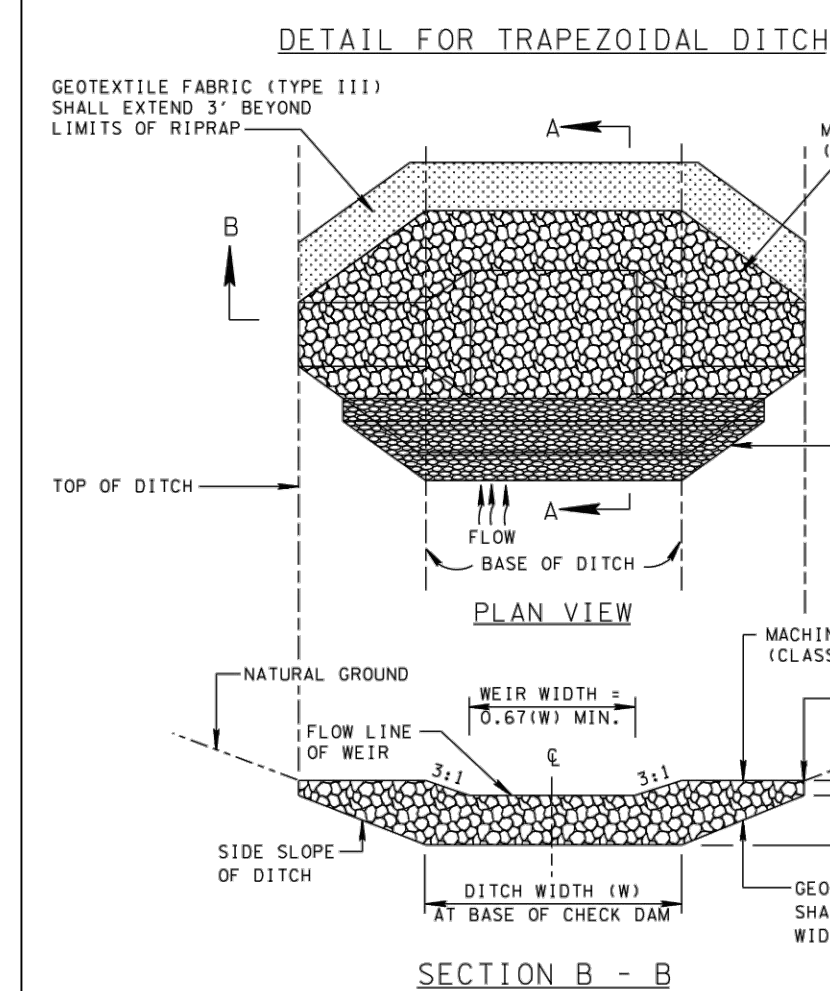

DEPTH	V-DITCH			TRAPEZOIDAL DITCH		
	MINERAL AGGREGATE (SIZE 57) (TON)	MACHINED RIPRAP (CLASS A-1) (TON)	GEOTEXTILE FABRIC (TYPE III) (SQ YD)	MINERAL AGGREGATE (SIZE 57) (TON)	MACHINED RIPRAP (CLASS A-1) (TON)	GEOTEXTILE FABRIC (TYPE III) (SQ YD)
1.5	0.21	12.2	31.7	0.29	17.2	40.3
2.0	0.33	20.2	44.0	0.44	27.5	54.7
2.5	0.48	31.1	59.3	0.62	41.2	71.0
3.0	0.66	45.1	74.7	0.83	58.5	89.3

1. ESTIMATED QUANTITIES BASED ON 4:1 SIDE SLOPES. QUANTITIES WILL VARY BASED ON ACTUAL DITCH CONFIGURATION.
2. ESTIMATED QUANTITIES BASED ON 4 FT BOTTOM WIDTH, 4 FT DEPTH, AND 4:1 SIDE SLOPES. QUANTITIES WILL VARY BASED ON ACTUAL DITCH CONFIGURATION.

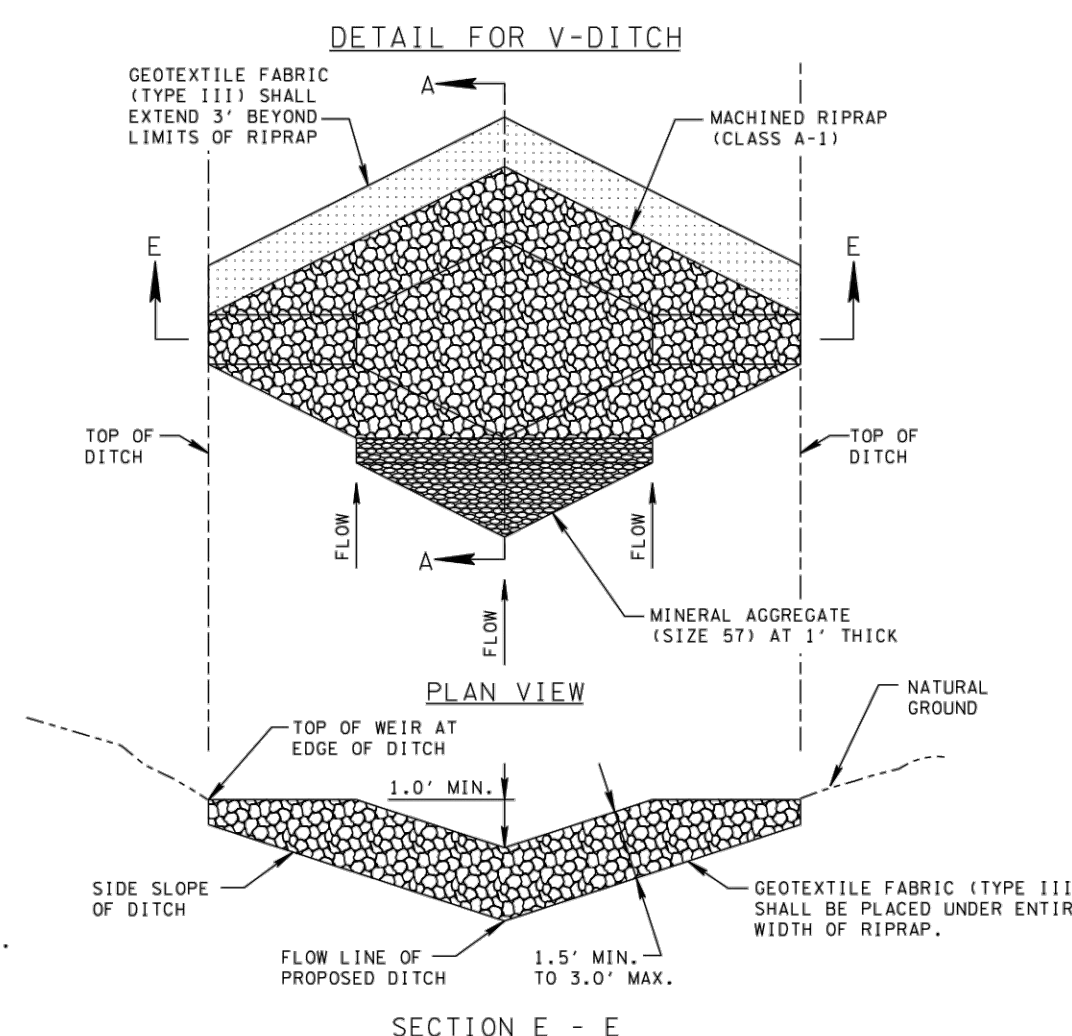
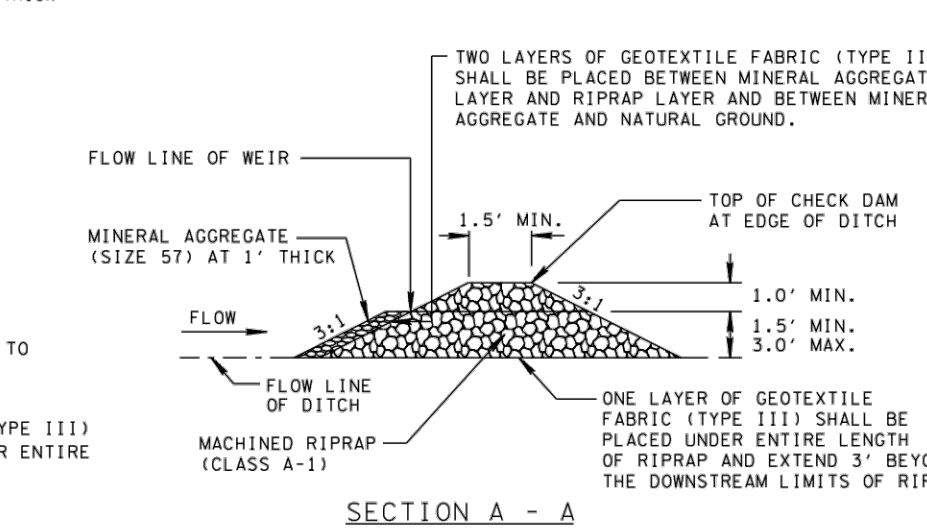
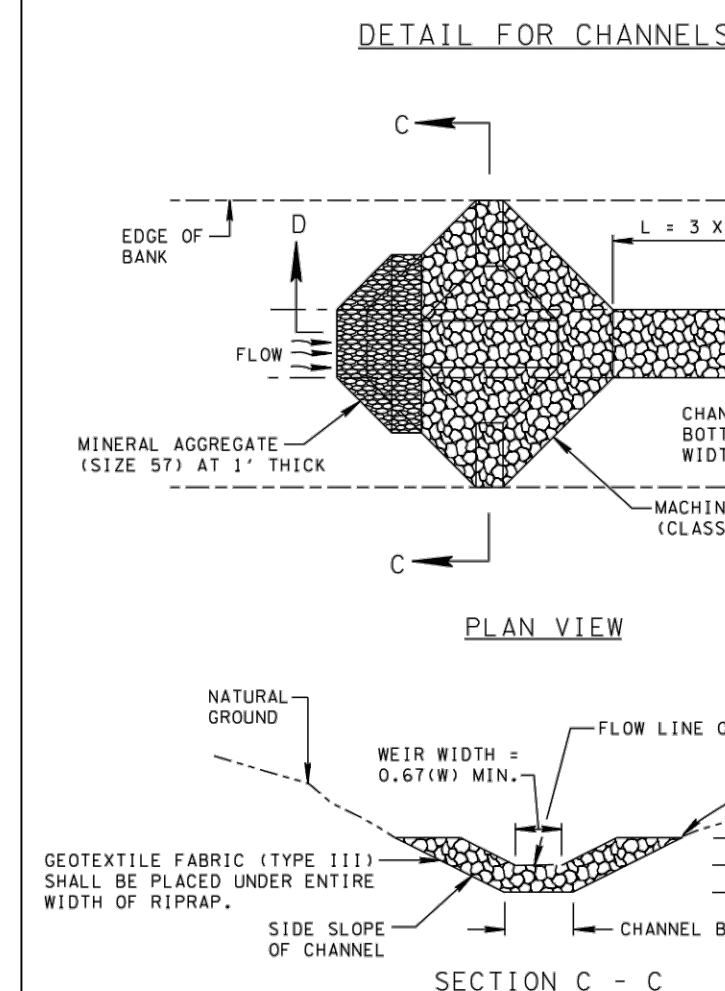

ENHANCED ROCK CHECK DAM GENERAL NOTES

- ENHANCED ROCK CHECK DAMS MAY BE USED TO REDUCE FLOW VELOCITIES TO ALLOW SEDIMENTS TO DROP OUT. THEY MAY BE EMPLOYED WHERE THE DRAINAGE AREA EXCEEDS THE MAXIMUM FOR ROCK CHECK DAMS OR WHERE A FILTRATION FUNCTION FOR VERY LOW FLOWS IS DESIRED. ENHANCED ROCK CHECK DAMS SHALL NOT BE USED IN STREAMS OR WETLANDS UNLESS PROVIDED FOR IN THE PERMITS.
- AT MOST SITES, THE MAXIMUM ALLOWABLE DRAINAGE AREA SHALL BE 30 ACRES. AT SITES WHICH DRAIN TO EXCEPTIONAL TENNESSEE WATERS OR SEDIMENT-IMPAIRED STREAMS, THE MAXIMUM ALLOWABLE DRAINAGE AREA SHALL BE 20 ACRES.
- ENHANCED CHECK DAM MAY REMAIN IN PLACE AS PERMANENT CHECK DAM, IF SHOWN IN THE PLANS OR AS DIRECTED BY THE ENGINEER.
- THE CENTER OF THE ENHANCED ROCK CHECK DAM USED IN DITCHES MUST BE AT LEAST ONE (1) FOOT LOWER THAN THE OUTER EDGES. THE CENTER OF ENHANCED ROCK CHECK DAMS USED IN CHANNELS MUST BE AT LEAST TWO (2) FEET LOWER THAN THE OUTER EDGES.
- THE DEPTH OF FLOW ON THE CENTER OF THE STRUCTURE SHALL BE COMPUTED FOR THE PEAK FLOW RATE GENERATED BY THE 2-YEAR, 24-HOUR STORM IN ORDER TO ENSURE THAT THE TOP OF THE STRUCTURE WILL NOT BE OVERTOPPED. FOR SITES WHICH DRAIN TO EXCEPTIONAL TENNESSEE WATERS OR SEDIMENT-IMPAIRED STREAMS, THE DEPTH SHOULD BE DETERMINED FOR THE 5-YEAR, 24-HOUR PEAK FLOW RATE. THIS WILL ELIMINATE THE ROCK-SOIL FAILURE POINT WHERE THE ENHANCED ROCK CHECK DAM AND NATURAL GROUND MERGE.
- THE MAXIMUM SPACING BETWEEN ENHANCED ROCK CHECK DAMS SHOULD BE SUCH THAT THE TOE OF THE UPSTREAM IS AT THE SAME ELEVATION AS THE FLOW LINE OF THE WEIR OF THE DOWNSTREAM DAM. (SEE ROCK CHECK DAM SPACING GRAPH ON EC-SIR-6)
- ONLY GEOTEXTILE FABRIC (TYPE III) LISTED ON THE QUALIFIED PRODUCTS LIST SHALL BE USED.
- SEDIMENT SHALL BE REMOVED FROM BEHIND THE ENHANCED ROCK CHECK DAM WHEN IT HAS ACCUMULATED TO ONE-HALF THE ORIGINAL HEIGHT OF THE STRUCTURE

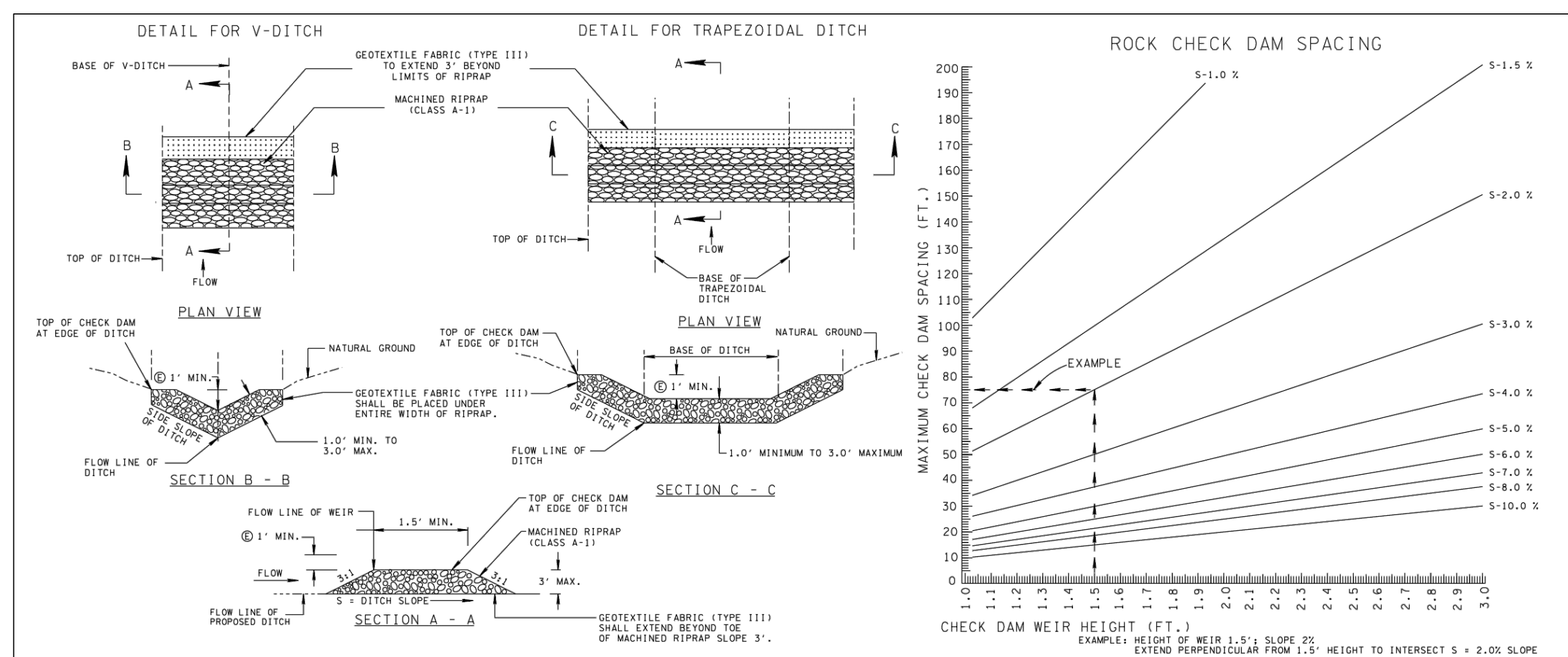

ROCK CHECK DAM GENERAL NOTES

- ROCK CHECK DAMS ARE TO BE USED FOR VELOCITY REDUCTION AND EROSION PREVENTION IN AREAS WHERE CONCENTRATED FLOW EXISTS. ROCK CHECK DAMS SHALL NOT BE USED IN STREAMS OR OTHER NATURAL WATER RESOURCES. ROCK CHECK DAMS ARE NOT TO BE USED FOR SEDIMENT CONTROL AND SHOULD NOT BE CONSIDERED A SEDIMENT TRAPPING DEVICE.
- THE DRAINAGE AREA FOR THE ROCK CHECK DAMS SHALL BE 10 ACRES OR LESS.
- ROCK CHECK DAMS MAY REMAIN IN PLACE AS PERMANENT CHECK DAMS, IF SHOWN IN THE PLANS OR AS DIRECTED BY THE ENGINEER.
- THE CENTER OF THE ROCK CHECK DAM MUST BE AT LEAST ONE (1) FOOT LOWER THAN THE OUTER EDGES.
- THE DEPTH OF FLOW ON THE CENTER OF THE STRUCTURE SHALL BE COMPUTED FOR THE PEAK FLOW RATE GENERATED BY THE 2-YEAR, 24-HOUR STORM IN ORDER TO ENSURE THAT THE TOP OF THE STRUCTURE WILL NOT BE OVERTOPPED. FOR SITES WHICH DRAIN TO EXCEPTIONAL TENNESSEE WATERS OR SEDIMENT-IMPAIRED STREAMS, THE DEPTH SHOULD BE DETERMINED FOR THE 5-YEAR, 24-HOUR PEAK FLOW RATE. THIS WILL ELIMINATE THE ROCK-SOIL FAILURE POINT WHERE THE ROCK CHECK DAM AND NATURAL GROUND MERGE.
- FOR SITES WHICH DRAIN TO EXCEPTIONAL TENNESSEE WATERS OR SEDIMENT-IMPAIRED STREAMS, THE MINIMUM HEIGHT OF THE STRUCTURE ABOVE THE DITCH BOTTOM SHALL BE INCREASED TO 2 FEET.
- THE MAXIMUM SPACING BETWEEN ROCK CHECK DAMS SHOULD BE SUCH THAT THE TOE OF THE UPSTREAM DAM IS AT THE SAME ELEVATION AS THE FLOW LINE OF THE WEIR OF THE DOWNSTREAM DAM (SEE ROCK CHECK DAM SPACING GRAPH THIS SHEET).
- ONLY GEOTEXTILE FABRIC (TYPE III) LISTED ON THE QUALIFIED PRODUCTS LIST SHALL BE USED.
- SEDIMENT SHALL BE REMOVED FROM BEHIND THE ROCK CHECK DAMS WHEN IT HAS ACCUMULATED TO ONE-HALF THE ORIGINAL HEIGHT OF THE DAM

DITCH	2:1 DITCH SLOPE			3:1 DITCH SLOPE			4:1 DITCH SLOPE		
	HEIGHT FT	RIP RAP TON	GEOTEXTILE SF	HEIGHT FT	RIP RAP TON	GEOTEXTILE SF	HEIGHT FT	RIP RAP TON	GEOTEXTILE SF
V-DITCH	1.5	6.5	15.8	1.5	7.2	23.7	1.5	12.0	30.9
	2.0	13.0	24.6	2.0	18.4	34.8	2.0	24.1	45.4
	2.5	22.8	33.9	2.5	31.3	48.0	2.5	37.1	62.9
	3.0	36.5	44.7	3.0	51.7	63.2	3.0	63.2	82.5
TRAPEZOIDAL DITCH	1.5	8.9	21.5	1.5	11.5	28.1	1.5	11.5	28.9
	2.0	16.9	27.5	2.0	22.8	38.1	2.0	21.9	52.9
	2.5	28.7	42.5	2.5	38.3	58.5	2.5	31.9	73.2
	3.0	44.7	56.7	3.0	58.8	76.5	3.0	41.9	92.4

1. ESTIMATED QUANTITIES BASED ON 4:1 SIDE SLOPES. QUANTITIES WILL VARY BASED ON ACTUAL DITCH CONFIGURATION.
2. ESTIMATED QUANTITIES BASED ON 4 FT BOTTOM WIDTH, AND 4:1 SIDE SLOPES. QUANTITIES WILL VARY BASED ON ACTUAL DITCH CONFIGURATION.

4-L BROILER FARMS LLC-EAST
TYSON BROILER FARM
HERD LAW ROAD
TRENTON, GIBSON COUNTY, TENNESSEE

REVISIONS

NO.	DESCRIPTION

THIS DRAWING SHALL BE CONSIDERED PRELIMINARY IN NATURE AND IN NO WAY SHALL BE USED FOR PERMITS, RECORDS, THE ENGINEER OR SURVEYOR OF RECORDS AFFIXED HERETO.

© 2020 L.I. SMITH & ASSOCIATES, INC.
ALL RIGHTS RESERVED. NO PART OF THIS DOCUMENT IS TO BE REPRODUCED OR TRANSMITTED IN ANY FORM OR BY ANY MEANS, ELECTRONIC OR MECHANICAL, INCLUDING PHOTOCOPYING, RECORDING, OR BY ANY INFORMATION STORAGE AND RETRIEVAL SYSTEM, WITHOUT THE WRITTEN PERMISSION OF L.I. SMITH & ASSOCIATES, INC.

L.I. SMITH & ASSOCIATES, INC.
REGISTERED PROFESSIONAL ENGINEER
STATE OF TENNESSEE
No. 11111
Exp. 12/31/2024

SITE DETAILS

L.I. Smith and Associates, Inc.
LAND DEVELOPMENT | INFRASTRUCTURE DESIGN
— SURVEYING SERVICES —

302 North Caldwell Street, Paris, TN 38242 | 731-644-1014 | www.lismith.com
475 Metropark Drive, Suite 212 Nashville, TN 37211 | 615-256-0250

DRAWN BY: TGT
CHECKED BY: WFS
SCALE: DATE: 08/28/2020
PROJECT # 190258.44

5

SEDIMENT BASIN 1 (OUTFALL 1) CROSS SECTION & DEWATERING APPARATUS WITH DRAWDOWN DEVICE

NOT TO SCALE

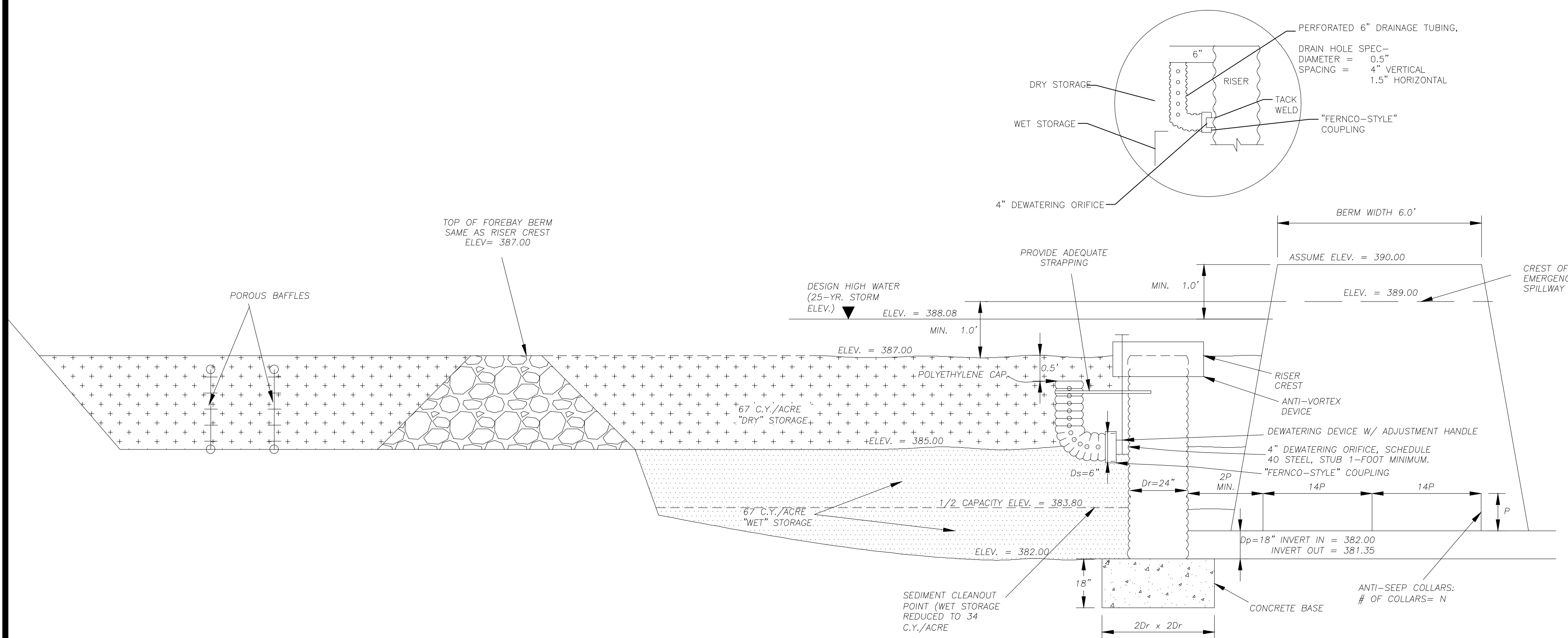

7 CORRUGATED METAL ANTI-SEEP COLLAR

NO SCALE

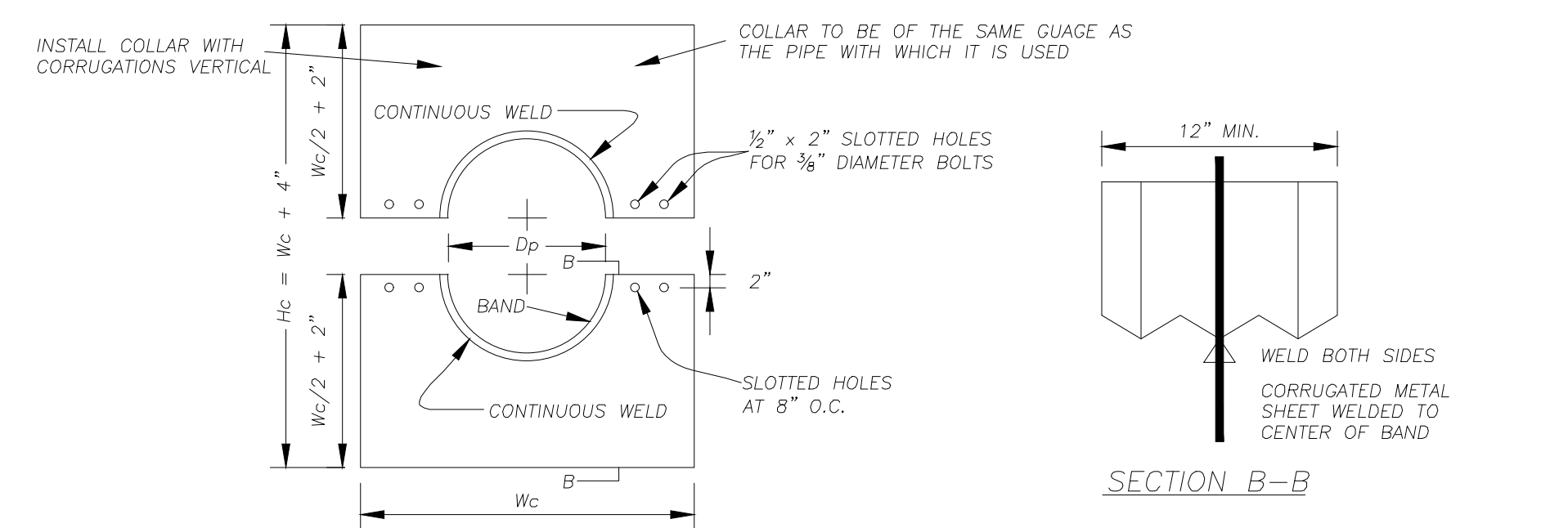

- NOTES FOR COLLARS:
1. ALL MATERIALS TO BE IN ACCORDANCE WITH CONSTRUCTION AND CONSTRUCTION MATERIAL SPECIFICATIONS.
 2. WHEN SPECIFIED ON THE PLANS, COATING OF COLLARS SHALL BE IN ACCORDANCE WITH CONSTRUCTION AND CONSTRUCTION MATERIAL SPECIFICATIONS.
 3. UNASSEMBLED COLLARS SHALL BE MARKED BY PAINTING OR TAGGING TO IDENTIFY MATCHING PAIRS
 4. THE LAP BETWEEN THE TWO HALF SECTIONS AND BETWEEN THE PIPE AND THE CONNECTING BAND SHALL BE CAULKED WITH ASPHALT MASTIC AT TIME OF INSTALLATION.
 5. EACH COLLAR SHALL BE FURNISHED WITH TWO 1/2" DIAMETER RODS WITH STANDARD TANK LUGS FOR CONNECTING COLLARS TO PIPE.

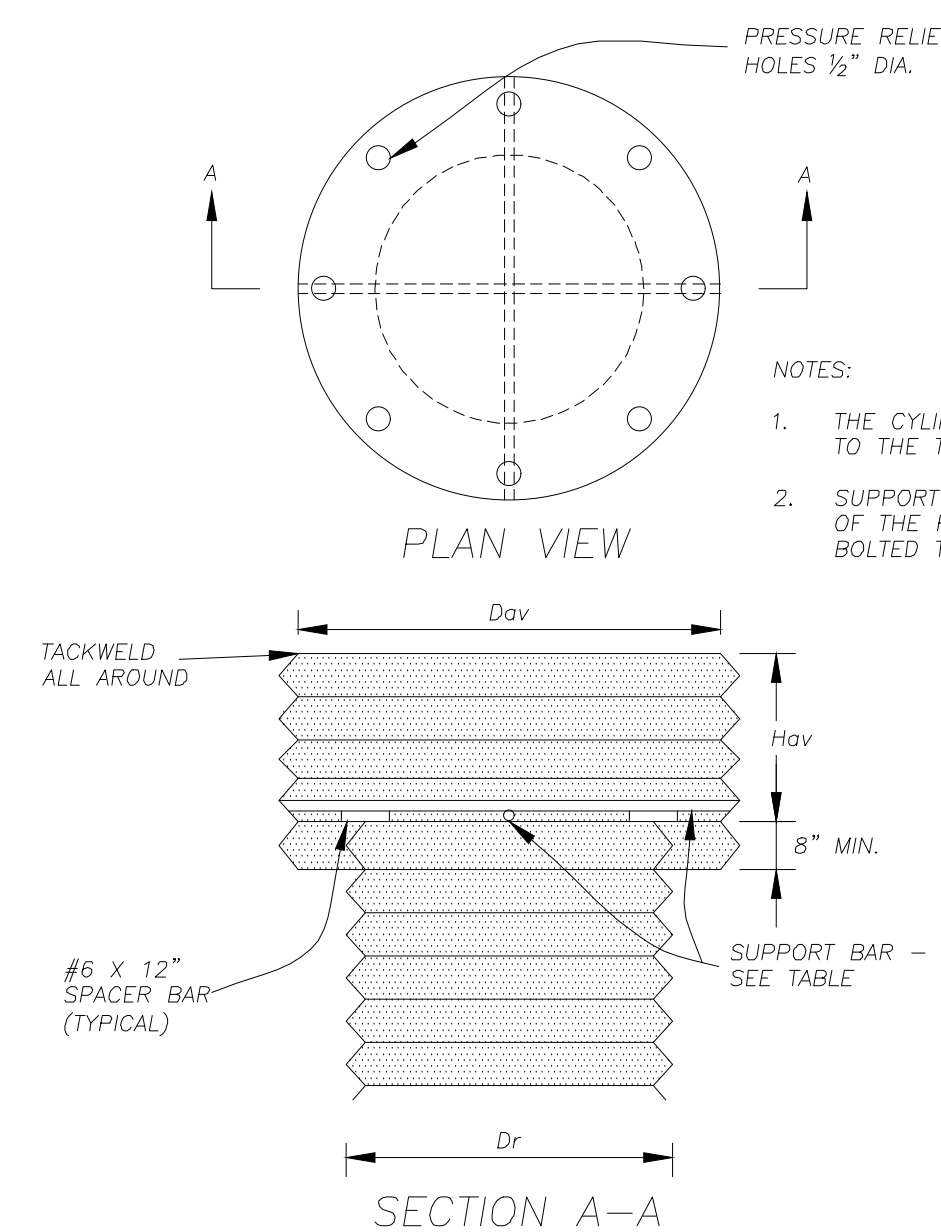

8 ANTI-VORTEX DEVICE

NO SCALE

4-L BROILER FARMS LLC-EAST
TYSON BROILER FARM
HERD LAW ROAD
TRENTON, GIBSON COUNTY, TENNESSEE

REVISIONS

NO.	DESCRIPTION

© 2020 L.I. SMITH & ASSOCIATES, INC.
 ALL INFORMATION HAS BEEN PREPARED SOLELY FOR THOSE PARTIES NAMED LISTED HEREON. USE OF THESE PLANS BY ANY OTHER PARTIES, OR USE OF THESE PLANS IN ANY MANNER NOT INTENDED BY THE ORIGINAL DESIGNER, SHALL BE CONSIDERED UNAUTHORIZED.

THIS DRAWING SHALL BE CONSIDERED PRELIMINARY IN NATURE AND IN NO WAY SHALL BE USED FOR CONSTRUCTION WITHOUT THE APPROVAL OF THE ENGINEER OR SURVEYOR OF RECORD AS AFFIRMED HERETO.

L.I. Smith & Associates, Inc.
 PROFESSIONAL ENGINEER
 STATE OF TENNESSEE

SHEET: **SITE DETAILS** NUMBER: **C-901**

L.I. Smith and Associates, Inc.
 LAND DEVELOPMENT | INFRASTRUCTURE DESIGN
 SURVEYING SERVICES

302 North Caldwell Street, Paris, TN 38242 | 731-644-1014 | www.lismith.com
 475 Metropolis Drive, Suite 212 Nashville, TN 37211 | 615-255-0250

DRAWN BY: TGT CHECKED BY: WFS SCALE: DATE: 08/28/2020
 PROJECT # 190258.44