



May 11, 2023

Mr. Mike Lee  
Environmental Consultant  
Division of Water Resources  
Natural Resources Unit  
William R. Snodgrass TN Tower, 11<sup>th</sup> Floor  
312 Rosa L. Parks Ave.  
Nashville, TN 37243

*Delivered via electronic mail to:* [Water.Permits@tn.gov](mailto:Water.Permits@tn.gov); [mike.lee@tn.gov](mailto:mike.lee@tn.gov)

Dear Mr. Lee:

**Subject:** Required Submittal Due – A.O. Smith Flood Control Levee  
Aquatic Resource Alteration Permit – NRS17.220  
Cheatham County, TN  
CEC Project 331-869

Civil & Environmental Consultants, Inc. (CEC) is pleased to provide a summary update of the project:

1. Construction of the Area A (Borrow Area 1, BA-1) consisting of 8.54 acres, Area B (Borrow Area 2, BA-2) consisting of 3.87 acres and the Fishing Lake (Borrow Area 3, BA-3) consisting of 6.0 acres began in February of 2021. These areas were excavated to provide material for the construction of the earthen levee.
2. Area A (BA-1) was completed first in March of 2021 per the design plans and permit, Area B (BA-2) was initially completed second in April of 2021. Tree planting in this area occurred in April of 2021.
3. Area B saw corrective action to increase the total area and grade as specified in the plans in early 2023. As built is attached.
4. The Fishing Lake was completed in November of 2022. Once final grading was completed, dewatering measures were removed, and the lake was allowed to fill naturally.
5. Bridge on removal on Puzzle Fool Creek at Rhea Street and the access drive to AO Smith off Cumberland Street has been completed. Bridge structures have been removed and the banks have been graded to match the existing stream cross section.

Cior matting was used to stabilize the banks and the area was overseeded and trees have been planted.

6. Construction of the levee was completed, and the general contractor demobilized in March of 2023.
7. Plantings as outlined in the PRM plan will need to be completed in the fall of 2023.

## 1.0 PHOTOGRAPHS



Bridge Removal Puzzle Fool Creek – A.O. Smith Entrance



Bridge Removal Puzzle Fool Creek - Rhea Street



Large Flood wall STR-8 Relocation



Area A (BA-1)



Area 2 (BA-2)



Fishing Lake (BA-3)

Mr. Lee – Division of Water Resources  
CEC Project 154-203  
Page 6  
May 11, 2023

## 2.0 CLOSING

CEC appreciates the opportunity to assist you with this project. Please review the provided information and let me know if you need additional information to satisfy the permit requirements.

Sincerely,

CIVIL & ENVIRONMENTAL CONSULTANTS, INC.



Jay J. Cameli, R.L.A.  
Principal



Jeffery Shaver, P.E.  
Principal



**BORROW AREA TWO  
FIELD TOPO 05-20-2022**

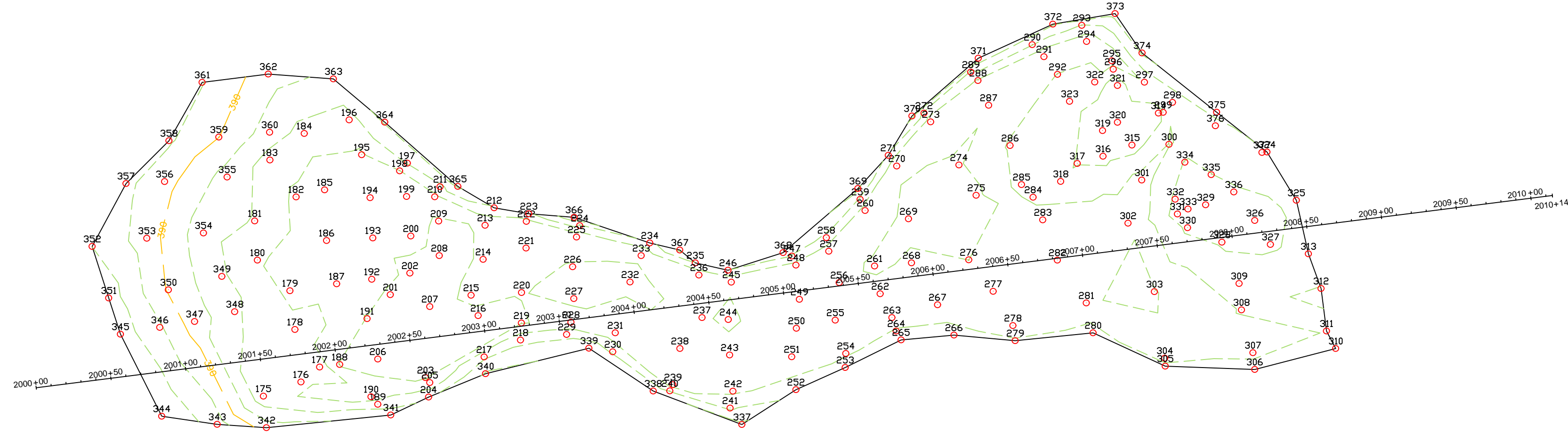

**BORROW AREA THREE  
FIELD TOPO 06-06-2022**

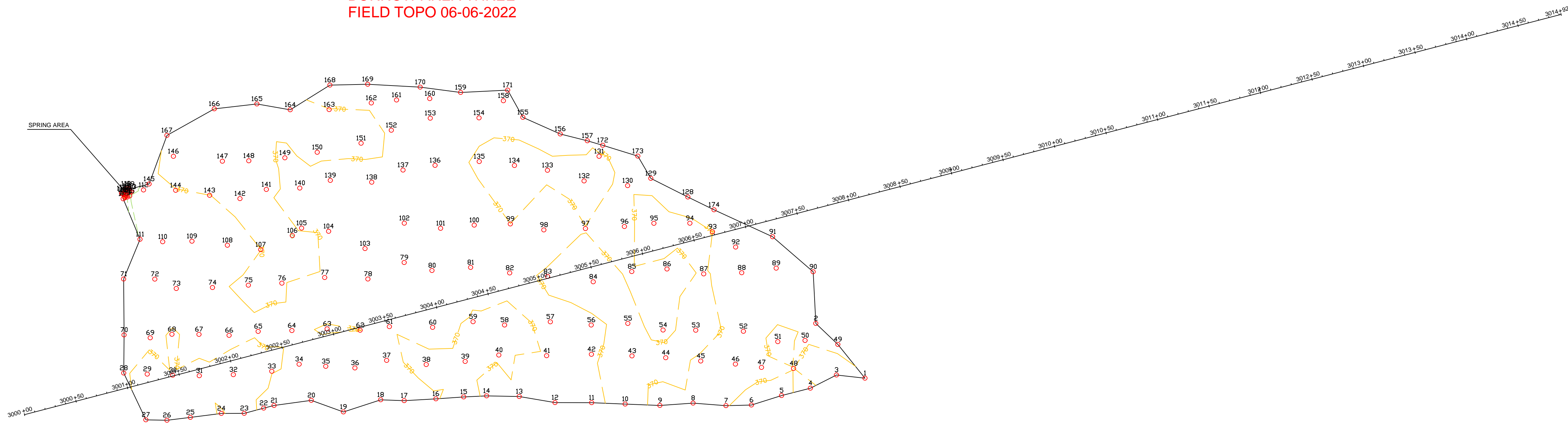

**NOTES**

1. INFORMATION SHOWN ON SHEET WAS DRAWN BY WRIGHT BROTHERS CONSTRUCTION AND SENT TO CEC VIA EMAIL DATED 07/05/2022.

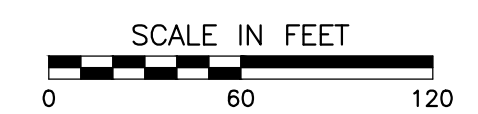

**DRAFT**

**REVISION RECORD**

NO	DATE	DESCRIPTION

**Civil & Environmental Consultants, Inc.**  
 117 Seaboard Lane - Suite E-100 - Franklin, TN 37067  
 615-333-7797 · 800-763-2326  
 www.cecinc.com

**A.O. SMITH**  
**500 TENNESSEE WALTZ PARKWAY**  
**ASHLAND CITY**  
**CHEATHAM COUNTY, TN**

**BORROW AREA EXHIBIT**

DATE: MAY 2023 [DRAWN BY: OTHERS]  
 DWG SCALE: AS SHOWN [CHECKED BY: 154-203]  
 PROJECT NO:  
 APPROVED BY:

DRAWING NO. **EX01**  
SHEET OF

\\srm-fs-na1\projects\2015\154-203\Communications\Construction Administration\TDCS-Mike Lee\Exhibit for Day\154203-CWT-Borrow\_Areas.dwg[AS-BUILT]\_LS(07/11/2023 - zcrone) - LP, 9/11/2023 12:11 PM

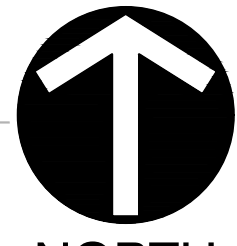

NORTH

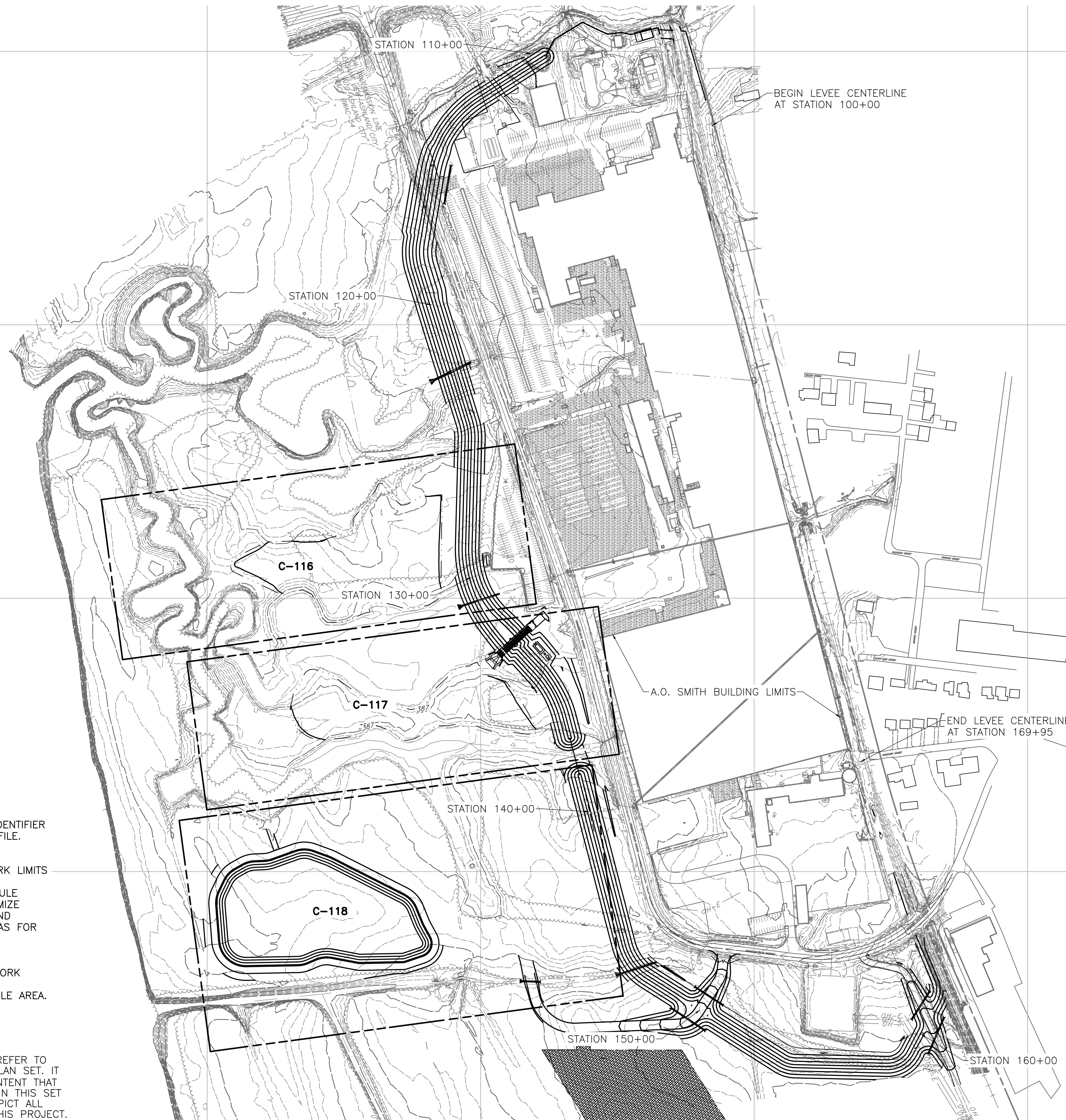

NOTES:

1. THIS KEY PLAN SERVES AS THE SHEET IDENTIFIER FOR THE BORROW AREA PLANS AND PROFILE.
2. SEE SHEET G-003 FOR LEGEND.
3. SEE SHEET G-100 FOR PROPERTY LINES.
4. SEE SHEET V-100 FOR CONTRACTOR WORK LIMITS AND LIMITS OF CLEARING AND GRUBBING.
5. CONTRACTOR TO COORDINATE AND SCHEDULE DEVELOPMENT OF BORROW AREA TO MINIMIZE EARTH DISTURBANCE AREA. UTILIZE GROUND SURFACE OF UNDEVELOPED BORROW AREAS FOR TOPSOIL STOCKPILE AREAS AS NEEDED.
6. TEST BORING INFORMATION PROVIDED IN GEOTECHNICAL REPORT.
7. SEE SHEET C-120 FOR BORROW AREA WORK POINTS.
8. SEE SHEET C-120 FOR TOPSOIL STOCKPILE AREA.

NOTE TO CONTRACTOR:

THE CONTRACTOR SHALL REFER TO ALL PLANS WITHIN THIS PLAN SET. IT IS NOT THE ENGINEER'S INTENT THAT ANY SINGLE PLAN SHEET IN THIS SET OF DOCUMENTS FULLY DEPICT ALL WORK ASSOCIATED WITH THIS PROJECT.



Know what's below. Call before you dig.

ISSUED FOR CONSTRUCTION

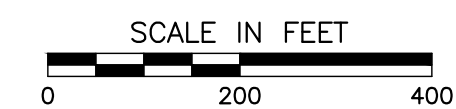
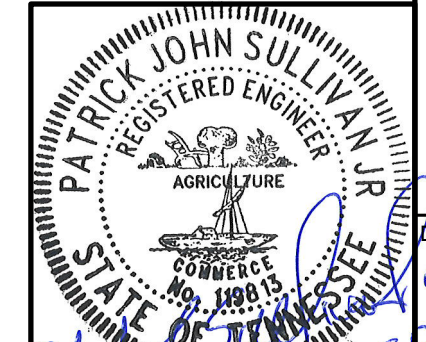

KEY PLAN ON-SITE BORROW AREAS

DATE: SEPTEMBER 2020  
DRAWN BY: AAS  
DWG SCALE: AS SHOWN  
CHECKED BY: JBS  
PROJECT NO: 154-203  
APPROVED BY: PJS/JJC

A.O. SMITH  
FLOOD CONTROL PROJECT  
500 TENNESSEE WALTZ PARKWAY  
ASHLAND CITY  
CHEATHAM COUNTY, TN

**CEC**  
Civil & Environmental Consultants, Inc.  
117 Seaboard Lane · Suite E-100 · Franklin, TN 37067  
615-333-7797 · 800-763-2326  
www.cecinc.com

REVISION RECORD

NO	DATE	DESCRIPTION

DRAWING NO.:  
**C-115**  
SHEET OF

P:\2015\154-203\154-203.dwg (DWG) | 154203-001-C-115.kpl (PLOT) - 11/16/2020 2:30 PM



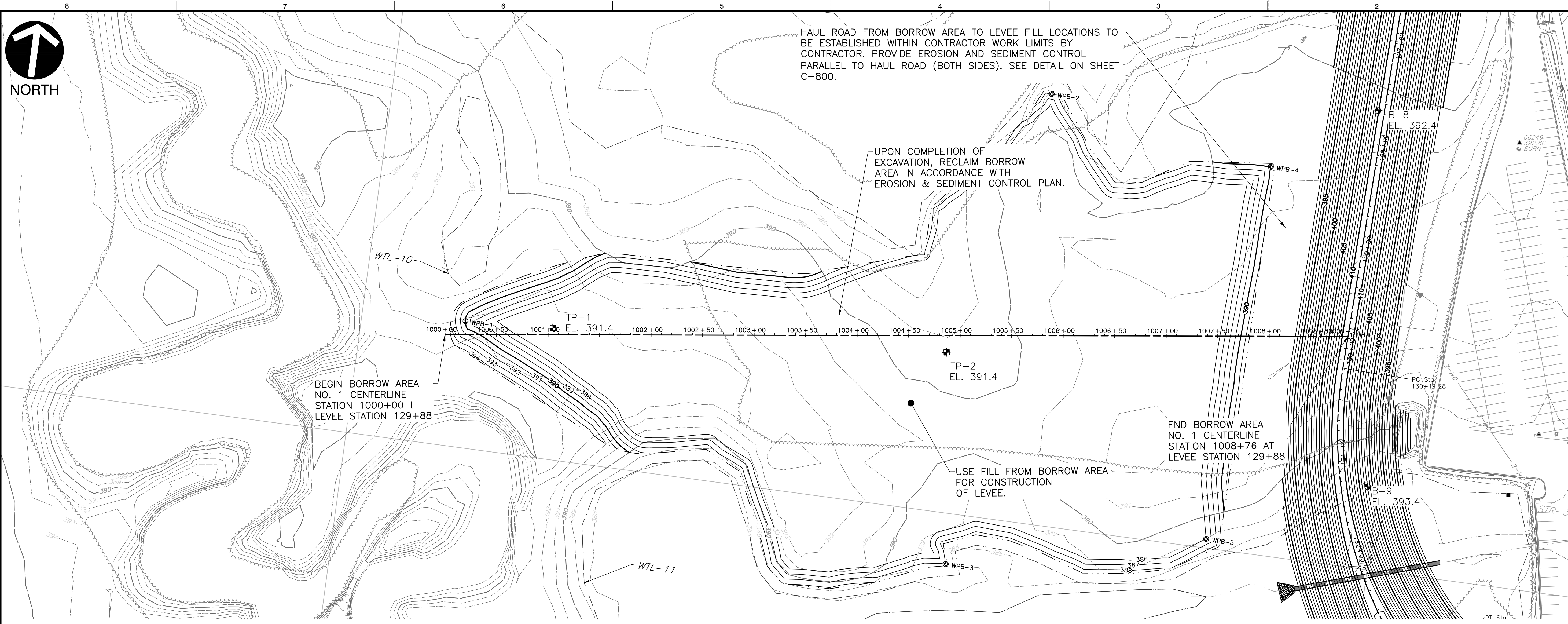
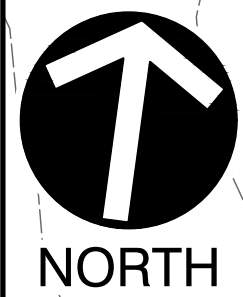

**ON-SITE BORROW AREA NO. 1 - PLAN**

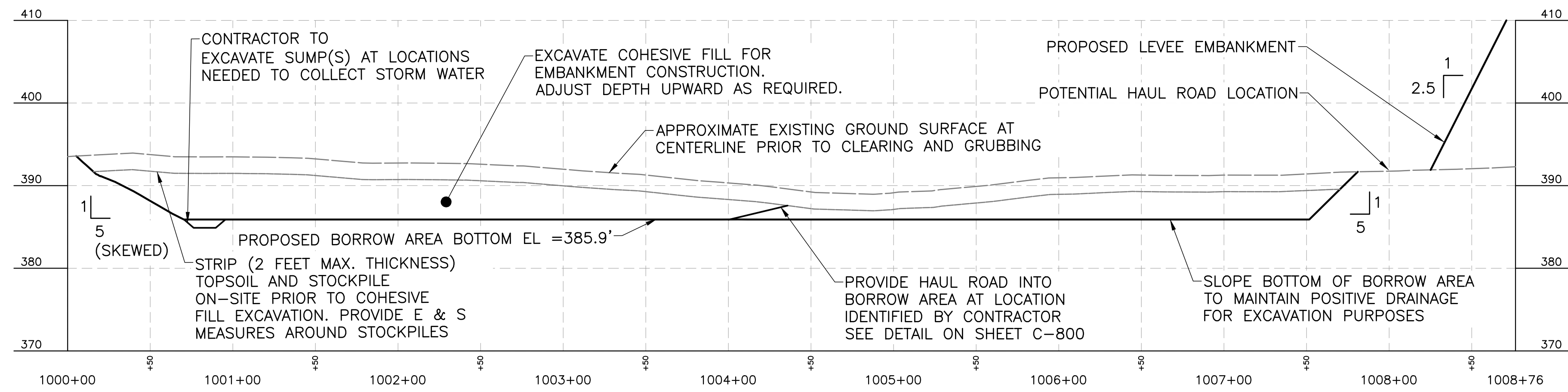
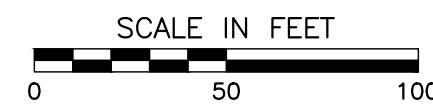

**BORROW AREA NO. 1 PROFILE**

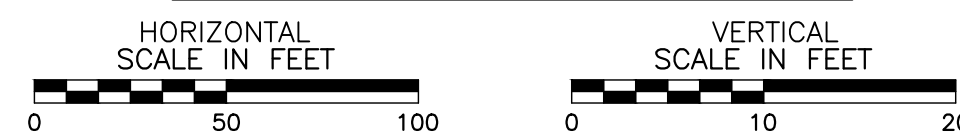

- NOTES:  
1. SEE NOTES ON SHEET C-115.



Know what's below.  
Call before you dig.

**NOTE TO CONTRACTOR:**

THE CONTRACTOR SHALL REFER TO ALL PLANS WITHIN THIS PLAN SET. IT IS NOT THE ENGINEER'S INTENT THAT ANY SINGLE PLAN SHEET IN THIS SET OF DOCUMENTS FULLY DEPICT ALL WORK ASSOCIATED WITH THIS PROJECT.

NO.	DATE	DESCRIPTION

**Civil & Environmental Consultants, Inc.**  
117 Seaboard Lane · Suite E-100 · Franklin, TN 37067  
615-333-7797 · 800-763-2326  
www.ceeinc.com

**A.O. SMITH  
FLOOD CONTROL PROJECT  
500 TENNESSEE WALTZ PARKWAY  
ASHLAND CITY  
CHEATHAM COUNTY, TN**

DATE:	SEPTEMBER 2020
DRAWN BY:	AAS
CHECKED BY:	JBS
PROJECT NO.:	154-203
APPROVED BY:	PJS/JJC

ON-SITE BORROW AREA NO. 1

ISSUED FOR CONSTRUCTION

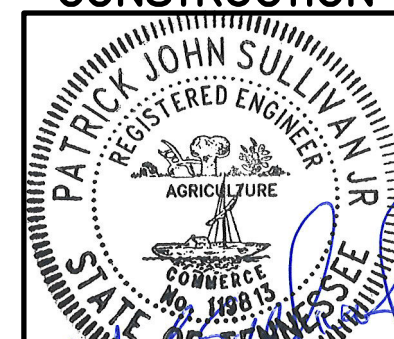

DRAWING NO.:  
**C-116**

P:\2015\154-203\154-203.dwg (DWG) | 154203-001-C-116.dwg | 11/15/2020 2:30 PM | LP: 10/22/2020 7:30 PM  
 F:\2015\154-203\154-203.dwg (DWG) | 154203-001-C-116.dwg | 11/15/2020 2:30 PM | LP: 10/22/2020 7:30 PM

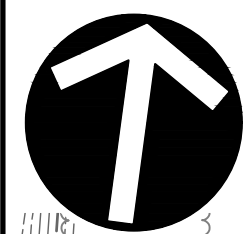

NORTH

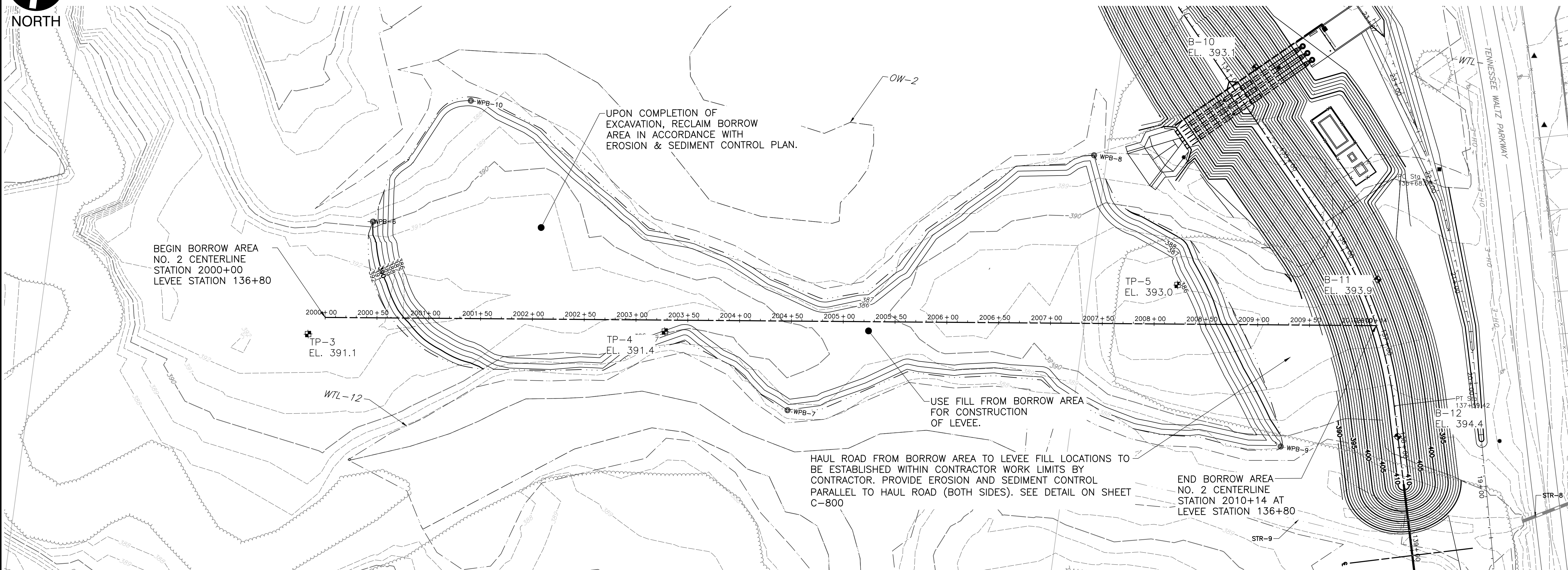

UPON COMPLETION OF EXCAVATION, RECLAIM BORROW AREA IN ACCORDANCE WITH EROSION & SEDIMENT CONTROL PLAN.

USE FILL FROM BORROW AREA FOR CONSTRUCTION OF LEVEE.

HAUL ROAD FROM BORROW AREA TO LEVEE FILL LOCATIONS TO BE ESTABLISHED WITHIN CONTRACTOR WORK LIMITS BY CONTRACTOR. PROVIDE EROSION AND SEDIMENT CONTROL PARALLEL TO HAUL ROAD (BOTH SIDES). SEE DETAIL ON SHEET C-800

END BORROW AREA NO. 2 CENTERLINE STATION 2010+14 AT LEVEE STATION 136+80

BEGIN BORROW AREA NO. 2 CENTERLINE STATION 2000+00 LEVEE STATION 136+80

**ON-SITE BORROW AREA NO. 2 - PLAN**

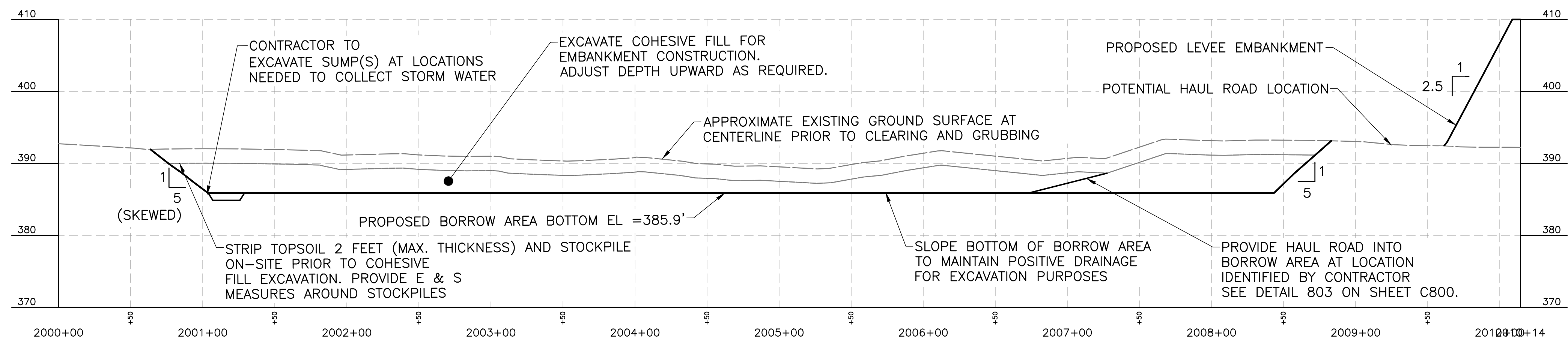
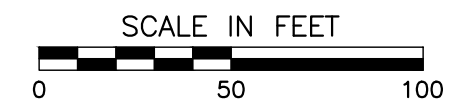

CONTRACTOR TO EXCAVATE SUMP(S) AT LOCATIONS NEEDED TO COLLECT STORM WATER

EXCAVATE COHESIVE FILL FOR EMBANKMENT CONSTRUCTION. ADJUST DEPTH UPWARD AS REQUIRED.

PROPOSED LEVEE EMBANKMENT

POTENTIAL HAUL ROAD LOCATION

APPROXIMATE EXISTING GROUND SURFACE AT CENTERLINE PRIOR TO CLEARING AND GRUBBING

STRIP TOPSOIL 2 FEET (MAX. THICKNESS) AND STOCKPILE ON-SITE PRIOR TO COHESIVE FILL EXCAVATION. PROVIDE E & S MEASURES AROUND STOCKPILES

SLOPE BOTTOM OF BORROW AREA TO MAINTAIN POSITIVE DRAINAGE FOR EXCAVATION PURPOSES

PROVIDE HAUL ROAD INTO BORROW AREA AT LOCATION IDENTIFIED BY CONTRACTOR SEE DETAIL 803 ON SHEET C800.

**BORROW AREA NO. 2 PROFILE**

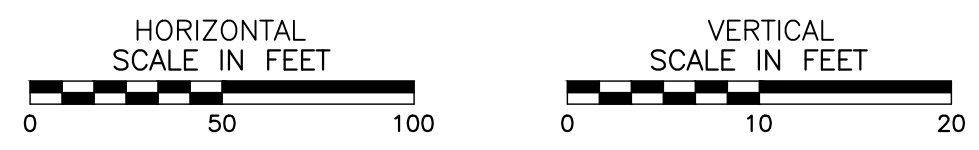

NOTES:  
1. SEE NOTES ON SHEET C-115.



Know what's below. Call before you dig.

**NOTE TO CONTRACTOR:**  
THE CONTRACTOR SHALL REFER TO ALL PLANS WITHIN THIS PLAN SET. IT IS NOT THE ENGINEER'S INTENT THAT ANY SINGLE PLAN SHEET IN THIS SET OF DOCUMENTS FULLY DEPICT ALL WORK ASSOCIATED WITH THIS PROJECT.

ISSUED FOR CONSTRUCTION



NO.	DATE	BY	DESCRIPTION

**C&E**  
**Civil & Environmental Consultants, Inc.**  
 117 Seaboard Lane · Suite E-100 · Franklin, TN 37067  
 615-333-7797 · 800-769-2326  
 www.ceinc.com

**A.O. SMITH  
 FLOOD CONTROL PROJECT  
 500 TENNESSEE WALTZ PARKWAY  
 ASHLAND CITY  
 CHEATHAM COUNTY, TN**

<b>ON-SITE BORROW AREA NO. 2</b>	
DATE: SEPTEMBER 2020	DRAWN BY: AAS
DWG. SCALE: AS SHOWN	CHECKED BY: JBS
PROJECT NO: 154-203	APPROVED BY: PJS/JJC

DRAWING NO.: **C-117**  
 SHEET OF

P:\2015\154-203\154-203.dwg (DWG) 154203-001-C-115.dwg - 1171 LS(10/20/2020 - 8:00am) - LF: 10/22/2020 7:30 PM

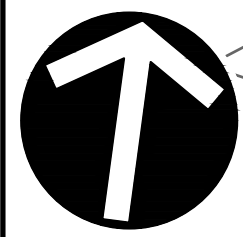

NORTH

AREA OF POND = 6.0 ACRES  
ESTIMATED WATER LEVEL = 386

IN CONJUNCTION WITH RECLAMATION, CONSTRUCT OVERFLOW SPILLWAY AT LOCATION SHOWN. ESTABLISH CONTROL SECTION AT ELEVATION 390 FT. SEE DETAIL ON SHEET C-807.

UPON COMPLETION OF EXCAVATION, RECLAIM BORROW AREA IN ACCORDANCE WITH EROSION & SEDIMENT CONTROL PLAN. ALLOW BORROW AREA TO REWATER TO ELEVATION 386.0

END BORROW AREA NO. 3  
CENTERLINE STATION 3014+92  
AT LEVEE STATION 142+50

BEGIN BORROW AREA NO. 2 AT  
CENTERLINE STATION 3000+00  
AT LEVEE STATION 142+50

IN CONJUNCTION WITH RECLAMATION,  
CONSTRUCT OVERFLOW SPILLWAY AT  
LOCATION SHOWN, ESTABLISH  
CONSTRLO SECTION AT ELEVATION  
388 FT. SEE DETAIL ON SHEET  
C-807

HAUL ROAD FROM BORROW AREA TO LEVEE FILL LOCATIONS TO  
BE ESTABLISHED WITHIN CONTRACTOR WORK LIMITS BY  
CONTRACTOR. PROVIDE EROSION AND SEDIMENT CONTROL  
PARALLEL TO HAUL ROAD (BOTH SIDES). SEE DETAIL ON SHEET  
C-800

USE FILL FROM BORROW AREA  
FOR CONSTRUCTION  
OF LEVEE.

**ON-SITE BORROW AREA NO. 3 - PLAN**

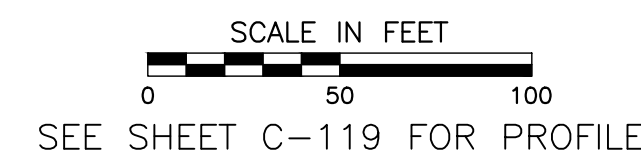

NOTES:  
1. SEE NOTES ON SHEET C-115.



Know what's below.  
Call before you dig.

**NOTE TO CONTRACTOR:**

THE CONTRACTOR SHALL REFER TO ALL PLANS WITHIN THIS PLAN SET. IT IS NOT THE ENGINEER'S INTENT THAT ANY SINGLE PLAN SHEET IN THIS SET OF DOCUMENTS FULLY DEPICT ALL WORK ASSOCIATED WITH THIS PROJECT.

ISSUED FOR  
CONSTRUCTION

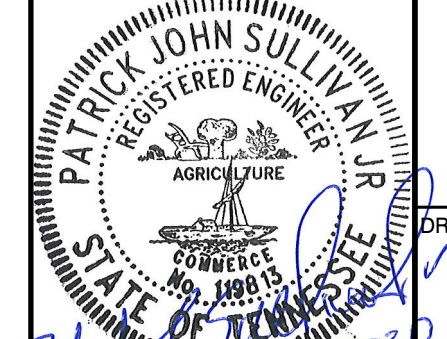

ON-SITE BORROW AREA NO. 3

**A.O. SMITH  
FLOOD CONTROL PROJECT  
500 TENNESSEE WALTZ PARKWAY  
ASHLAND CITY  
CHEATHAM COUNTY, TN**

**C&E**  
**Civil & Environmental Consultants, Inc.**  
117 Seaboard Lane · Suite E-100 · Franklin, TN 37067  
615-333-7797 · 800-763-2326  
www.ceinc.com

REVISION RECORD

NO.	DATE	DESCRIPTION
1	09/20/20	CONSTRUCTION

DRAWING NO.:  
**C-118**  
SHEET OF

P:\2015\154-201 - C&E\DWG\C118\154201-C-118.dwg - C-118.dwg - 10/2/2020 7:37 PM