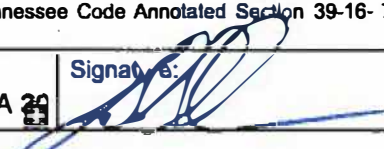

**TENNESSEE DEPARTMENT OF ENVIRONMENT AND CONSERVATION**

Division of Water Resources

William R. Snodgrass Tennessee Tower, 312 Rosa L. Parks Avenue, 11th Floor, Nashville, Tennessee 37243
1-888-891-8332 (TDEC)**Notice of Intent (NOI) for General NPDES Permit for Stormwater Discharges from Construction Activities (TNR100000)**

Site or Project Name: 2 Dell Parkway		NPDES Tracking Number: TNR	
Street Address or Location: 2 Dell Pkwy		Construction Start Date: 10/1/2021	
		Estimated End Date: 12/1/2022	
Site Description: Demolition of a portion of existing parking lot to construct warehouse		Latitude (dd.dddd): 36.1075	
		Longitude (-dd.dddd): -86.6779	
County(ies): Davidson		MS4 (if applicable): Nashville (TNS068047)	Acres Disturbed: 11.8
Check box if a SWPPP is attached: <input checked="" type="checkbox"/>		Check box if a site location map is attached: <input checked="" type="checkbox"/>	Total Acres: 11.8
Check the appropriate box(s) if there are streams and/or wetlands on or adjacent to the construction site: Streams <input type="checkbox"/> Wetlands <input type="checkbox"/>			
Has a jurisdictional determination been made by the USACE or EPA identifying waters of the United States?: Yes <input type="checkbox"/> No <input checked="" type="checkbox"/> Note: if yes, attach the jurisdictional determination			
If an Aquatic Resource Alteration Permit (ARAP) has been obtained for this site, what is the permit number? NR(S)			
Receiving waters: Misc Tributary to Mill Creek			
Site Owner/Developer (Primary Permittee): (Provide person, company, or entity that has operational or design control over construction plans and specifications): 2 Dell Way, LLC - Justin Sacco			
For corporate entities only, provide correct Tennessee Secretary of State (SOS) Control Number: (an incorrect SOS control number may delay NOI processing) 001172872			
Site Owner or Developer Contact Name: (signs the certification below) Justin Sacco		Title or Position: Vice President, Portfolio Asset Manager	
Mailing Address: 807 East Main Street, Suite 2-123		City: Durham	State: NC Zip: 27701
Phone: (919) 8847646	Fax: ()	E-mail: justin@lrcprop.com	
Optional Contact:		Title or Position:	
Mailing Address:		City:	State: Zip:
Phone: ()	Fax: ()	E-mail:	
Owner/Developer(s) Certification: (must be signed by president, vice-president or equivalent, or ranking elected official) (Primary Permittee)			
I certify under penalty of law that this document and all attachments were prepared by me, or under my direction or supervision. The submitted information is to the best of my knowledge and belief, true, accurate, and complete. I am aware that there are significant penalties for submitting false information, including the possibility of fine and imprisonment. As specified in Tennessee Code Annotated Section 39-16-702(a)(4), this declaration is made under penalty of perjury.			
Owner/Developer Name (print/type): Justin Sacco		Signature: 	Date:
Owner/Developer Name (print/type):		Signature:	Date:
Contractor Certification: (must be signed by president, vice-president or equivalent, or ranking elected official) (Secondary Permittee)			
I certify under penalty of law that I have reviewed this document, any attachments, and the SWPPP referenced above. Based on my inquiry of the construction site owner/developer identified above and/or my inquiry of the person directly responsible for assembling this NOI and SWPPP, I believe the information submitted is accurate. I am aware that this NOI, if approved, makes the above-described construction activity subject to NPDES permit number TNR100000, and that certain of my activities on-site are thereby regulated. I am aware that there are significant penalties, including the possibility of fine and imprisonment for knowing violations, and for failure to comply with these permit requirements. As specified in Tennessee Code Annotated Section 39-16-702(a)(4), this declaration is made under penalty of perjury.			
Contractor name, address, and SOS control number (if applicable): ARCO Design/Build - 380 Interstate N Pkwy #210, Atlanta, GA 30308		Signature: 	Date: 08/16/2021
OFFICIAL STATE USE ONLY			
Received Date: 8.23.21	Reviewer:	Field Office:	Permit Tracking Number: TNR 245368
Fee(s):	T & E Aquatic Flora/Fauna:	SOS Corporate Status:	Waters with Unavailable Parameters:
Notice of Coverage Date:			

STORMWATER POLLUTION PREVENTION PLAN

FOR:
2 DELL PARKWAY
NASHVILLE,
DAVIDSON COUNTY, TENNESSEE

PREPARED FOR:
ARCO DESIGN/BUILD

AUGUST 19, 2021

J-29470.0000

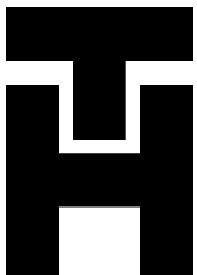

Prepared by:

THOMAS & HUTTON

Savannah, GA | Charleston, SC | Myrtle Beach, SC | Brunswick, GA | Columbia, SC
| Charlotte, NC | Greenville, SC | Nashville, TN

TABLE OF CONTENTS

1.0 Site Description.....	Page 1
2.0 Stormwater Runoff Controls.....	Page 3
3.0 Maintenance	Page 6
4.0 Inspections	Page 7
5.0 Non-Stormwater Discharges.....	Page 8
6.0 Signatures and Certifications	Page 9
7.0 Notice of Termination	Page 11

APPENDICES:

Erosion & Sediment Control Plan and Details	Appendix A
Paving, Grading, & Drainage Plan	Appendix B
Location and Site Map	Appendix C
Notice of Coverage	Appendix D
Construction Storm Water Inspection Certification	Appendix E
Notice of Termination	Appendix F

1.0 Site Description

The site is located at 2 Dell Parkway, Nashville, TN 37217. The site is identified on Davidson County Tax Map 120, Parcel 159. The site is approximately 32.2 acres, of which 11.80 acres will be disturbed to construct the new improvements, which include a 120,000 s.f. warehouse building and the addition of landscaped areas, stormwater best management practices, employee parking lots, and an access driveway. The site is presently a parking lot and consists of mainly asphalt pavement with associated landscape islands and grassy areas. Runoff currently drains to existing drainage inlets on-site and ultimately to a regional detention pond south of the proposed development. Runoff from the proposed site will be treated using stormwater BMPs and drain to the existing drainage system, which eventually drains to a tributary to Mill Creek.

1.1 Nature of Construction Activity

As is typical for construction of any project of this magnitude; there are several types of construction. In order to accomplish the construction of the facility, the following types of construction will occur:

- Site grading;
- Rock excavation;
- Water, sewer, gas, electric, and storm sewer installation;
- Paving; and
- Building construction.

1.2 Construction Sequence

The first element of construction is to attend a Metro Water Services – Stormwater Division – Pre-Construction Meeting. Then, install construction entrances, which are necessary for the vehicles to access the site. This will ensure that tracking of vehicle debris will not occur.

The second element of construction will be the installation of silt fence and construction fence. After installation of the previously mentioned devices, Metro Water Services – Stormwater Division will be contacted to perform an inspection of all erosion control devices in order to obtain a grading permit.

Once the grading permit has been obtained and these devices have been installed, clearing, grubbing, excavation, and general mass grading can begin. The remaining site will be constructed according to Nashville-Metro approved plans, including all additional erosion control devices.

Upon permanent site stabilization, silt fence and all other temporary erosion control devices will be removed. These procedures are discussed and shown on the Sediment & Erosion Control Plans (C3.1-C3.7), which are included in Appendix A.

The intent of the Storm Water Pollution Prevention Plan is to minimize the disturbance to the site and the surrounding areas. All construction shall be in accordance with the storm water runoff controls presented in section 2 of this Plan.

1.3 Area of Disturbance

The project site consists of approximately 32.2 acres, of which 11.80 will be disturbed to construct new improvements. The attached Erosion Control Plans details these activities and are included in Appendix A.

1.4 Site Soils

According to the NRCS Soils Map, soil present on the site includes hydrologic soil group B, consisting of MaB (Maury Silt Loam, 2 to 7 percent slopes) and McB (Maury-Urban Land Complex, 2 to 7 percent slopes. The property is located in Zone X (area of minimal flood hazard) per FEMA Flood Insurance Rate Map Panel No. 47037C0356F for Davidson County, Tennessee.

1.5 Curve Numbers

The site is presently developed, and current site cover consists primarily of a parking lot, with surface cover mainly of asphalt pavement and some associated landscape islands and grassy areas. The calculated composite curve number for the existing condition is 88. Upon completion of the site, the estimated composite curve number will be 82.

1.6 Location and Site Map

A copy of the location and site map is included as Appendix C at the back of this Plan.

1.7 Outfall Points

Stormwater runoff will be treated with two Level 1 Bioretention Areas and one Level 2 Water Quality Swale per the Nashville LID manual. After treatment, storm water is discharged into an existing 24" RCP pipe near Level 1 Bioretention Area #1. The existing drainage system flows to the southeast and ultimately discharges to a tributary of Mill Creek.

1.8 Industrial Activities

There are currently no industrial activities taking place at this site. In addition, there are no industrial activities planned for the facility.

1.9 Receiving Stream and Wetlands

Runoff from the site will be treated and drain to an existing 24" RCP pipe. The existing drainage system flows to the southeast and ultimately discharged to a tributary of Mill Creek.

1.10 Buffer Zones

There are not buffer zones on site.

1.11 On Site Waste

No on-site waste disposal or sewer septic systems are planned for the site.

2.0 Storm Water Runoff Controls

2.1 Erosion and Sediment Controls

2.1.1 General Criteria and Requirements

- The erosion prevention and sediment controls have been designed to control the rainfall and runoff from a 2-year, 24-hour storm.
- The construction-phase erosion and sediment controls shall be designed to minimize the dislodging and suspension of soil in water. Sediment controls shall be designed to retain mobilized sediment on site.
- All control measures must be properly selected, installed, and maintained in accordance with the manufacturer's specifications and good engineering practices. All control measures selected must be able to slow runoff so that rill and gully formation is prevented. When steep slopes and/or fine particle soils are present at the site, additional physical or chemical treatment of storm water runoff may be required, and must be fully described. If periodic inspections or other information indicates a control has been used inappropriately, or incorrectly, the permittee must replace or modify the control for relevant site situation.
- If permanent or temporary vegetation is to be used as a control measure, then the timing of the planting of the vegetation cover must be discussed in the SWPPP. Delay in planting cover vegetation cover until winter months or dry months should be avoided, if possible.
- If sediment escapes the construction site, off-site accumulations of sediment **that have not** reached a stream must be removed at a frequency sufficient to minimize offsite impacts (e.g., fugitive sediment that has escaped the construction site and has collected in a street must be removed so that it is not subsequently washed into storm sewers and streams by the next rain and/or so that it does not pose a safety hazard to users of public streets.) The permittees shall not initiate remediation/restoration of a stream without consulting the Division of Water Pollution Control first. This permit does not authorize access to private property. Arrangements concerning removal of sediment on adjoining property must be settled by the permittees with the adjoining property landowner.
- Sediment should be removed from sediment traps, silt fences, sedimentation ponds, and other sediment controls as necessary, and must be removed when design capacity has been reduced by 50%.
- Litter, construction debris, and construction chemicals exposed to storm water shall be picked up prior to anticipated storm events (e.g. forecasted by local weather reports), or otherwise prevented from becoming a pollutant source for storm water discharges (e.g., screening outfalls, daily pick-up, etc.). After use, materials used for erosion prevention and sediment control should be removed or otherwise prevented from becoming a pollutant source for storm water discharges.
- Offsite erodible material storage and/or borrow areas (also including overburden and stockpiles of dirt, etc.) used primarily by the permitted project are considered a part of the project and shall be addressed in the SWPPP and included in the fee calculation.

- Pre-construction vegetative ground cover shall not be destroyed, removed, or disturbed more than 10 calendar days prior to grading or earth moving unless the area is seeded and/or mulched or other temporary cover is installed.
- Clearing and grubbing must be held to the minimum necessary for grading and equipment operation.
- Construction must be phased for projects in which over 50 acres of soil will be disturbed. Areas of the completed phase must be stabilized within 15 days (refer to Stabilization practices below). No more than 50 acres of active soil disturbance is allowed at any time during the construction project.
- Erosion prevention and sediment control measures must be in place and functional before earth moving operations begin, and must be constructed and maintained throughout the construction period. Temporary measures may be removed at the beginning of the workday, but must be replaced at the end of the workday.
- The following records must be kept on site: the dates when major grading activities occur; the dates when construction activities temporarily or permanently cease on a portion of the site; and the dates when stabilization measures are initiated, inspection records, and rainfall records.
- Permittees shall maintain a rain gauge and daily rainfall records at the site, or use a reference site for a record of daily amount of precipitation.

2.1.2 Stabilization Practices

The SWPPP shall include a description of interim and permanent stabilization practices, including site-specific scheduling of the implementation of the practices. Site plans should ensure that existing vegetation is preserved where attainable and that disturbed portions of the site are stabilized. Site plans should comply with buffer zone requirements, if applicable, in which construction activities, borrow and/or fill are prohibited. Stabilization practices may include temporary seeding, permanent seeding, mulching, geotextiles, sod stabilization, vegetative buffer strips, protection of trees, preservation of mature vegetation, and other appropriate measures. Use of impervious surfaces for final stabilization in lieu of a permanent vegetative cover should be avoided where practicable. No stabilization, erosion control or sediment treatment measures are to be installed in a stream without obtaining an Aquatic Resource Alteration Permit (ARAP).

Stabilization measures shall be initiated as soon as possible in portions of the site where construction activities have temporarily or permanently ceased. Temporary or permanent soil stabilization at the construction site (or a phase of the project) must be completed not later than 15 days after the construction activity in that portion of the site has temporarily or permanently ceased. In the following, situations, temporary stabilization measures are not required:

- Where the initiation of stabilization measures is precluded by snow cover or frozen ground conditions or adverse soggy ground conditions, stabilization measures shall be initiated as soon as practicable; or

- Where construction activity on a portion of the site is temporarily ceased, and earth disturbing activities will be resumed within 15 days.

Permanent stabilization with perennial vegetative (using native herbaceous and woody plants where practicable) or other permanently stable, non-eroding surface shall replace any temporary measures as soon as practicable. Unpacked gravel containing fines (silt and clay sized particles) or crusher runs will be considered a non-eroding surface.

2.1.3 Structural Practices

The attached drawings depict several structural practices to divert flows from exposed soils, store flows or otherwise limit runoff and the discharge of pollutants from exposed areas of the site. Such practices include, but are not limited to the following:

- Silt fences;
- Earth dikes;
- Drainage swales;
- Check dams;
- Subsurface drains;
- Pipe slope drains;
- Level spreaders;
- Rock outlet protection;
- Reinforced soil retaining systems;
- Storm drainage inlet protection;
- Diversion ditch; and

Muddy water to be pumped from excavation and work areas must be held in settling basins, filtered, or chemically treated prior to its discharge into surface waters. Water must be discharged through a pipe, well-grassed or lined channel or other equivalent means so that the discharge does not cause erosion and sedimentation. Discharge water must not cause an objectionable color contrast with the receiving stream.

2.2 Storm Water Management

This portion of the Plan addresses measures that are installed during the construction process to control pollutants in storm water discharges that will occur after construction operations have been completed.

The general permit only addresses the installation of storm water management measures, and not the ultimate operation and maintenance of such structures after the construction activities have been completed, the site has undergone final stabilization, and the permit coverage has been terminated. Permittees are only responsible for the installation and maintenance of the storm water management measures prior to final stabilization of the site and are not responsible for maintenance after storm water discharges associated with construction activity have been eliminated from the site. All permittees are encouraged to limit the amount of post construction runoff, if not required by local building regulations, in order to minimize in-stream channel erosion in the receiving stream.

The planned storm water management measures for the project include the final stabilization of graded areas. All graded areas shall receive erosion control fabric for those slopes specified on the drawings and all disturbed areas are to receive seeding and straw mulch in accordance with the landscaping drawings and specifications.

Any portions of the property that are sold prior to completion of construction will be required by the owner/developer to provide a separate sediment and erosion control plan for those portions to be sold. These plans shall be integrated into the overall sediment and erosion control site plan. In addition, the contractor will ensure that measures will be implemented which prevent the "taking" of legally protected state or federal listed threatened or endangered aquatic fauna.

2.3 Other Items Needing Control

Construction and waste materials that are expected to be stored on site include those typically found at a building construction site. These may include:

- Lumber for forming and construction;
- Stockpiled piping and catch basins;
- Stockpiled rock and gravel;
- Structural steel and reinforcing bars;
- Building materials, such as studs, roof trusses, wiring, conduits, mortar, rock for veneer, shingles, sand, etc.; and
- Construction equipment and vehicles.

All materials shall be stored in such a manner that the materials containing potential pollutants (e.g. machine oils) cannot come in contact with rainwater. No solid materials, including building materials, shall be placed in waters of the state, except as authorized by a section 404 permit and/or an Aquatic Resource Alteration Permit.

Off-site vehicle tracking of sediments and the generation of dust shall be minimized.

2.4 Approved Local Government Sediment and Erosion Control Requirements

The Grading and Drainage Plan, will be submitted, reviewed and approved by the Nashville Metro – Stormwater Division and is included as part of this Plan as Appendix B. All sediment and erosion control measures must be maintained throughout the life of the project. The site is subject to inspection by said Department at any time. The grading permit issued by said Department must be displayed at the project trailer.

This Plan may be amended to reflect any change that is instituted by the local government to sediment and erosion site plans or site permits, or storm water management site plans or site permits for which the owner (or any of its agents) receives written notice.

3.0 Maintenance

The authorized contractor, as the site Operator, is responsible for ensuring that all vegetation, erosion, and sediment control measures, buffer zones, and other protective measures identified in the site plan are kept in good and effective operating condition. Maintenance needs identified by inspections or other means shall be accomplished before the next storm event, but in no case more than seven days after the need is identified.

4.0 Inspections

4.1 Inspector Training and Certification

Inspectors must have successfully completed the "Fundamentals of Erosion Prevention and Sediment Control" course, or an equivalent course, for individuals involved in land-disturbing activities, which provides a working knowledge of erosion prevention and sediment controls. This requirement goes in effect 24 months following the new permit effective date (June 17, 2005). A copy of the certification or training record for inspector certification should be kept on site.

4.2 Schedule of Inspections

- a) Inspections described in paragraphs c, d and e listed below, shall be performed at least twice every calendar week. Inspections shall be performed at least 72 hours apart. Where sites or portion(s) of construction sites have been temporarily stabilized, or runoff is unlikely due to winter conditions (e.g., site covered with snow or ice), such inspection only has to be conducted once per month until thawing results in runoff or construction activity resumes. Inspections requirements do not apply to definable areas that have been finally stabilized. Written notification of the intent to conduct only monthly inspections and the justification for such request must be submitted to the local Environmental Field Office, or the division's Nashville Central Office for projects of the Tennessee Department of Transportation (TDOT) and the Tennessee Valley Authority (TVA).
- b) Qualified personnel (provided by the permittee or cooperatively by multiple permittees) shall inspect disturbed areas of the construction site that have not been finally stabilized, areas used for storage of materials that are exposed to precipitation, structural control measures, locations where vehicles enter or exit the site, and each outfall.
- c) Disturbed areas and areas used for storage of materials that are exposed to precipitation shall be inspected for evidence of, or the potential for, pollutants entering the drainage system. Erosion prevention and sediment control measures identified in the SWPPP shall be observed to ensure that they are operating correctly.
- d) Outfall points (where discharges leave the site or enter water of the state) shall be inspected to determine whether erosion prevention and sediment control measures are effective in preventing significant impacts to receiving water. Where discharge location are inaccessible, nearby downstream locations shall be impacted. Locations where vehicles enter or exit the site shall be inspected for evidence of offsite sediment tracking.
- e) Based on the results of the inspection, any inadequate control measures or control measures in disrepair shall be replaced or modified, or repaired as necessary, before the next rain event if possible, but in no case more than 7 days after the need is identified.
- f) Based on the results of the inspection, the site description identified in the SWPPP in accordance with this permit and pollution prevention measures identified in the SWPPP in accordance with this permit shall be revised as appropriate, but in no case later than 7 days following the inspection. Such modifications shall provide for timely implementation of any changes of the SWPPP, but in no case later than 14 days following the inspection.

- g) Inspections shall be documented and include the scope of the inspection, name(s) and title of personnel making the inspection, the date(s) of the inspection, major observations relating to the implementation of the storm water pollution prevention plan (including the location(s) of discharges of sediment or other pollutants from the site and of any control device that failed to operate as designed or proved inadequate for a particular location), and actions taken in accordance with the Inspections Section of this permit. Inspection documentation will be maintained on site and made available upon request. Inspection reports must be submitted to the division within 10 days of the request. Permittees not discharging into impaired or high quality waters may, but are not required to, use the inspection from provided in Appendix E.

5.0 Non-Storm Water Discharges

The following non-storm water discharges from active construction sites are authorized under the general permit and are anticipated during construction:

- Dewatering of work areas of collected storm water and ground water;
- Water used to wash vehicles (of dust and soil, not process materials such as oils, asphalt or concrete) where detergents are not used and detention and/or filtering is provided before the water leaves sites;
- Water use to control dust;
- Potable water sources including waterline flushings from which chlorine has been removed to the maximum extent practicable;
- Routine external building wash down which does not use detergents or other chemicals;
- Uncontaminated ground water or spring water; and
- Foundation or footing drains where flows are not contaminated with pollutants (process materials such as solvents, heavy metals, etc.).

All non-storm water discharges, not limited to those identified above shall be discharged through stable discharge structures. These would include the temporary sedimentation basins or the subsurface drainage system shown on the attached grading plan(s). All non-storm water discharges authorized by the General Permit must be free of sediment or other solids and must not cause erosion of soil or the stream bank, or result in sediment impacts to the receiving stream.

6.0 Signatures and Certifications

I certify under penalty of law that this document and all attachments were prepared under my direction or supervision in accordance with a system designed to assure that qualified personnel properly gathered and evaluated the information submitted. Based on my inquiry of the person or persons who manage the system, or those persons directly responsible for gathering the information, the information submitted is, to the best of my knowledge and belief, true, accurate, and complete. I am aware that there are significant penalties for submitting false information, including the possibility of fine and imprisonment for knowing violations.

<u>VP Portfolio Asset Mgr.</u>	<u></u>	<u>8/23/21</u>
Title	Signature	Date

I certify under penalty of law that I have reviewed this document, any attachments, and the SWPPP reference above. Based on my inquiry of the construction site owner/developer identified above and/or my inquiry of the person directly responsible for assembling this NOI and SWPPP, I believe the information submitted is accurate. I am aware that this NOI, if approved, makes the above-described construction activity subject to NPDES permit number TNR100000, and that my activities on-site are thereby regulated. I am aware that there are significant penalties, including the possibility of fines and imprisonment, for knowing violations and for failure to comply with these permit requirements.

Construction Manager:

<u>Project Manager</u>	<u></u>	<u>8/19/2021</u>
Title	Signature	Date

ADDITIONAL SUB-CONTRACTORS

Company: ARCO Design/Build

<u>Project Manager</u>	<u>Brian Warr</u>	<u>8/19/2021</u>
Title	Signature	Date

Company: _____

_____	_____	_____
Title	Signature	Date

Company: _____

_____	_____	_____
Title	Signature	Date

7.0 Notice of Termination - (Construction Site Operator)

Where a site has been finally stabilized and all storm water discharges from Construction activities that are authorized by this permit are eliminated, or where storm water discharges have otherwise been eliminated, or where the operator of all storm water discharges at a facility changes, the permittee must submit a signed Notice of Termination, which is included in Appendix F.

Appendix A Erosion & Sediment Control Plan and Details

2:10 PM 7/20/2020 ENGINEERING GRAPHICS CONSTRUCTION PLANS 2020-00-0-159.000 - C - INITIALS - 7/20/2020 - 5:58 PM

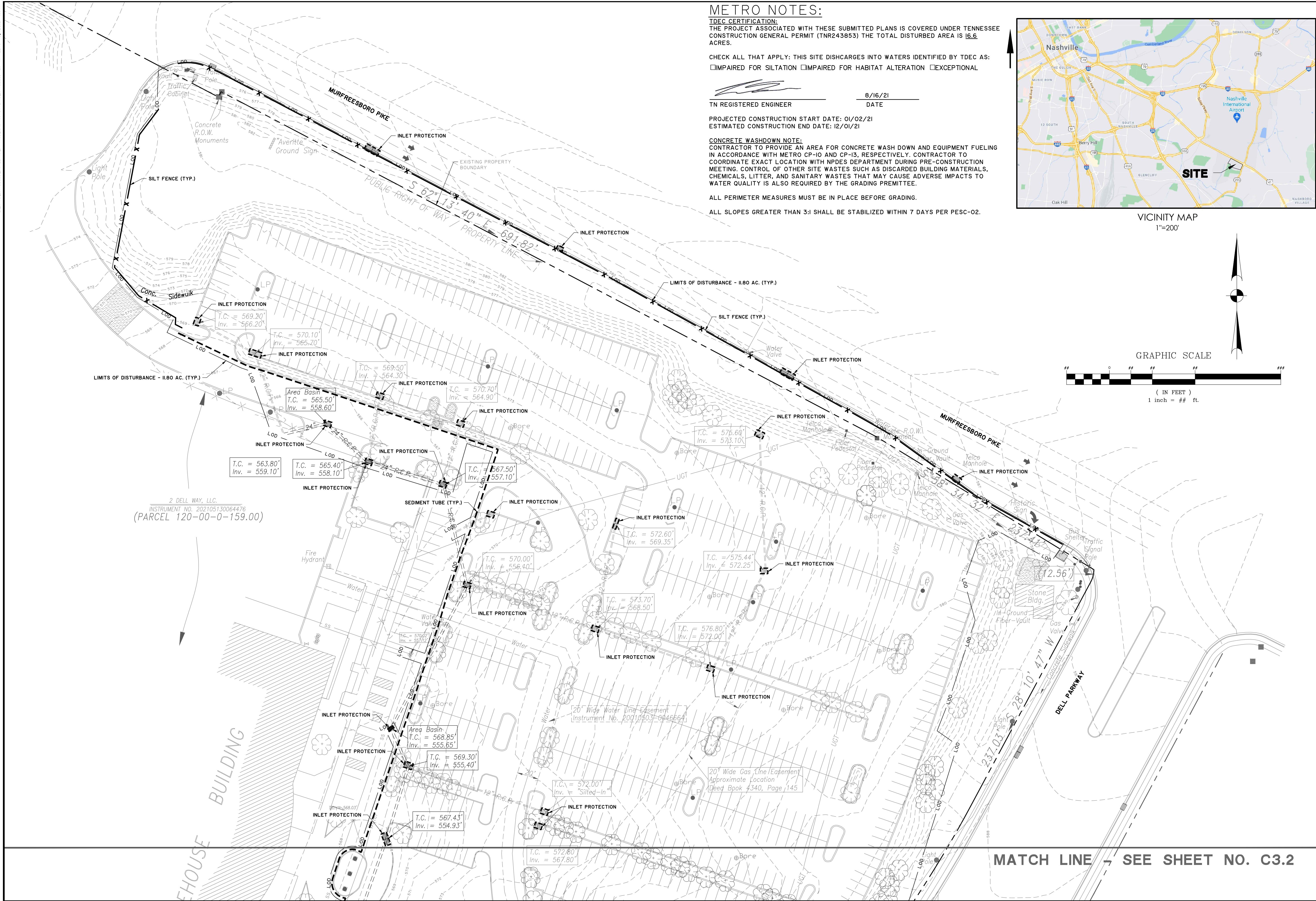

METRO NOTES:

TDEC CERTIFICATION:
THE PROJECT ASSOCIATED WITH THESE SUBMITTED PLANS IS COVERED UNDER TENNESSEE CONSTRUCTION GENERAL PERMIT (TNR243853) THE TOTAL DISTURBED AREA IS 16.6 ACRES.

CHECK ALL THAT APPLY: THIS SITE DISCHARGES INTO WATERS IDENTIFIED BY TDEC AS:

☐IMPAIRED FOR SILTATION ☐IMPAIRED FOR HABITAT ALTERATION ☐EXCEPTIONAL



TN REGISTERED ENGINEER

8/16/21

DATE

PROJECTED CONSTRUCTION START DATE: 01/02/21

ESTIMATED CONSTRUCTION END DATE: 12/01/21

CONCRETE WASHDOWN NOTE:
CONTRACTOR TO PROVIDE AN AREA FOR CONCRETE WASH DOWN AND EQUIPMENT FUELING IN ACCORDANCE WITH METRO CP-10 AND CP-13, RESPECTIVELY. CONTRACTOR TO COORDINATE EXACT LOCATION WITH NPDES DEPARTMENT DURING PRE-CONSTRUCTION MEETING. CONTROL OF OTHER SITE WASTES SUCH AS DISCARDED BUILDING MATERIALS, CHEMICALS, LITTER, AND SANITARY WASTES THAT MAY CAUSE ADVERSE IMPACTS TO WATER QUALITY IS ALSO REQUIRED BY THE GRADING PERMITTEE.

ALL PERIMETER MEASURES MUST BE IN PLACE BEFORE GRADING.

ALL SLOPES GREATER THAN 3:1 SHALL BE STABILIZED WITHIN 7 DAYS PER PES-C-02.

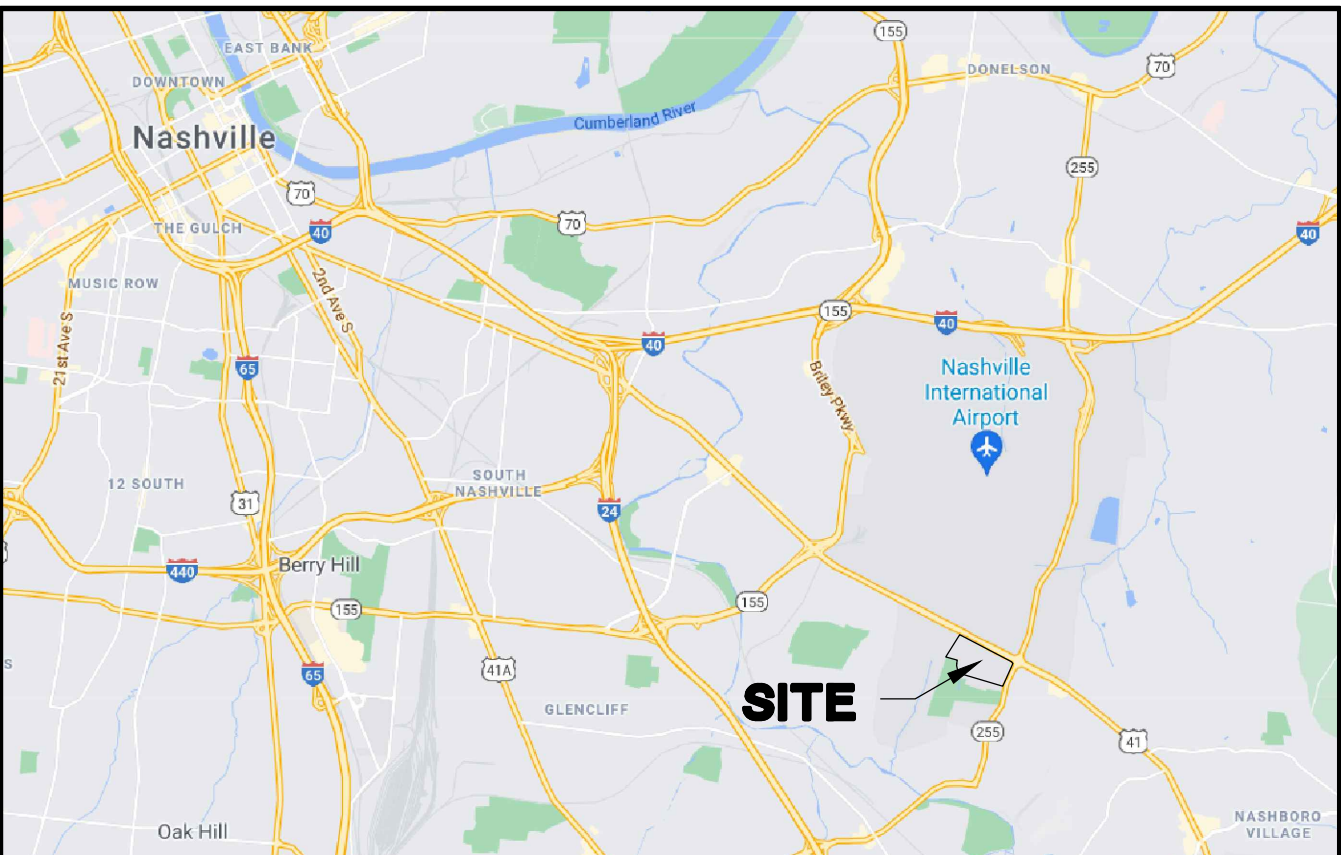

VICINITY MAP

1"=200'

GRAPHIC SCALE



(IN FEET)
1 inch = ## ft.



NO.	REVISIONS	BY	DATE

THOMAS & HUTTON

615 Main Street • Suite 124
Nashville, TN 37206 • 615.349.4990
www.thomasandhutton.com

ARCO DESIGN/BUILD
DAVIDSON COUNTY, TN

2 DELL PARKWAY

EROSION CONTROL - INITIAL

JOB NO: J-29470.0000
DATE: 8-17-21
DRAWN: CSH
DESIGNED: CSH
REVIEWED: CAG
APPROVED: CAG
SCALE: 1" = 40'

C3.1

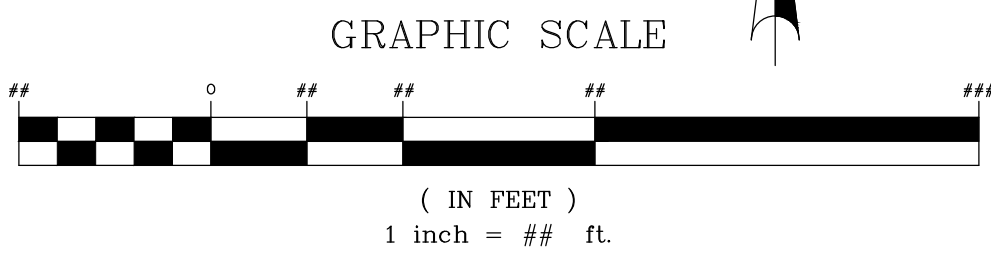

IDB C/O RHONDA PEDLEY
INSTRUMENT NO. 199912170304413
FILE 120-00-0-158.00)

ALL SLOPES GREATER THAN 3:1 SHALL BE STABILIZED WITHIN 7 DAYS PER PESC-02.

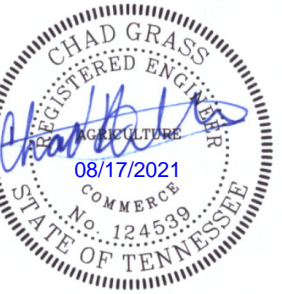
[illegible]

THOMAS & HUTTON
615 Main Street • Suite 124
Nashville, TN 37206 • 615.349.4990
www.thomasandhutton.com

ARCO DESIGN/BUILD

2 DELL PARKWAY

EROSION CONTROL - INITIAL

JOB NO:	J-29470.0000
DATE:	8-17-21
DRAWN:	CSH
DESIGNED:	CSH
REVIEWED:	CAG
APPROVED:	CAG
SCALE:	1" = 40'

C3.2

J:\29470\29470.DWG\29470.DWG\29470.DWG\29470.DWG - 08/17/2021 - 5:04 PM

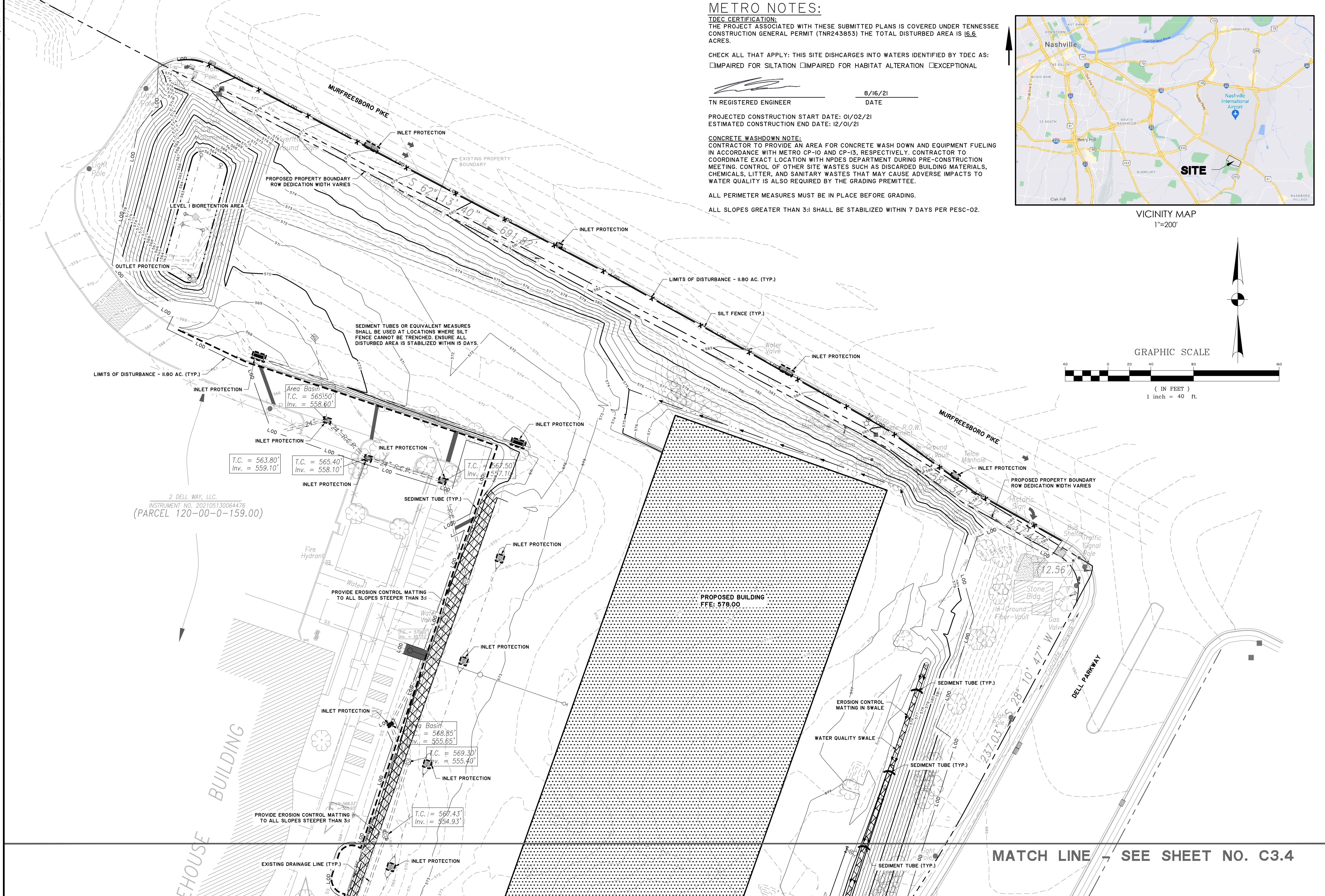

METRO NOTES:

TDEC CERTIFICATION:
THE PROJECT ASSOCIATED WITH THESE SUBMITTED PLANS IS COVERED UNDER TENNESSEE CONSTRUCTION GENERAL PERMIT (TNR243853) THE TOTAL DISTURBED AREA IS 16.6 ACRES.

CHECK ALL THAT APPLY: THIS SITE DISCHARGES INTO WATERS IDENTIFIED BY TDEC AS:
☐IMPAIRED FOR SILTATION ☐IMPAIRED FOR HABITAT ALTERATION ☐EXCEPTIONAL

TN REGISTERED ENGINEER
8/16/21
DATE

PROJECTED CONSTRUCTION START DATE: 01/02/21
ESTIMATED CONSTRUCTION END DATE: 12/01/21

CONCRETE WASHDOWN NOTE:
CONTRACTOR TO PROVIDE AN AREA FOR CONCRETE WASH DOWN AND EQUIPMENT FUELING IN ACCORDANCE WITH METRO CP-10 AND CP-13, RESPECTIVELY. CONTRACTOR TO COORDINATE EXACT LOCATION WITH NPDES DEPARTMENT DURING PRE-CONSTRUCTION MEETING. CONTROL OF OTHER SITE WASTES SUCH AS DISCARDED BUILDING MATERIALS, CHEMICALS, LITTER, AND SANITARY WASTES THAT MAY CAUSE ADVERSE IMPACTS TO WATER QUALITY IS ALSO REQUIRED BY THE GRADING PERMITTEE.

ALL PERIMETER MEASURES MUST BE IN PLACE BEFORE GRADING.
ALL SLOPES GREATER THAN 3:1 SHALL BE STABILIZED WITHIN 7 DAYS PER PESC-02.

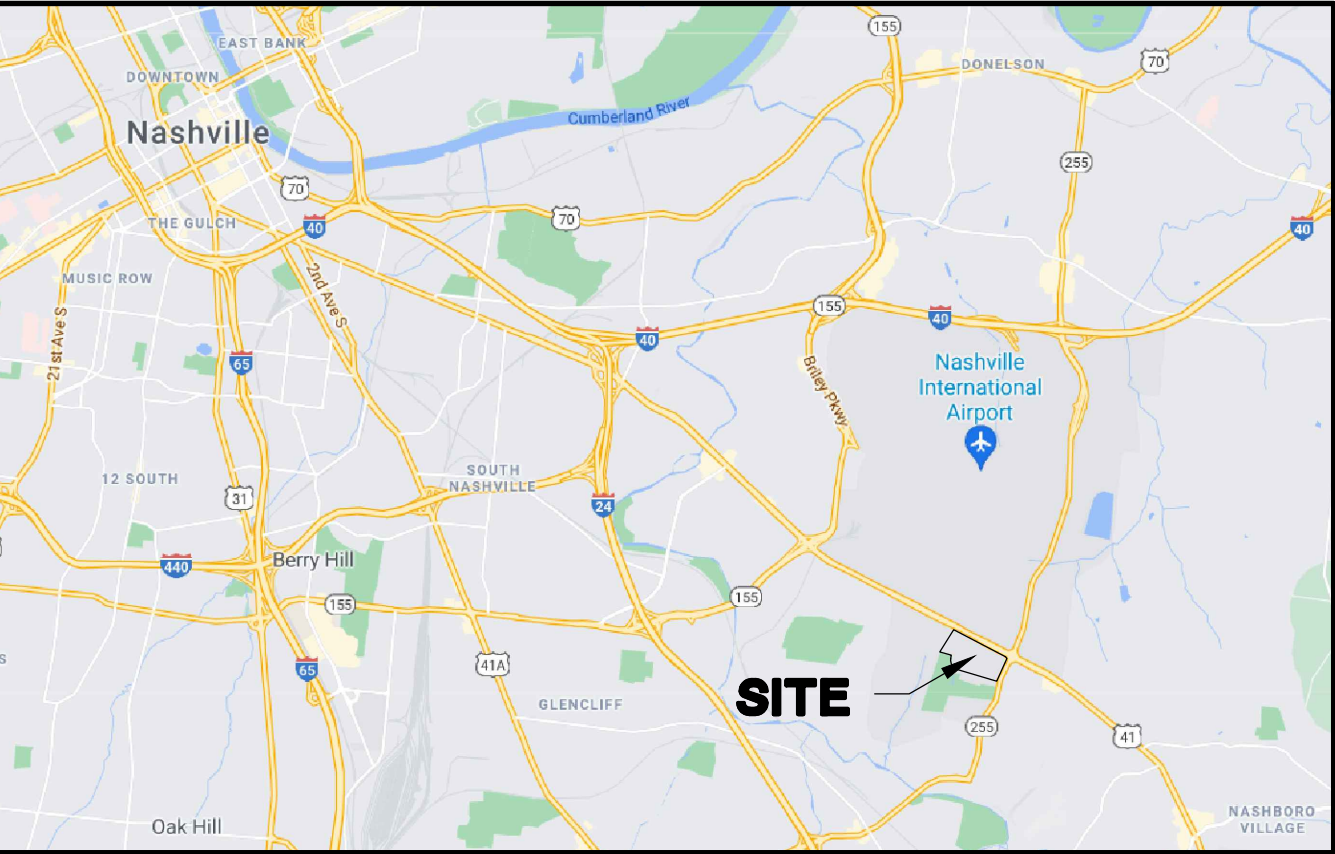

VICINITY MAP
1"=200'

GRAPHIC SCALE

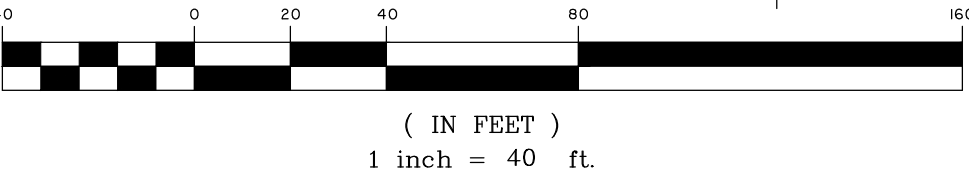

2 DELL WAY, LLC.
INSTRUMENT NO. 202105130064476
(PARCEL 120-00-0-159.00)



NO.	REVISIONS	BY	DATE

THOMAS & HUTTON
615 Main Street • Suite 124
Nashville, TN 37206 • 615.349.4990
www.thomasandhutton.com

ARCO DESIGN/BUILD
DAVIDSON COUNTY, TN
2 DELL PARKWAY
EROSION CONTROL - INTERMEDIATE

JOB NO: J-29470.0000
DATE: 8-17-21
DRAWN: CSH
DESIGNED: CSH
REVIEWED: CAG
APPROVED: CAG
SCALE: 1" = 40'

C3.3



Z:\19470\19470.DWG 20210513 09:00:00 1:1 1/8"=1' 8/17/2021 5:04 PM

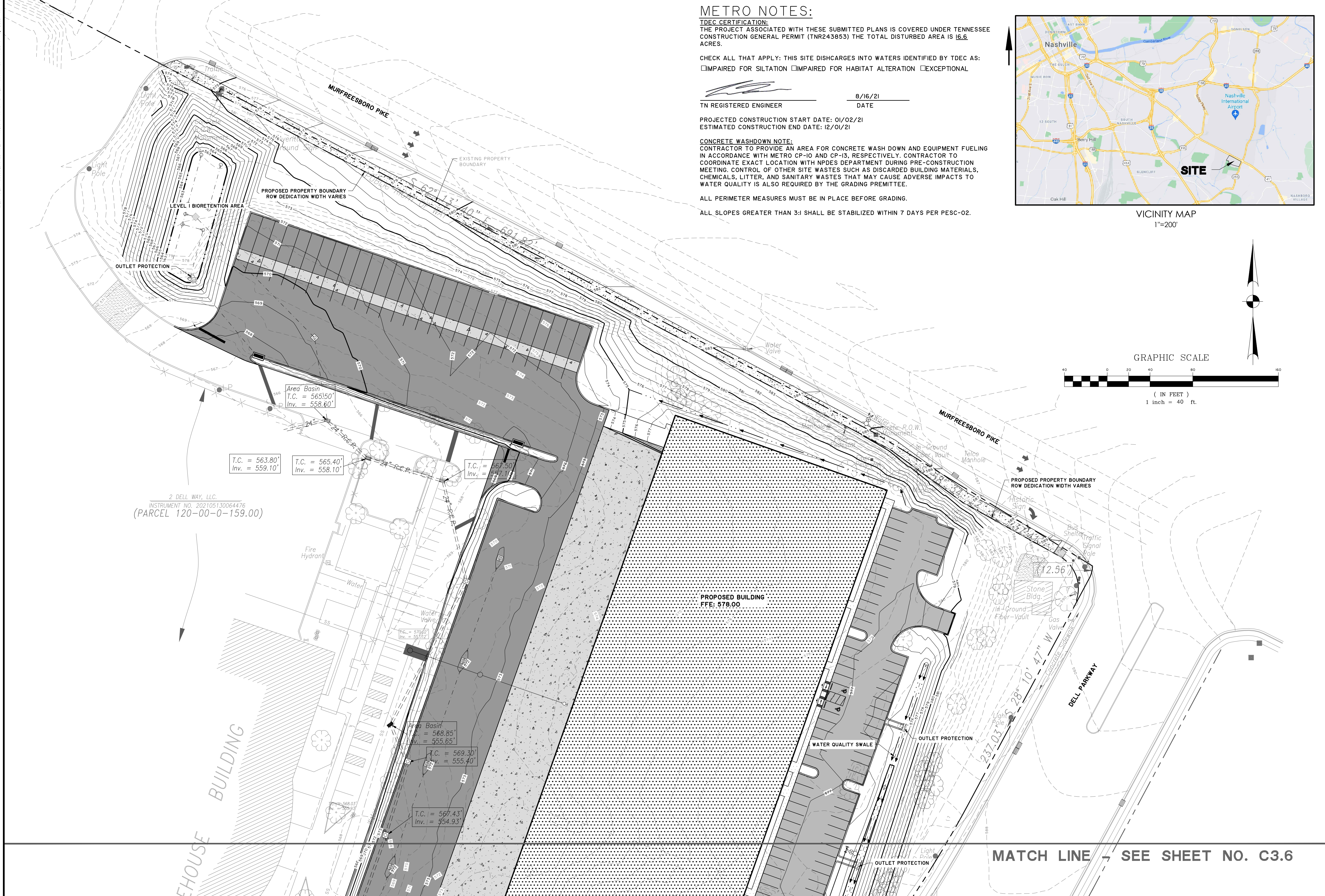

METRO NOTES:

TDEC CERTIFICATION:
THE PROJECT ASSOCIATED WITH THESE SUBMITTED PLANS IS COVERED UNDER TENNESSEE CONSTRUCTION GENERAL PERMIT (TNR243853) THE TOTAL DISTURBED AREA IS 16.6 ACRES.

CHECK ALL THAT APPLY: THIS SITE DISCHARGES INTO WATERS IDENTIFIED BY TDEC AS:
☐IMPAIRED FOR SILTATION ☐IMPAIRED FOR HABITAT ALTERATION ☐EXCEPTIONAL

 8/16/21
TN REGISTERED ENGINEER DATE

PROJECTED CONSTRUCTION START DATE: 01/02/21
ESTIMATED CONSTRUCTION END DATE: 12/01/21

CONCRETE WASHDOWN NOTE:
CONTRACTOR TO PROVIDE AN AREA FOR CONCRETE WASH DOWN AND EQUIPMENT FUELING IN ACCORDANCE WITH METRO CP-10 AND CP-13, RESPECTIVELY. CONTRACTOR TO COORDINATE EXACT LOCATION WITH NPDES DEPARTMENT DURING PRE-CONSTRUCTION MEETING. CONTROL OF OTHER SITE WASTES SUCH AS DISCARDED BUILDING MATERIALS, CHEMICALS, LITTER, AND SANITARY WASTES THAT MAY CAUSE ADVERSE IMPACTS TO WATER QUALITY IS ALSO REQUIRED BY THE GRADING PERMITTEE.

ALL PERIMETER MEASURES MUST BE IN PLACE BEFORE GRADING.

ALL SLOPES GREATER THAN 3:1 SHALL BE STABILIZED WITHIN 7 DAYS PER PESC-02.

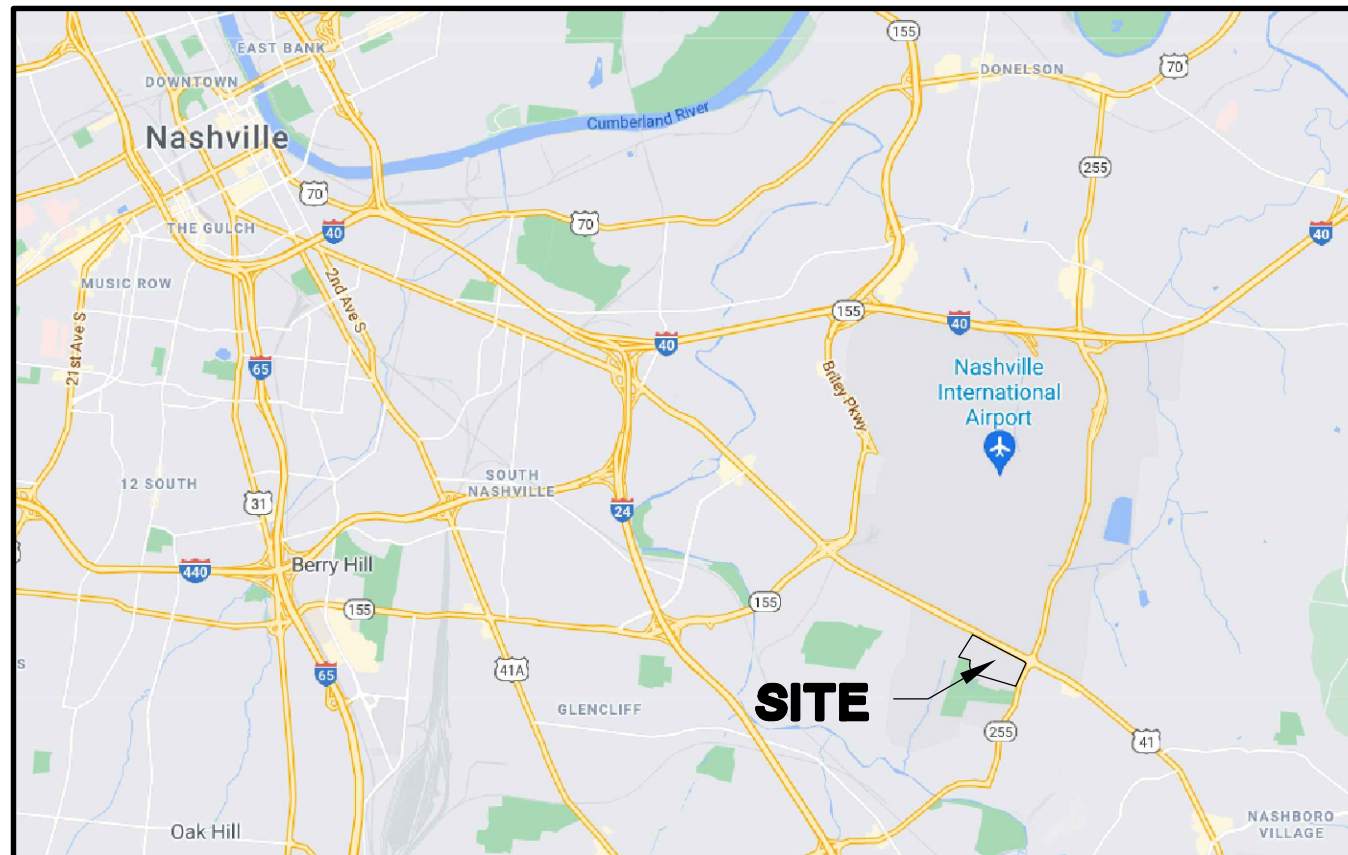

VICINITY MAP
1"=200'

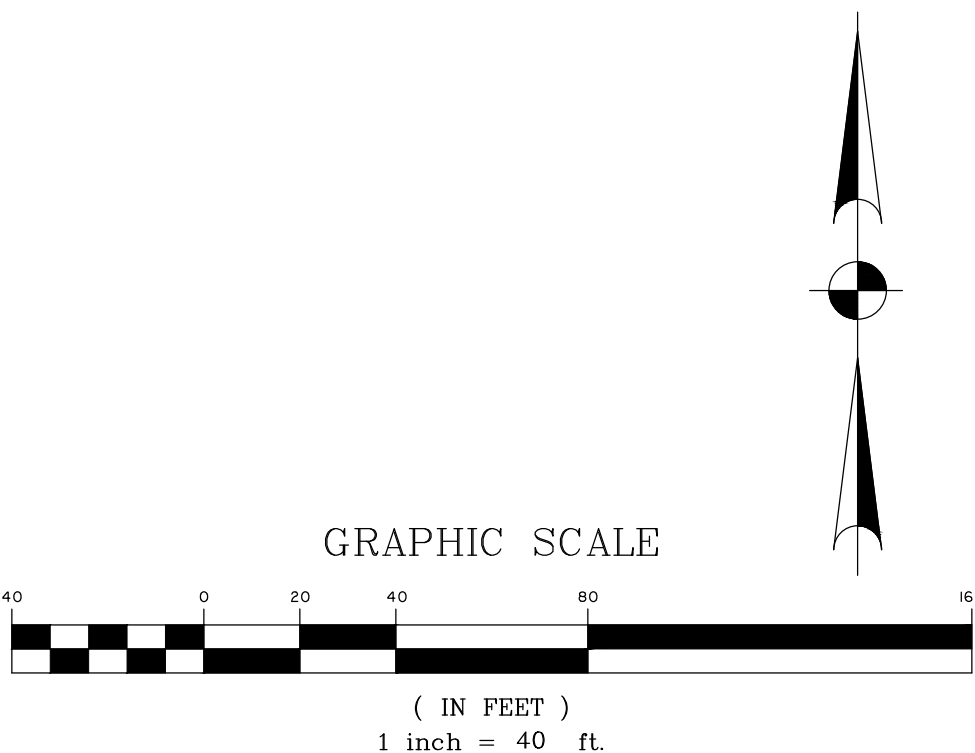

2 DELL WAY, LLC.
INSTRUMENT NO. 202105130064476
(PARCEL 120-00-0-159.00)



NO.	REVISIONS	BY	DATE

THOMAS & HUTTON
615 Main Street • Suite 124
Nashville, TN 37206 • 615.349.4990
www.thomasandhutton.com

ARCO DESIGN/BUILD
DAVIDSON COUNTY, TN
2 DELL PARKWAY
EROSION CONTROL - FINAL

JOB NO: J-29470.0000
DATE: 8-17-21
DRAWN: CSH
DESIGNED: CSH
REVIEWED: CAG
APPROVED: CAG
SCALE: 1" = 40'

C3.5

GRAPHIC SCALE



(IN FEET)
1 inch = 40 ft.

TRAILER STORAGE YARD

[illegible]

2006	2007	2008	2009	2010	2011	2012	2013	2014	2015	2016	2017	2018	2019	2020	2021	2022	2023	2024	2025	2026	2027	2028	2029	2030	2031	2032	2033	2034	2035	2036	2037	2038	2039	2040	2041	2042	2043	2044	2045	2046	2047	2048	2049	2050	2051	2052	2053	2054	2055	2056	2057	2058	2059	2060	2061	2062	2063	2064	2065	2066	2067	2068	2069	2070	2071	2072	2073	2074	2075	2076	2077	2078	2079	2080	2081	2082	2083	2084	2085	2086	2087	2088	2089	2090	2091	2092	2093	2094	2095	2096	2097	2098	2099	2100	2101	2102	2103	2104	2105	2106	2107	2108	2109	2110	2111	2112	2113	2114	2115	2116	2117	2118	2119	2120	2121	2122	2123	2124	2125	2126	2127	2128	2129	2130	2131	2132	2133	2134	2135	2136	2137	2138	2139	2140	2141	2142	2143	2144	2145	2146	2147	2148	2149	2150	2151	2152	2153	2154	2155	2156	2157	2158	2159	2160	2161	2162	2163	2164	2165	2166	2167	2168	2169	2170	2171	2172	2173	2174	2175	2176	2177	2178	2179	2180	2181	2182	2183	2184	2185	2186	2187	2188	2189	2190	2191	2192	2193	2194	2195	2196	2197	2198	2199	2200	2201	2202	2203	2204	2205	2206	2207	2208	2209	2210	2211	2212	2213	2214	2215	2216	2217	2218	2219	2220	2221	2222	2223	2224	2225	2226	2227	2228	2229	2230	2231	2232	2233	2234	2235	2236	2237	2238	2239	2240	2241	2242	2243	2244	2245	2246	2247	2248	2249	2250	2251	2252	2253	2254	2255	2256	2257	2258	2259	2260	2261	2262	2263	2264	2265	2266	2267	2268	2269	2270	2271	2272	2273	2274	2275	2276	2277	2278	2279	2280	2281	2282	2283	2284	2285	2286	2287	2288	2289	2290	2291	2292	2293	2294	2295	2296	2297	2298	2299	2300	2301	2302	2303	2304	2305	2306	2307	2308	2309	2310	2311	2312	2313	2314	2315	2316	2317	2318	2319	2320	2321	2322	2323	2324	2325	2326	2327	2328	2329	2330	2331	2332	2333	2334	2335	2336	2337	2338	2339	2340	2341	2342	2343	2344	2345	2346	2347	2348	2349	2350	2351	2352	2353	2354	2355	2356	2357	2358	2359	2360	2361	2362	2363	2364	2365	2366	2367	2368	2369	2370	2371	2372	2373	2374	2375	2376	2377	2378	2379	2380	2381	2382	2383	2384	2385	2386	2387	2388	2389	2390	2391	2392	2393	2394	2395	2396	2397	2398	2399	2400	2401	2402	2403	2404	2405	2406	2407	2408	2409	2410	2411	2412	2413	2414
------	------	------	------	------	------	------	------	------	------	------	------	------	------	------	------	------	------	------	------	------	------	------	------	------	------	------	------	------	------	------	------	------	------	------	------	------	------	------	------	------	------	------	------	------	------	------	------	------	------	------	------	------	------	------	------	------	------	------	------	------	------	------	------	------	------	------	------	------	------	------	------	------	------	------	------	------	------	------	------	------	------	------	------	------	------	------	------	------	------	------	------	------	------	------	------	------	------	------	------	------	------	------	------	------	------	------	------	------	------	------	------	------	------	------	------	------	------	------	------	------	------	------	------	------	------	------	------	------	------	------	------	------	------	------	------	------	------	------	------	------	------	------	------	------	------	------	------	------	------	------	------	------	------	------	------	------	------	------	------	------	------	------	------	------	------	------	------	------	------	------	------	------	------	------	------	------	------	------	------	------	------	------	------	------	------	------	------	------	------	------	------	------	------	------	------	------	------	------	------	------	------	------	------	------	------	------	------	------	------	------	------	------	------	------	------	------	------	------	------	------	------	------	------	------	------	------	------	------	------	------	------	------	------	------	------	------	------	------	------	------	------	------	------	------	------	------	------	------	------	------	------	------	------	------	------	------	------	------	------	------	------	------	------	------	------	------	------	------	------	------	------	------	------	------	------	------	------	------	------	------	------	------	------	------	------	------	------	------	------	------	------	------	------	------	------	------	------	------	------	------	------	------	------	------	------	------	------	------	------	------	------	------	------	------	------	------	------	------	------	------	------	------	------	------	------	------	------	------	------	------	------	------	------	------	------	------	------	------	------	------	------	------	------	------	------	------	------	------	------	------	------	------	------	------	------	------	------	------	------	------	------	------	------	------	------	------	------	------	------	------	------	------	------	------	------	------	------	------	------	------	------	------	------	------	------	------	------	------	------	------	------	------	------	------	------	------	------	------	------	------	------	------	------	------	------	------	------	------

THOMAS & HUTTON
615 Main Street • Suite 124
Nashville, TN 37206 • 615.349.4949
www.thomasandhutton.com

ARCO DESIGN/BUILD
DAVIDSON COUNTY, TN

2 DELL PARKWAY

EROSION CONTROL - FINAL

NO:	J-29470.0000
E:	8-17-21
WN:	CSH
GNED:	CSH
EWED:	CAG
ROVED:	CAG
E:	1" = 40'

C3.6

Z:\29470\29470.000\ENGINEERING\DRAWINGS\CONSTRUCTION PLANS\29470.000 - EC - FINAL.DWG - Aug 17, 2021 - 5:19 PM

ACTIVITY: Temporary Outlet Protection	TCP – 25
--	----------

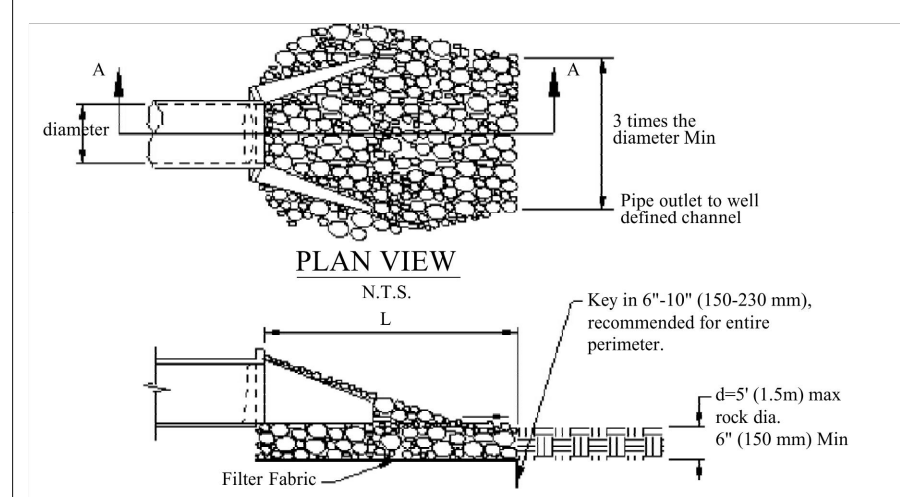

Pipe Diameter (in mm)	Discharge (l/sm ² /s)	Apron Length, L (ft/m)	Rip-Rap D ₅₀ Diameter Min (in/mm)
12 (300)	4.9 (0.14)	10 (3)	4 (100)
	9.89 (0.28)	13 (4)	6 (150)
18 (450)	9.89 (0.28)	10 (3)	6 (150)
	20.13 (0.57)	16 (5)	8 (200)
	30.01 (0.85)	23 (7)	12 (300)
	39.01 (1.13)	26 (8)	16 (400)
24 (600)	30.01 (0.85)	16 (5)	8 (200)
	39.01 (1.13)	26 (8)	8 (200)
	50.14 (1.42)	26 (8)	12 (300)
	60.03 (1.70)	30 (9)	16 (400)

Source: USDA-SCS.

Figure TCP-25-1
Outlet Protection Sizing

Volume 4: Stormwater Best Management Practices – Temporary Construction Management Practices	TCP-25-4	February 2000
--	----------	---------------

ACTIVITY: Temporary Inlet Protection	TCP – 24
---	----------

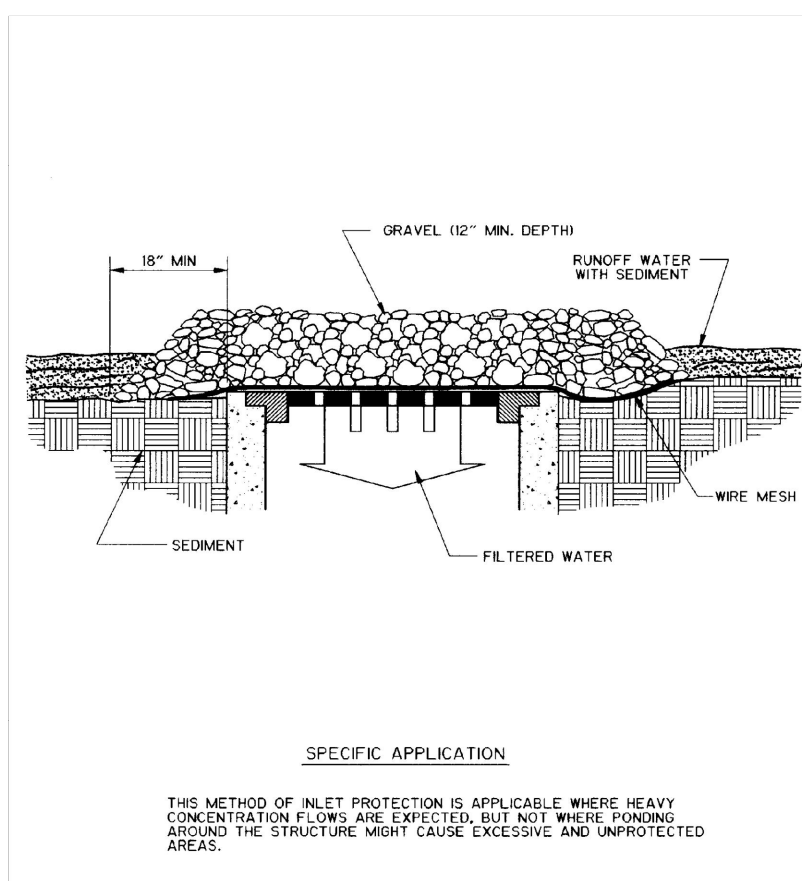

Figure TCP-24-4
Wire Mesh and Gravel Inlet Filter

Volume 4: Stormwater Best Management Practices – Temporary Construction Management Practices	TCP-24-8	September 2013
--	----------	----------------

ACTIVITY: Stabilized Construction Entrance	TCP – 03
---	----------

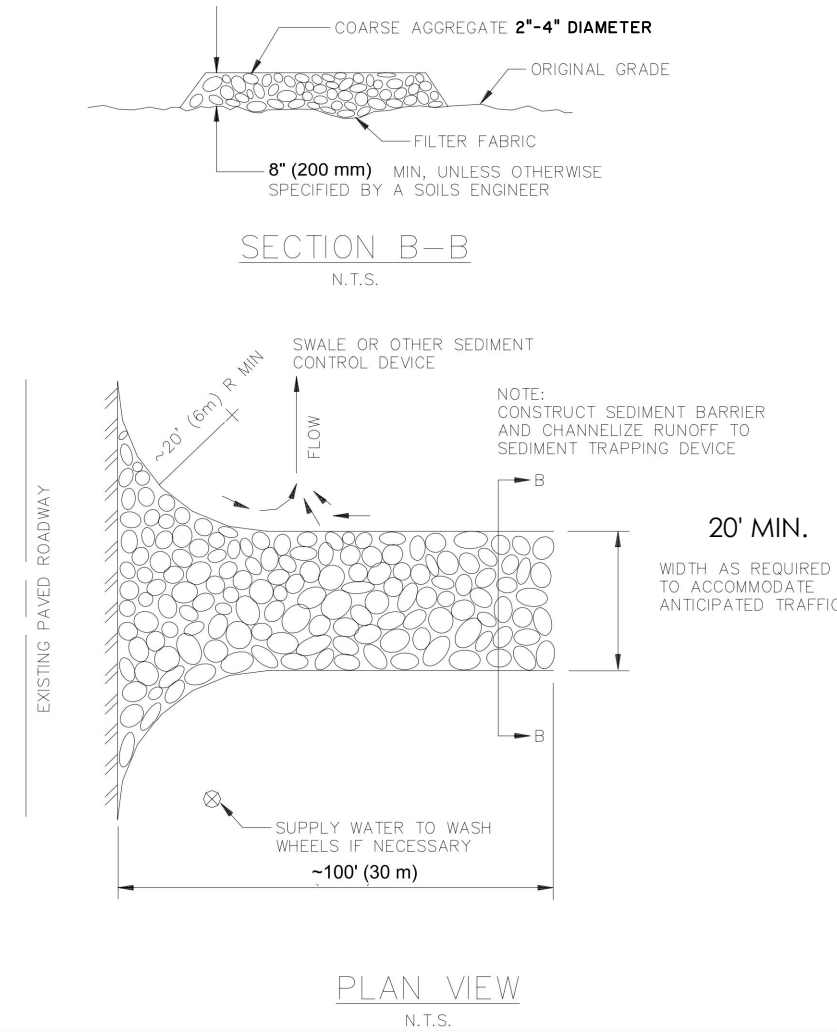

Figure TCP-03-1
Stabilized Construction Entrance

Volume 4: Stormwater Best Management Practices – Temp. Construction Site Management Practices TCP-03-5	September 2013
--	----------------

ACTIVITY: Geotextiles	PESC – 02
------------------------------	-----------

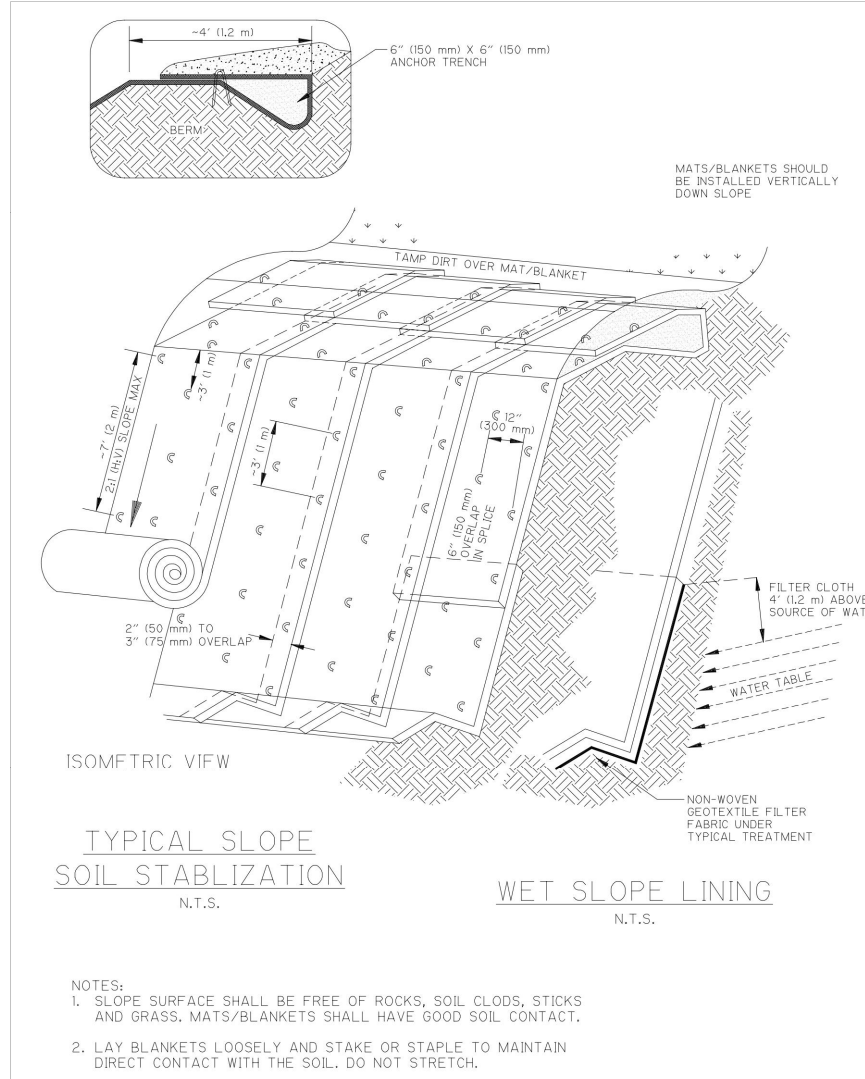

Figure PESC-02-2
Anchoring Geotextiles on Embankments

Volume 4:
Stormwater Best Management Practices –
Permanent E&S Control Management Practices PESC-02-4 February 2000

ACTIVITY: Weighted Sediment Tube	TCP – 14
---	----------

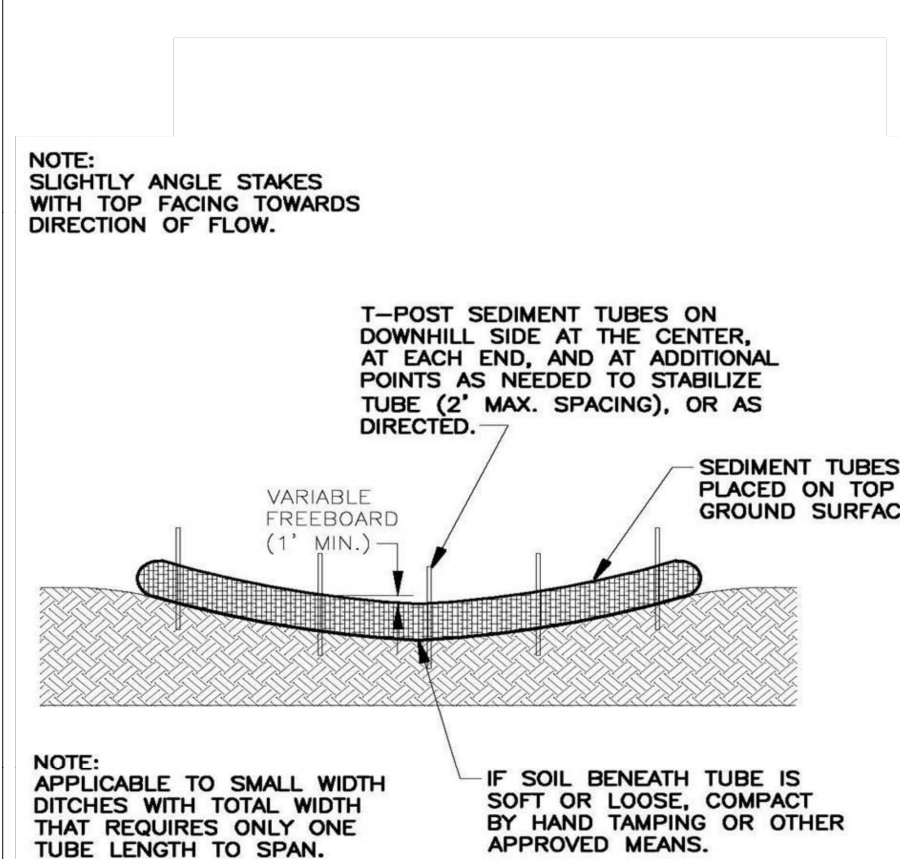

Figure TCP-14-1
Small Ditch Checks for Sediment Tubes

Volume 4: Stormwater Best Management Practices – Temp. Construction Management Practices	TCP-14-6	August 2009
--	----------	-------------

ACTIVITY: Temporary Diversions, Drains and Swales	TCP – 22
--	----------

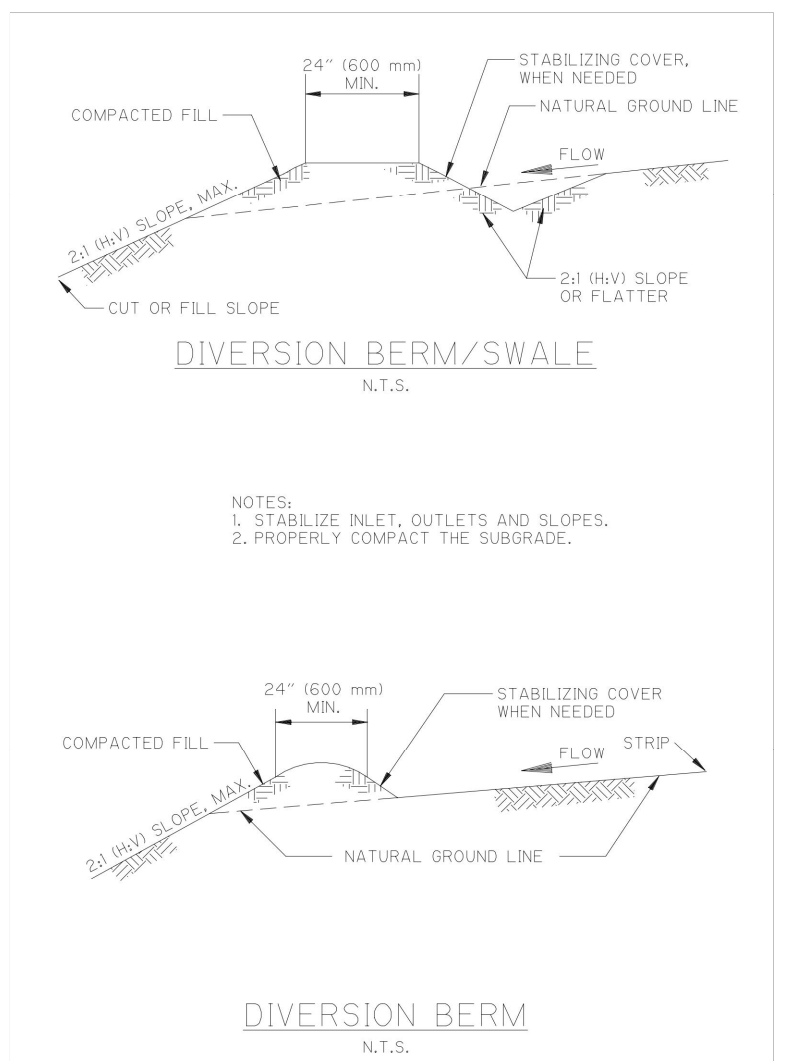
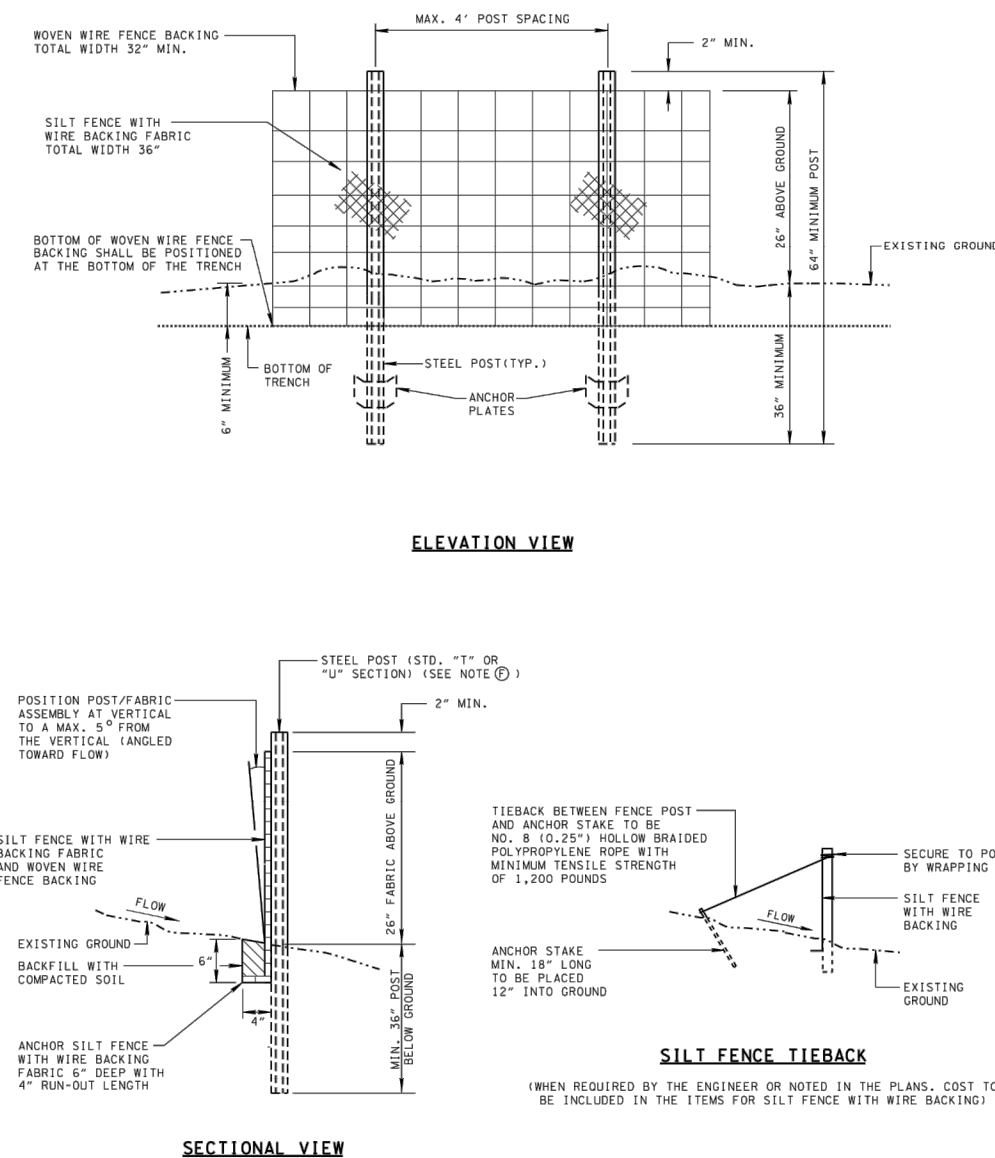

Figure TCP-22-4
Diversion Berm and Berm/Swale

Volume 4: Stormwater Best Management Practices – Temp. Construction Management Practices	TCP-22-12	February 2000
--	-----------	---------------



EROSION CONTROL PLAN LEGEND: • SFB • SFB • SFB • SILT FENCE WITH WIRE BACKING

SILT FENCE WITH WIRE BACKING FABRIC SPECIFICATIONS	
FABRIC PROPERTY AND TEST METHODS	REQUIRED PHYSICAL PROPERTIES (MINIMUM VALUES OF TEST DATA)
GEOTEXTILE FABRIC TYPE	NOVEN MONOL (LANT)
APPROXIMATE OPENING SIZE (ASTM D4751)	70 to 100 STANDARD SIEVE
WATER FLOW (ASTM D4751)	1 LB GPM/FT ²
TENSILE STRENGTH (ASTM D4632)	250 LB/FT. (HARP DIRECTION) X 200 LB/FT. (WARP DIRECTION)
UNWINDABLE STABILITY (AFTER 500 HRS PER ASTM D4632)	≥ 90%
BURST STRENGTH (ASTM D5786)	≥ 400 PSI
PUNCTURE STRENGTH (ASTM D4883)	≥ 105 LB/FT.
TRAPEZOIDAL TEAR (ASTM D4535)	100 LB/FT. (HARP DIRECTION) X 100 LB/FT. (WARP DIRECTION)

SILT FENCE WITH WIRE BACKING GENERAL NOTES

- [illegible]

MINOR REVISION -- FHWA
APPROVAL NOT REQUIRED.

NOT TO SCALE

STATE OF TENNESSEE
DEPARTMENT OF TRANSPORTATION

SILT FENCE
WITH WIRE
BACKING

12-18-02 EC-STR-30

Appendix B Paving, Grading, and Drainage Plan

2:29470.0000 ENGINEERING DRAWINGS CONSTRUCTION PLANS (SHEET 05.00) - GRADING PLANS - AUG 17, 2021 - 5:58 PM



PAVEMENT LEGEND

- LIGHT DUTY ASPHALT - 8" GAB / 2" ASPHALT
- HEAVY DUTY ASPHALT - 8" GAB / 3-1/2" ASPHALT
- 7" CONCRETE
- 4" SIDEWALK

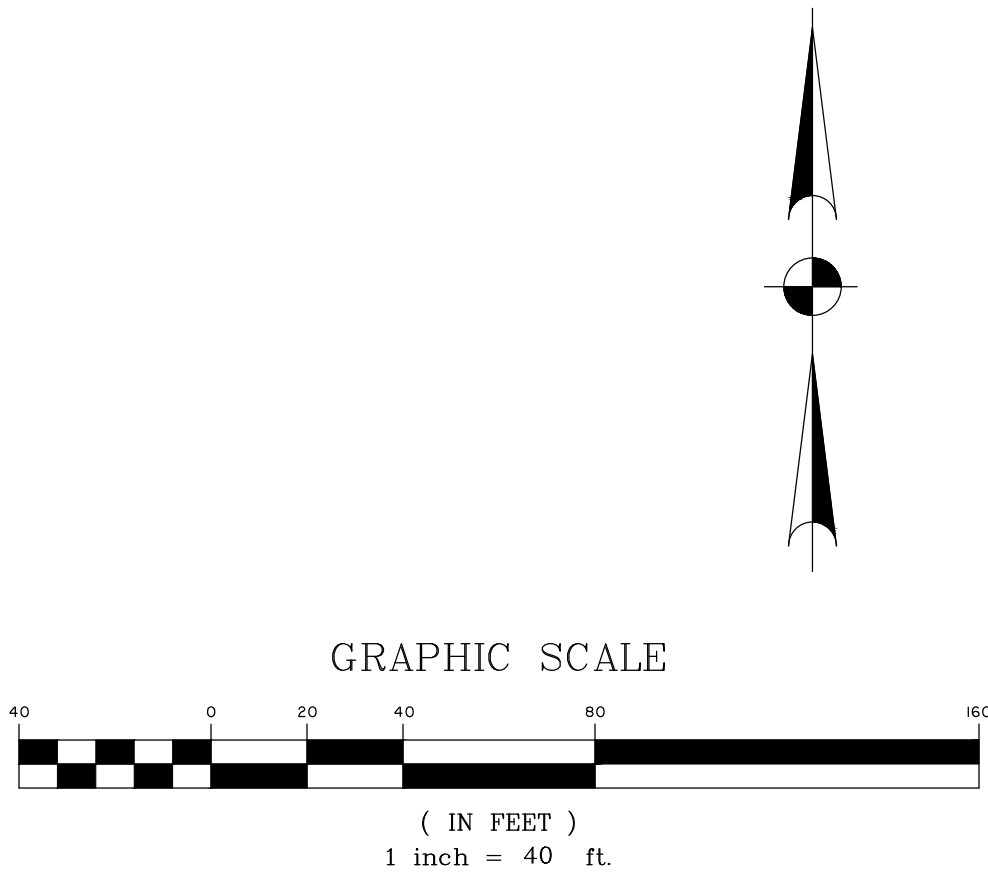

THOMAS & HUTTON
CHAD GRASS
REGISTERED PROFESSIONAL ENGINEER
08/17/2021
NASHVILLE, TN 37206
DAVIDSON COUNTY, TN

NO.	REVISIONS	BY	DATE

THOMAS & HUTTON
615 Main Street • Suite 124
Nashville, TN 37206 • 615.349.4990
www.thomasandhutton.com

ARCO DESIGN/BUILD
DAVIDSON COUNTY, TN
2 DELL PARKWAY
GRADING PLAN

JOB NO:	J-29470.0000
DATE:	8-17-21
DRAWN:	CSH
DESIGNED:	CSH
REVIEWED:	CAG
APPROVED:	CAG
SCALE:	1" = 40'

C5.1

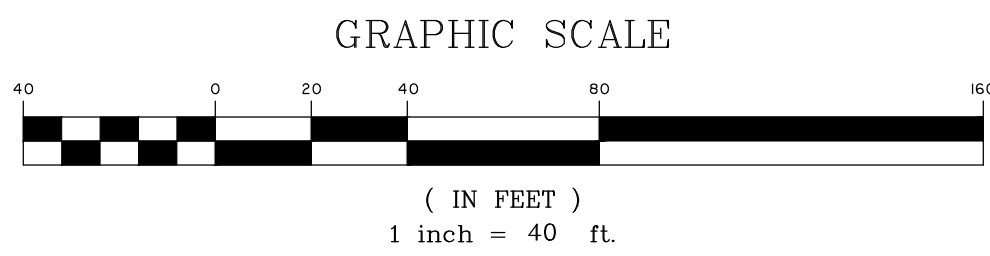

NO.	REVISIONS	BY	DATE

TH **THOMAS**
&
HUTTON

615 Main Street • Suite 124
Nashville, TN 37206 • 615.349.4990
www.thomasandhutton.com

ARCO DESIGN/BUILD
DAVIDSON COUNTY, TN
2 DELL PARKWAY
GRADING PLAN

JOB NO:	J-29470.0000
DATE:	8-17-21
DRAWN:	CSH
DESIGNED:	CSH
REVIEWED:	CAG
APPROVED:	CAG
SCALE:	1" = 40'

C5.2

J:\29470\29470.DWG UNDERGROUND DRAINAGE CONSTRUCTION PLANS\29470.DWG - PAVING AND DRAINAGE PLANS - 08/17/2021 - 5:58 PM



PIPE TABLE							
UPSTREAM STRUCTURE	UPSTREAM INVERT	DOWNSTREAM STRUCTURE	DOWNSTREAM INVERT	SECTION SIZE (IN)	LENGTH	SLOPE (%)	MATERIAL
E2	558.90	EX-AB1	558.60	24"	78	0.38%	RCP - CLASS III
CS2	559.50	E2	558.90	24"	158	0.38%	RCP - CLASS III
CS1	556.00	EX-AC1	555.73	12"	15	1.86%	RCP - CLASS III
C5	569.67	C4	568.80	18"	88	1.00%	RCP - CLASS III
C4	568.80	C3	566.52	24"	154	1.48%	RCP - CLASS III
C3	566.52	C2	565.09	24"	142	1.00%	RCP - CLASS III
C2	565.09	C1	564.00	24"	108	1.01%	RCP - CLASS III
B3	564.76	B2	563.46	18"	256	0.50%	RCP - CLASS III
B2	563.46	B1	563.00	18"	93	0.50%	RCP - CLASS III
A6	566.50	A5	565.99	18"	102	0.50%	RCP - CLASS III
A5	565.99	A4	565.48	24"	102	0.50%	RCP - CLASS III
A4	565.48	A3	564.97	30"	102	0.50%	RCP - CLASS III
A3	564.97	A2	563.38	36"	132	1.20%	RCP - CLASS III
A2	563.38	A1	562.00	36"	23	6.00%	RCP - CLASS III

STRUCTURE TABLE		
LABEL	DESCRIPTION	FRAME
EX-AC1	JUNCTION BOX	563.30
EX-AB1	EXISTING CURB INLET	560.98
E2	JUNCTION BOX	569.24
CS2	BIO2 CONTROL STRUCTURE	563.50
CS1	BIO1 CONTROL STRUCTURE	562.35
C5	WQS CONTROL STRUCTURE	574.27
C4	SINGLE CURB INLET JBS 3300	576.71
C3	JUNCTION BOX	579.37
C2	SINGLE CURB INLET JBS 3300	575.00
C1	WINGED HEADWALL RECTANGULAR	566.75
B3	TRIPLE CURB INLET JBS 3300	571.32
B2	TRIPLE CURB INLET JBS 3300	567.73
B1	WINGED HEADWALL RECTANGULAR	565.75
A6	DOUBLE CATCH BASIN JBS 4077	571.89
A5	DOUBLE CATCH BASIN JBS 4077	571.89
A4	DOUBLE CATCH BASIN JBS 4077	571.89
A3	DOUBLE CATCH BASIN JBS 4077	571.89
A2	SINGLE CURB INLET JBS 3300	569.25
A1	WINGED HEADWALL RECTANGULAR	565.83

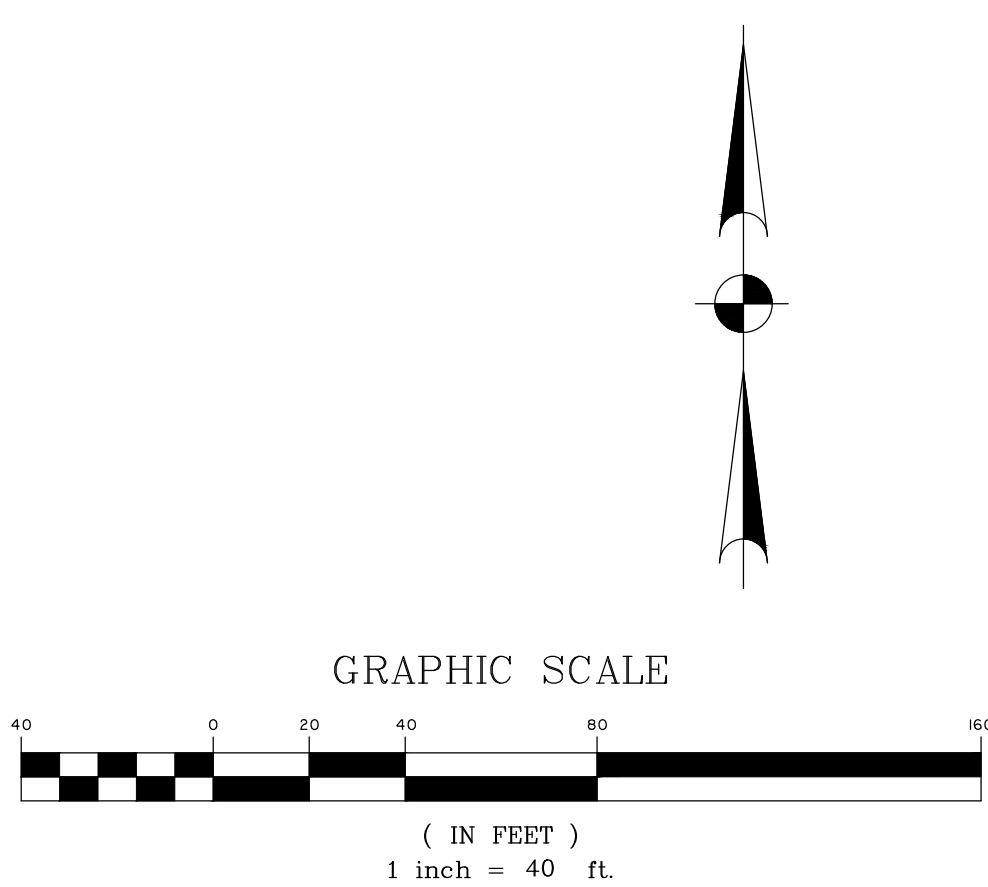

PAVEMENT LEGEND	
	LIGHT DUTY ASPHALT - 8" GAB / 2" ASPHALT
	HEAVY DUTY ASPHALT - 8" GAB / 3-1/2" ASPHALT
	7" CONCRETE
	4" SIDEWALK

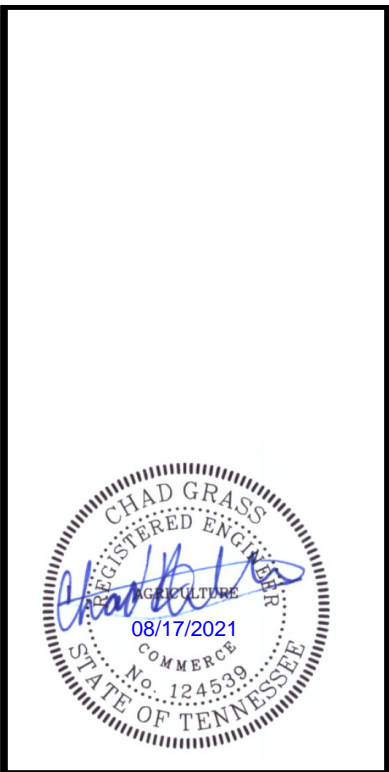

REVISIONS	
NO.	BY DATE

THOMAS & HUTTON
615 Main Street • Suite 124
Nashville, TN 37206 • 615.349.4990
www.thomasandhutton.com

ARCO DESIGN/BUILD
DAVIDSON COUNTY, TN
2 DELL PARKWAY
PAVING & DRAINAGE PLAN

JOB NO: J-29470.0000
DATE: 8-17-21
DRAWN: CSH
DESIGNED: CSH
REVIEWED: CAG
APPROVED: CAG
SCALE: 1" = 40'

C6.1

2:29470 TO 29470.0000 ENGINEERING SERVICES CONSTRUCTION PLANS (PART 2) 2020 - PAVING AND DRAINAGE PLANS - AUG 17, 2021 - 5:58 PM

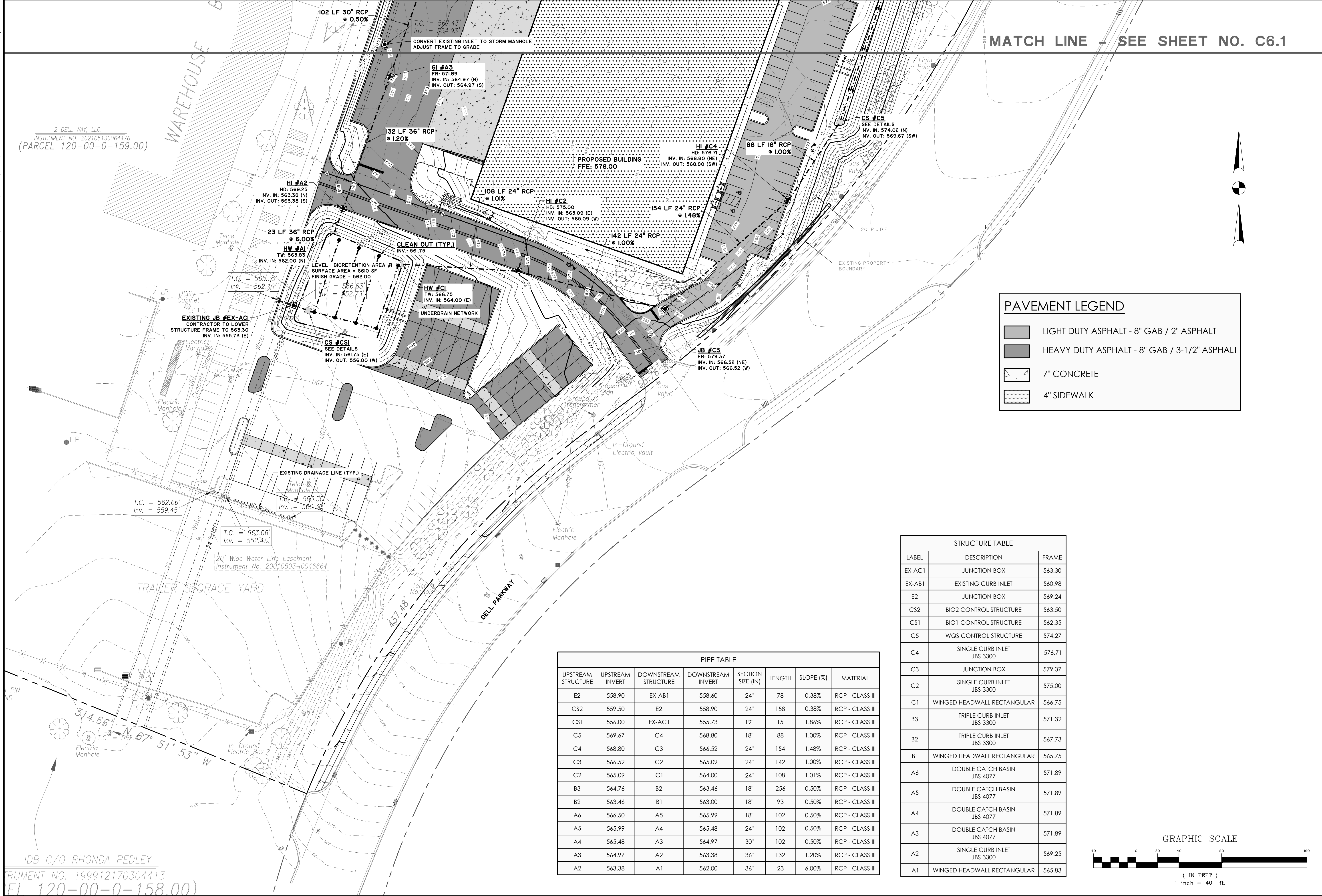

PAVEMENT LEGEND

- LIGHT DUTY ASPHALT - 8" GAB / 2" ASPHALT
- HEAVY DUTY ASPHALT - 8" GAB / 3-1/2" ASPHALT
- 7" CONCRETE
- 4" SIDEWALK

PIPE TABLE							
UPSTREAM STRUCTURE	UPSTREAM INVERT	DOWNSTREAM STRUCTURE	DOWNSTREAM INVERT	SECTION SIZE (IN)	LENGTH	SLOPE (%)	MATERIAL
E2	558.90	EX-AB1	558.60	24"	78	0.38%	RCP - CLASS III
CS2	559.50	E2	558.90	24"	158	0.38%	RCP - CLASS III
CS1	556.00	EX-AC1	555.73	12"	15	1.86%	RCP - CLASS III
CS5	569.67	C4	568.80	18"	88	1.00%	RCP - CLASS III
C4	568.80	C3	566.52	24"	154	1.48%	RCP - CLASS III
C3	566.52	C2	565.09	24"	142	1.00%	RCP - CLASS III
C2	565.09	C1	564.00	24"	108	1.01%	RCP - CLASS III
B3	564.76	B2	563.46	18"	256	0.50%	RCP - CLASS III
B2	563.46	B1	563.00	18"	93	0.50%	RCP - CLASS III
A6	566.50	A5	565.99	18"	102	0.50%	RCP - CLASS III
A5	565.99	A4	565.48	24"	102	0.50%	RCP - CLASS III
A4	565.48	A3	564.97	30"	102	0.50%	RCP - CLASS III
A3	564.97	A2	563.38	36"	132	1.20%	RCP - CLASS III
A2	563.38	A1	562.00	36"	23	6.00%	RCP - CLASS III

STRUCTURE TABLE		
LABEL	DESCRIPTION	FRAME
EX-AC1	JUNCTION BOX	563.30
EX-AB1	EXISTING CURB INLET	560.98
E2	JUNCTION BOX	569.24
CS2	BIO2 CONTROL STRUCTURE	563.50
CS1	BIO1 CONTROL STRUCTURE	562.35
C5	WQS CONTROL STRUCTURE	574.27
C4	SINGLE CURB INLET JBS 3300	576.71
C3	JUNCTION BOX	579.37
C2	SINGLE CURB INLET JBS 3300	575.00
C1	WINGED HEADWALL RECTANGULAR	566.75
B3	TRIPLE CURB INLET JBS 3300	571.32
B2	TRIPLE CURB INLET JBS 3300	567.73
B1	WINGED HEADWALL RECTANGULAR	565.75
A6	DOUBLE CATCH BASIN JBS 4077	571.89
A5	DOUBLE CATCH BASIN JBS 4077	571.89
A4	DOUBLE CATCH BASIN JBS 4077	571.89
A3	DOUBLE CATCH BASIN JBS 4077	571.89
A2	SINGLE CURB INLET JBS 3300	569.25
A1	WINGED HEADWALL RECTANGULAR	565.83

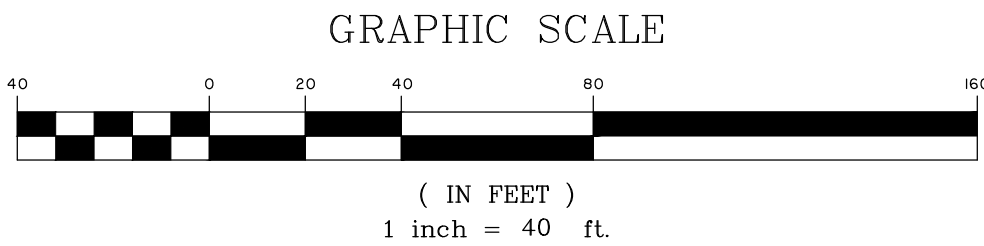

CHAD G. HUTTON
REGISTERED ENGINEER
08/17/2021
NO. 124500
STATE OF TENNESSEE

NO.	REVISIONS	BY	DATE

THOMAS & HUTTON
615 Main Street • Suite 124
Nashville, TN 37206 • 615.349.4990
www.thomasandhutton.com

ARCO DESIGN/BUILD
DAVIDSON COUNTY, TN

2 DELL PARKWAY

PAVING & DRAINAGE PLAN

JOB NO: J-29470.0000
DATE: 8-17-21
DRAWN: CSH
DESIGNED: CSH
REVIEWED: CAG
APPROVED: CAG
SCALE: 1" = 40'

C6.2

Appendix C Location and Site Map

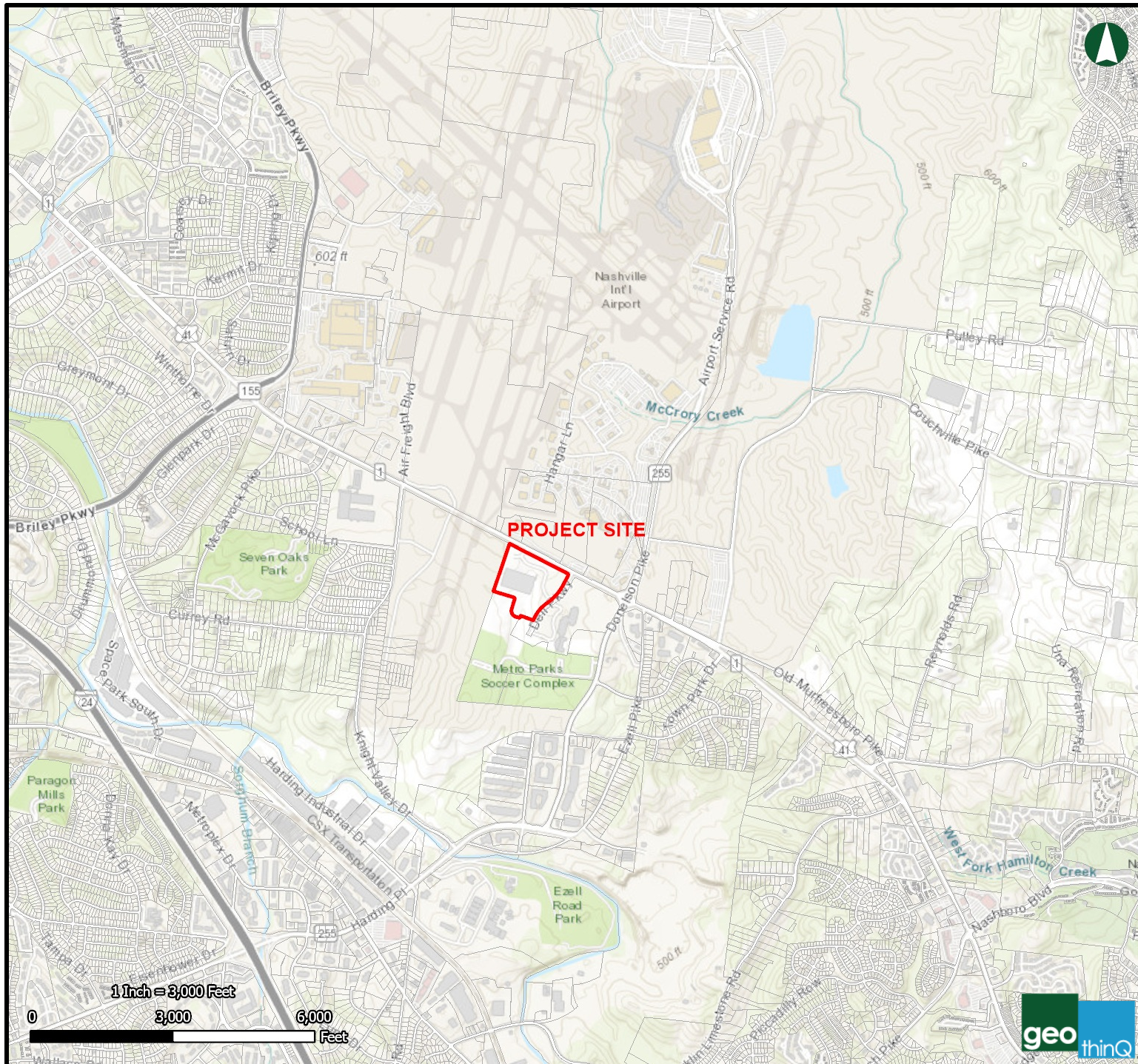

2 DELL PARKWAY

SITE LOCATION MAP

08/18/2021

 Parcels

