



STATE OF TENNESSEE
DEPARTMENT OF ENVIRONMENT AND CONSERVATION

Division of Solid Waste Management
William R. Snodgrass Tennessee Tower
312 Rosa L. Parks Avenue, 14th Floor
Nashville, Tennessee 37243

May 20, 2022

Jeff Maddox
CWM, LLC
511 Cave Rd.
Nashville, TN 37210

Re: Amended Permit-By-Rule Approval – Financial Assurance
CWM, LLC Processing Facility – SWP190001540

Dear Mr. Maddox:

As required by Rule 0400-11-01-.02(6)(b)1 of the Solid Waste Processing and Disposal Regulations, the Tennessee Department of Environment and Conservation (TDEC), Division of Solid Waste Management (DSWM), has reviewed your amended notification to the Permit-By-Rule for the CWM, LLC (SWP190001540) facility received on April 5, 2022. The amended notification was submitted in response to our letter dated January 31, 2022, requiring solid waste processing facilities to update or submit financial assurance per Rule 0400-11-01-.02(2)(b)1(i)(XVIII). The approved maximum storage capacity for the facility is 800 cubic yards.

Therefore, DSWM is notifying you of the results of this review in accordance with Rule 0400-11-01-.02(6)(b)2(ii). DSWM approves the updated notification amendments for incorporation into the approved CWM, LLC Permit-By-Rule as previously authorized by DSWM's letter dated August 7, 2017. Please note that, per Rule 0400-11-01-.02(2)(a)3(iii), you must notify DSWM of any substantive changes in the information approved within this Permit-By-Rule and receive an amended written authorization from the DSWM prior to implementing the change.

Per Rule 0400-11-01.02(2)(a)1(xxiii) solid waste processing facilities must file a financial instrument with the State of Tennessee in an amount sufficient to insure the proper closure of the facility. The required financial assurance amount for this facility is \$9,264.40. Please contact TDEC's Division of Fiscal Services at (615) 253-6367 for assistance concerning the posting of this financial assurance.

If you have any questions, feel free to contact Brianna Rives by email at Brianna.Rives@tn.gov or call 615-308-0104.

Sincerely,

A handwritten signature in blue ink, appearing to read "Lisa Hughey", is positioned above a blue horizontal line.

[Lisa Hughey](#) May 20, 2022 08:13 CDT)

Lisa A. Hughey, CHMM
Director

cc: Mike Horsley, Manager, DSWM Nashville Environmental Field Office
Bassam Faleh, DSWM, Nashville Central Office
Ian Jakul, Director, TDEC Financial Responsibility Group
Erini Ryad, TDEC Financial Responsibility Group
records.swm@tn.gov



STATE OF TENNESSEE
DEPARTMENT OF ENVIRONMENT AND CONSERVATION
DIVISION OF SOLID WASTE MANAGEMENT
WILLIAM R. SNODGRASS TENNESSEE TOWER
312 ROSA L. PARKS AVENUE, 14TH FLOOR
NASHVILLE, TN 37243

SOLID WASTE PERMIT BY RULE NOTIFICATION

1. TYPE OF PERMIT- BY- RULE REQUESTED			ID# TDEC USE ONLY	
<input type="checkbox"/> COMPOST FACILITY	<input type="checkbox"/> LAND APPLICATION	<input type="checkbox"/> TIRE STORAGE FACILITY		
<input type="checkbox"/> CONVENIENCE CENTER	<input type="checkbox"/> PROCESSING FACILITY	<input checked="" type="checkbox"/> TRANSFER STATION		
2. FACILITY INFORMATION			FACILITY LOCATION COUNTY	
FULL LEGAL NAME OF FACILITY CWM, LLC dba Cave Road Recycling			LATITUDE (DECIMAL DEGREES)	
PHYSICAL LOCATION OR ADDRESS OF FACILITY 511 Cave Rd Nashville TN 37210			LONGITUDE (DECIMAL DEGREES)	
FACILITY MAILING ADDRESS 511 Cave Rd Nashville TN 37210			FACILITY EMAIL caveroadrecycling@gmail.com	
FACILITY MANAGER OR SITE OPERATOR Brittney Hardin			PHONE (WITH AREA CODE) 615-454-2916	
AFFILIATION OF SITE OPERATOR (IF DIFFERENT FROM PERMITTEE) N/A				
3. APPLICANT (PERMITTEE)				
APPLICANT NAME CWM, LLC		PHONE (WITH AREA CODE) 615-454-2916	EMAIL caveroadrecycling@gmail.com	
RESPONSIBLE OFFICIAL / TITLE Jeff Maddox		PHONE (WITH AREA CODE) 615-438-2894	EMAIL jealmad71@me.com	
RESPONSIBLE OFFICIAL MAILING ADDRESS 511 Cave Rd Nashville TN 37210				
LANDOWNER NAME CWM, LLC	LANDOWNER MAILING ADDRESS 511 Cave Rd Nashville TN 37210			
LANDOWNER SIGNATURE 		DATE 2/10/22		
4. WASTE HANDLING				
DESCRIPTION OF ACTIVITIES AND WASTES HANDLED OR PROCESSED C&D material will be dumped on concrete floor then sorted for recyclable materials. Remainder to go to landfills.		AMOUNT OF WASTE HANDLED, PROCESSED OR STORED		
		NA	400	800
		WEIGHT TONS / DAY	VOLUME YARDS / DAY	STORAGE MAX CU YARDS
5. CERTIFICATION REQUIRED				
I certify under penalty of law that this document and all attachments were prepared by me, or under my direction or supervision. The submitted information is to the best of my knowledge and belief, true, accurate, and complete. I am aware that there are significant penalties for submitting false information, including the possibility of fine and imprisonment. As specified in Tennessee Code Annotated Section 39-16-702(a)(4), this declaration is made under penalty of perjury.				
SIGNATURE OF RESPONSIBLE OFFICIAL 		PRINTED NAME Jeff Maddox		
TITLE Member		DATE 2/15/22		
SIGNATURE OF NOTARY 		DATE COMMISSION EXPIRES 7.9.2024		

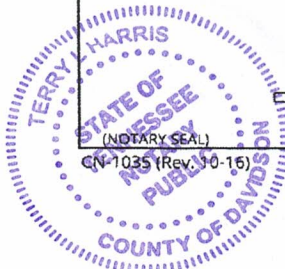



STATE OF TENNESSEE
DEPARTMENT OF ENVIRONMENT AND CONSERVATION
Division of Solid Waste Management
William R. Snodgrass Tennessee Tower
312 Rosa L. Parks Avenue, 14th Floor
Nashville, Tennessee 37243

January 31, 2022

Mr. Jeff Maddox
CWM, LLC
106 Mission Crt. #105
Franklin, TN 37067

**RE: New Solid Waste Processing Facility Regulations – Financial Assurance
CWM, LLC – SWP190001540**

Dear Mr. Maddox:

As you may be aware, on December 30, 2019, new regulations became effective in Tennessee, including updates to the requirements for Permit-By-Rule solid waste processing facilities. Previously, regulations only required financial assurance for solid waste processing facilities that had a solid waste storage capacity of 1000 cubic yards or greater. The December 30, 2019 updates removed this threshold for financial assurance. Rule 0400-11-01-.02(2)(b)1(i)(XVIII) now requires all solid waste processing facilities to file financial assurance. The details of this Rule can be found on page 28 of the Solid Waste Processing and Disposal Regulations (Chapter 0400-11-01). You may find the regulations on our website or request a copy from us via email.

Our records indicate that your facility does not currently have financial assurance. To bring your Permit-By-Rule facility into compliance with the updated regulations and determine the amount of financial assurance required, please re-submit your solid waste Permit-By-Rule notification form CN-1035, response to criteria, narrative, and a financial assurance calculation worksheet; all of which are provided as enclosures. The response to criteria and financial assurance worksheet provided are templates only; you may provide your own format for each if it contains sufficient answers to each criteria question, and information on the maximum potential storage capacity of waste. All proposed financial assurance cost estimates must be based on third-party closure costs.

The Division of Solid Waste Management (DSWM) is requesting the re-submittal of the above-mentioned information within 60 days of the date of this letter, **April 1, 2022**. Please note that extension requests may be granted for extenuating circumstances; however, the DSWM will evaluate these on a case-by-case basis. Should you have any questions or concerns please email Jeremy Hooper of this office at Jeremy.Hooper@tn.gov.

Sincerely,

Nick Lytle

Nick Lytle, Solid Waste Permits Manager

cc: Mike Horsley, Manager, Nashville Environmental Field Office
DSWM, Central Files, Nashville Central Office

Enclosures – 3

Permits by Rule Criteria: Solid Waste Processors

Please provide a narrative response to how the proposed Solid Waste Processing facility will comply with each of the below regulatory criteria:

Rule 0400-11-01-01-.02(2)(a)4.

New solid waste processing facilities, tire storage facilities, and transfer stations must not be located in wetlands, unless the owner or operator makes the applicable demonstrations to the Commissioner as referenced at subparagraph (2)(p) of Rule 0400-11-01-.04.

Response: Our facility is not located in a wetland.

Rule 0400-11-01-01-.02(2)(a)5

Solid waste processing facilities, tire storage facilities, and transfer stations must not be located in a 100-year floodplain unless it is demonstrated to the satisfaction of the Commissioner that:

(i) Location in the floodplain will not restrict the flow of the 100-year flood nor reduce the temporary water storage capacity of the floodplain; and

(ii) The facility is designed, constructed, operated, and maintained to prevent washout of any solid waste.

Response: The facility tipping floor is above the 100-year floodplain and the building will not restrict the flow nor reduce the capacity of the floodplain. No material will be stored in the 100-year floodplain. All material will be stored inside the building above the 100-year floodplain.

Rule 0400-11-01-01-.02(2)(a)6

Solid waste processing facilities, tire storage facilities, and transfer stations must **not**:

(i) Cause or contribute to the taking of any endangered or threatened species of plants, fish, or wildlife; or

(ii) Result in the destruction or adverse modification of the critical habitat of endangered or threatened species.

Response The facility will not threaten, endanger, or have any negative affect on plants, animals, or wildlife habitats. The facility is in a currently developed industrial site and that there are no endangered or threatened species on site.

Rule 0400-11-01-01-.02(2)(a)7&8

An owner or operator proposing a new solid waste processing facility or a transfer station that handles putrescible wastes located within 10,000 feet (3,048 meters) of any airport runway end used by turbojet aircraft or within 5,000 feet (1,524 meters) of any airport runway end used only by piston-type aircraft must demonstrate to the satisfaction of the Commissioner that the facility does not pose a bird hazard to aircraft.

An owner or operator proposing a new solid waste processing facility or a transfer station that handles putrescible wastes located within a five-mile radius of any airport runway end used by turbojet or piston-type aircraft must notify the affected airport and the appropriate Federal Aviation Administration (FAA) office.

Response: We will not handle any putrescible waste. We only handle C&D material.

Rule 0400-11-01-01-.02(2)(b)(0): Except as specified in subpart (iv) of this part, an owner or operator of a (solid waste processor facility shall;

I. Construct, operate, maintain, and close the facility in such a manner as to minimize:

I. The propagation, harborage, or attraction of flies, rodents, or other disease vectors;

II. The potential for explosions or uncontrolled fires;

III. The potential for releases of solid wastes or solid waste constituents to the environment except in a manner authorized by state and local air pollution control, water pollution control, and/or waste management agencies; and

IV. The potential for harm to the public through unauthorized or uncontrolled access;

Response: I. We will only be processing C&D material which does not attract flies and rodents. II. Fire extinguishers will be located throughout the facility and will be properly labeled and accessible to staff members. III. All tipping, sorting, and material storage will be done inside of the building. IV. All doors and fence gates

will be locked when the facility is not in operation. The facility will be open to the public Monday-Friday 7am-4pm and Saturday from 7am-12pm.

(II) Ensure that the facility has an artificial or natural barrier which completely surrounds the facility and a means to control entry, at all times, through the gate or other entrances to the facility;

Response: All loading bay doors will be locked when the facility is not in operation.

(III) Ensure that the facility, if open to the public, has clearly visible and legible signs at the points of public access which indicate the hours of operation, the general types of waste materials that either will or will not be accepted, emergency telephone numbers, schedule of charges (if applicable), and other necessary information;

Response: Entry and exit points will be clearly labeled and hours of operation and emergency contacts will be clearly posted inside and outside of facility.

(IV) Ensure that the facility has trained personnel present during operating hours;

Response: Trained staff will be present during operating hours.

(V) Ensure that the facility has adequate sanitary facilities, potable water, emergency communications (e.g., telephone), and shelter available for personnel.

Response: The facility has two restrooms and a shower. There is conditioned office space and a staff break room. Facility will have land line phone service and all staff members will have cell phones.

(VII) Restrict all waste handling (including loading and unloading) at the facility to paved surfaces;

Response: All waste handling will be conducted on a paved surface.

(VIII) Restrict the storage of solid wastes at the facility to containers, bins, lined pits or on paved surfaces, designated for such storage;

Response: All materials stored onsite will be inside of the building on paved surface or sorted into containers on paved surface. All recycled material will be removed from the site within 30 days and all waste material will be removed from the site within 1-7 days.

(IX) Not burn solid wastes at the facility:

Response: No burning will take place at our facility.

(X) Prohibit scavenging of solid wastes at the facility and limit any salvaging to safe, designated areas and times;

Response: There will be no scavenging allowed at our facility. All sorting will be conducted in a safe designated area.

(XI) Ensure that wind dispersal of solid wastes at or from the facility is adequately controlled, and that windblown litter and other loose, unconfined solid wastes are collected daily and properly disposed;

Response: All stored solid materials will be inside of the building at all times and staff will make daily walks around the site to pick up any blown liter.

(XII) Ensure that all liquids which either drain from solid wastes or are created by washdown of equipment at the facility are collected and directed to either:

- I. A wastewater treatment facility permitted to receive such wastewaters under T.C.A. SS 69-3-101 et seq. (Tennessee Water Quality Control Act), or
- II. Other methods approved by the Commissioner.

Response: We will not accept liquids and all of our solid waste material is tipped, sorted, and temporarily stored inside the building. In the event any waste water is created we will contract with a waste water hauler to properly dispose of such wastewaters.

(XIII) Ensure that special wastes are not received, unless:

- I. Such receipt has been specifically approved in writing by the Commissioner, and
- II. Special procedures and/or equipment are utilized to adequately confine and segregate the special wastes;

Response: We will only take C&D material.

(XIV) Have alternative arrangements (e.g., contracts with other facilities) for the proper processing or disposal of the solid wastes authorized to be managed at the facility in the event the facility cannot operate;

Response: We currently have contracts with other disposal facilities who can process the waste in the event we can not operate.

(XV) Properly maintain and locate fire suppression equipment (e.g., fire extinguishers, water hoses) and make the equipment continuously available in sufficient quantities to control accidental fires that may occur

Response: Per code we will have sufficient fire extinguishers available to control fires should one occur.

(XVI) Manage all wastes residues resulting from processing activities at the facility in accordance with this chapter or Chapter 0400-12-01 (Hazardous Waste Management, whichever is applicable, and/or with any other applicable state or federal regulations governing **waste** management

Response: We will abide by all state, local, and federal regulations governing waste management.

(XVII) Install the processing equipment on-site and ensure it is ready for use before accepting solid waste for storage or processing

Response: Our facility is stocked with all processing equipment needed for processing material.

(XVIII) Prior to receiving solid waste for processing, or within 90 days of the effective date of these rules, if authorized and operating on the effective date of these rules;

File with the Commissioner a performance bond or equivalent cash or securities, payable to the State of Tennessee in an amount determined by the Commissioner to be sufficient to ensure the proper operation, closure, and post closure care of the facility;

Submit financial assurance instruments that are specified in subparagraph (3)(d) of Rule 0400-11-01-.03; and

Ensure that the financial assurance meets the criteria set forth in T.C.A. 68-211-116(a) and complies with subparagraph (3)(b) of Rule 0400-11-01-03.

(XIX) Maintain records documenting the amounts of the different types of solid waste at the facility, including, but not limited to, the amounts stored to be processed, in process, and that have completed processing, in order to determine processing completion within one year;

Response: All records are processed and maintained via industry software and spreadsheets.

(ii) When closing the facility, the owner or operator of a processing facility shall:

(I) Remove all solid wastes and solid waste residues for proper disposal, and

Response: **We agree to remove all solid waste and residue.**

(II) Notify the Commissioner in writing of the completion of closure of the facility and include a certification that the facility has been closed by removal of all solid waste and residues

Response: **We agree to provide this notification in the event we close the facility.**

Re: [EXTERNAL] CWM. LLC

Maria Bolen <Maria.Bolen@tn.gov>

Thu 4/21/2022 3:25 PM

To: Brittney Harden <caveroadrecycling@gmail.com>

 1 attachments (224 KB)

CWM sitemap.pdf;

Thanks Brittney

Sent from my iPhone

On Apr 21, 2022, at 11:52 AM, Brittney Harden <caveroadrecycling@gmail.com> wrote:

***** This is an EXTERNAL email. Please exercise caution. DO NOT open attachments or click links from unknown senders or unexpected email - STS-Security. *****

Good morning!

Thank you for calling me back earlier. I have attached the site plan for our facility and the landfills that we haul to are..

Bi County landfill
4577 Guthrie Hwy
Clarksville, TN 37040

Waste Connections
Hopkins County Landfill
419 Claude Young Rd
White Plains, KY 42464

--

Thanks!!

Brittney Harden
Operations Manager

Cave Road Recycling
511 Cave Rd.
Nashville, TN 37210
615-454-2916

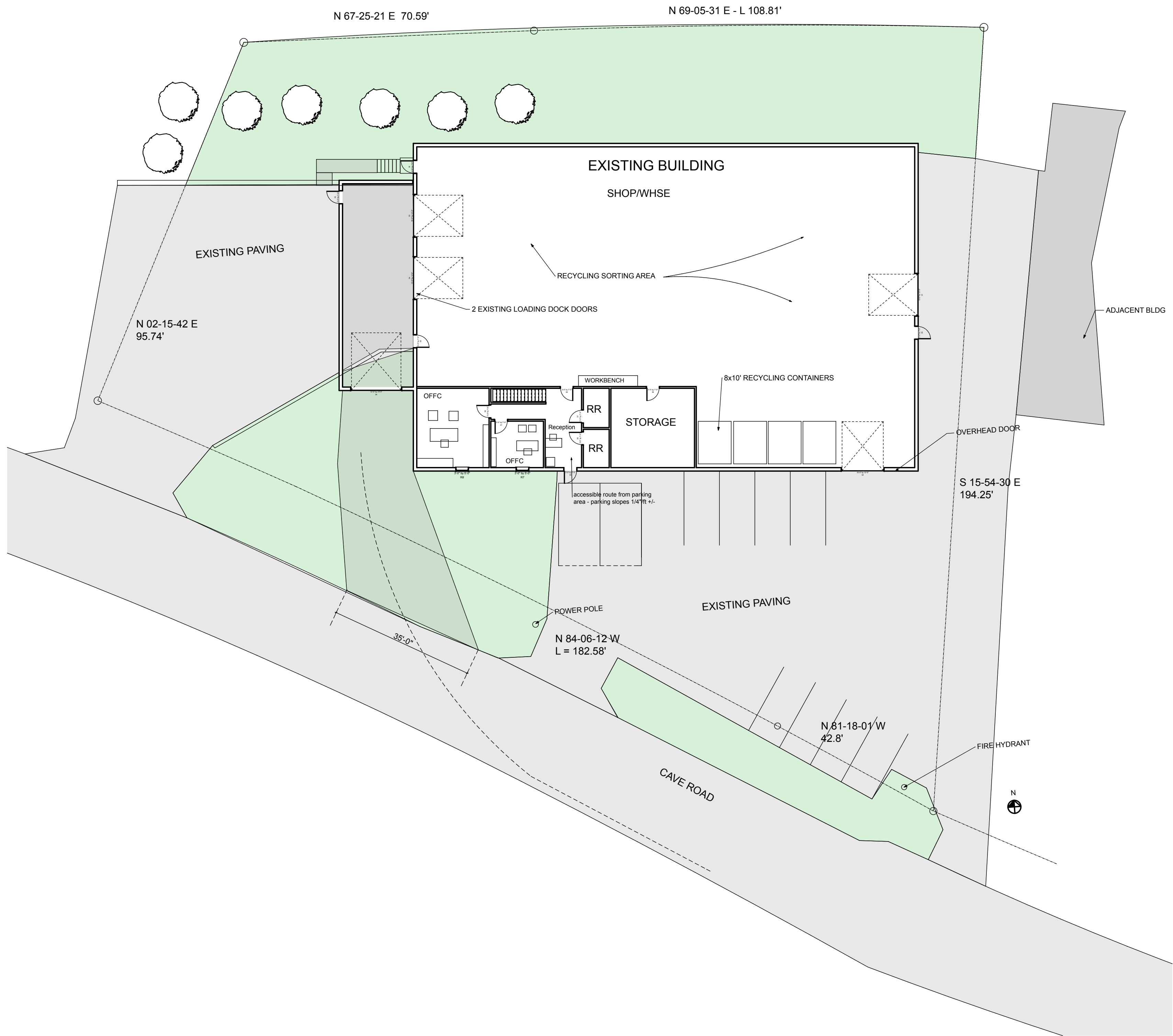

1 SITE PLAN
SCALE: 1/16" = 1'-0"



2831 BERRY HILL DRIVE
SUITE 200
NASHVILLE, TN 37204
Phone: (615) 289-9248 Fax: (615) 627-1298
email: quirksdesigns@comcast.net

QUIRK DESIGNS

EXISTING BLDG SITE PLAN
JEFF MADDOX
511 CAVE ROAD
Nashville, TN 37203

DATE: 10/11/17
REVISION

PROJECT NO: 17-020
COPYRIGHT 10/11/17
QUIRK DESIGNS

SITE PLAN

C1

**PERMIT-BY-RULE PROCESSING FACILITY
FINANCIAL ASSURANCE WORKSHEET**

FACILITY NAME: CWM, LLC dba Cave Road Recycling

1. The maximum storage capacity for solid waste in cubic yards:
Attach a sketch and/or calculation to support this number.
Work space $35' \times 40' \times 15'$ 800 yd^3
 $\text{W} \quad \text{L} \quad \text{H}$
 $= 777.78 \text{ cubic yards}$
 2. The cost of transporting to a disposal site (The cost per yd^3 times the amount shown above.):
\$600/load (20 tons per load) \$ 3600⁰⁰
 3. The cost (tipping fee, surcharges, etc.) to dispose of this volume of waste:
\$20.12/Ton \$ 2414.40
 4. Mobilization of equipment's and Labor cost \$ 3250.00
 5. Items 2+3+4+5 = Total cost. \$ 9264.40
- Total Amount Due \$ 9264.40

Signed Bethney Anderson

To the best of my knowledge, the above
information is correct and complete.

Return to: TN Department of Environment and Conservation
Division of Solid Waste Management
ATTN: Permits Administration
William R. Snodgrass Tennessee Tower
312 Rosa L. Parks Avenue, 14th Floor, Nashville, TN 37243

$$800 \text{ cy} \times 300 \text{ lbs per cy} = 240,000$$
$$240,000 \div 2000 = 120 \text{ Tons}$$

Financial Assurance – CWM, LLC dba Cave Road Recycling

The current processing area allows for approximately 800 cubic yards of material. The area is 35 by 40 feet and can be stacked 15 feet high. Converted to tons this area would contain 120 tons (800 CY x 300lbs. per CY = 240,000 lbs., 240,000/2000 = **120 tons**)

Mobilization and Transportation

Excavation/Loading*	Outside contractor	\$3250.00
Transportation**	\$600.00 per 20-ton load	\$3600.00
Disposal***	\$20.12 per ton	\$2414.40
TOTAL		\$9264.40

- * See quote attached for rental of 2 pieces of equipment and 2 operators.
- ** Transportation provided by MPG Transport, Inc. (see invoice attached)
- *** Material disposed at Hopkins County Landfill for \$20.12 per ton (see attached invoice)



MPG Companies

MPG Transport, Inc.
1309 Tylertown Road
Clarksville TN 37040
United States
(931) 647-1500
www.mpgtransporttn.com

Bill To

Cave Road Recycling
511 Cave Road
Nashville TN 37210
United States

Ship To

Cave Road Recycling
511 Cave Road
Nashville TN 37210
United States

Invoice

Date	4/6/2022
Invoice #	INV6100562
Customer	Cave Road Recycling
Memo	
Terms	Net 10
Due Date	4/16/2022
Ship Date	4/6/2022
For Invoice Grouping	No

Item	Description	Qty	Rate	Amount	Options
MSW Hauling Fee	4/5/2022 1 load 20.42 tons	1	600.00	600.00	

Total \$600.00

000244



HOPKINS COUNTY REGIONAL LANDFILL
A Waste Connections Company
419 Claude Young Rd
White Plains, KY 42464

244
Cave Road Recycling
Cal Woodard
511 Cave Rd
Nashville, TN

20220404/5/2022 20220404/5/2022 Cave Road Recycling 244
** Duplicate Ticket **

SITE	TICKET	GRID	WEIGHMASTER		
01	353706		WHITNEYH		
DATE IN	DATE OUT	TIME IN	TIME OUT	VEHICLE	ROLL OFF
04/05/22	04/05/22	7:20	7:54	1149	
REFERENCE		ORIGIN			
		DAVIDSON COUNTY			

Scale Gross Wt.	71880	Charge Ticket
Scale Tare Wt.	31040	
Net Weight	40840	

QTY	UNIT	DESCRIPTION	RATE	EXTENSION	FEE	TOTAL
20.42	TON	C&D	20.12	410.85	0.00	410.85

Operating hours 8AM to 4PM Monday thru Friday.
This is to certify that this load does not contain any
hazardous materials, medical waste or liquids of any
type.

Location
Manifest1:
Manifest2:

SIGNATURE: James Gifford

NET AMOUNT
410.85
TENDERED
CHANGE
CHECK NO.

Funez Construction

PO Box 1435
Madison, TN 37116

Estimate

Date	Estimate #
4/7/2022	24779

Name / Address
Cave Road Recycling 511 Cave Rd Nashville, TN 37210

			Project
Description	Qty	Rate	Total
Excavator and skidsteer rental and 2 equipment operators to load 800 yards of C&D material		3,250.00	3,250.00
Estimate does not include waste hauling			
		Total	\$3,250.00

Phone #
615-589-0319

E-mail
funezconstruction@gmail.com